

OPK SERIES PUSH-IN CONNECTION RAIL TERMINAL BLOCKS

Technical Features ;

- Push-in System
- Does not require final plate (Both sides are closed), provides cost saving and better isolation
- Symmetrical (Mountable to rail on both directions)
- Lower cable thrust
- Time and cost saving
- Reducing transmission, zero contact by means of orange buttons
- Springs are stainless steel
- Opportunity to assemble cable with ferrule of 0,50 mm² to 35 mm² without any hand tool requirement
- Labelling system appropriate for strap marking
- Double sided bridging opportunity
- Isolated comb bridge

Range of Products;

- OPK Series standard terminal blocks
- OPK Series earth rail terminal blocks
- OPK Series double rail terminal blocks
- OPK Series triple rail terminal blocks
- OPK Series 1 in 2 out terminal blocks
- OPK Series 2 in 2 out terminal blocks
- OPK Series 2 in 2 out knife disconnect terminal blocks
- OPK Series fused terminal blocks
- MRK and OPK Series stoppers
- OPK Series separation plate
- OPK Series Cross connections

OPK SERIES

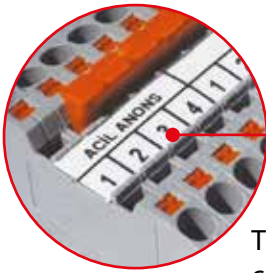

The roll labelling system can be used in all of 2,5 - 4 - 6 and 10 mm² push-in terminal blocks

It can be tested by touching the test probes from two different points over the terminal blocks without ejecting the fuse

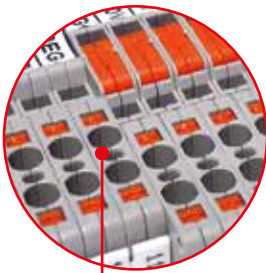
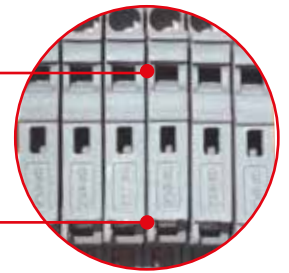

It can be easily measured within the holes

OPK fuse terminal block terminals have a nest in order to keep an extra glass fuse

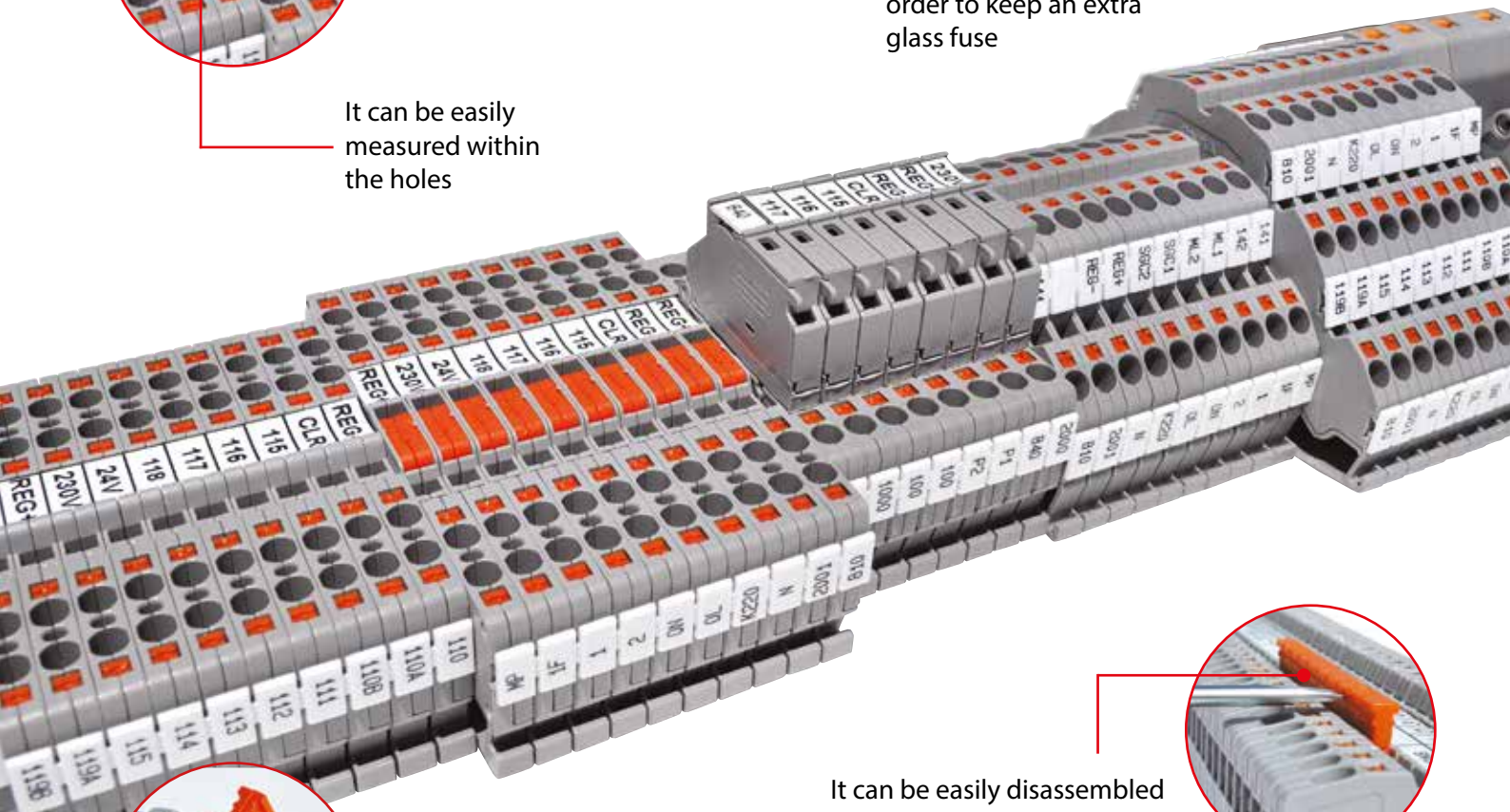
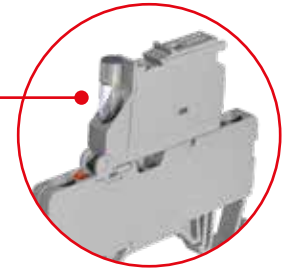

Continuous and safe contact from four points due to the diagonal structure of the pins

It can be easily disassembled with a screwdriver, by the help of the notch over the bridge



Due to the channels on the comb bridge, it gives the chance to be cut from the center of the pin gap.



This feature is valid with 10 and 20 pin bridges

OPK SERIES PUSH-IN CONNECTION TERMINAL BLOCKS

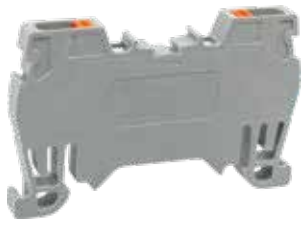

OPK 1,5
New Code: 1020002
Old Code: 1592

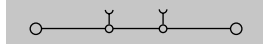

OPK 2,5
New Code: 1020013
Old Code: 1502

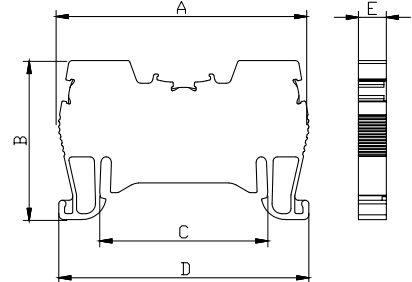
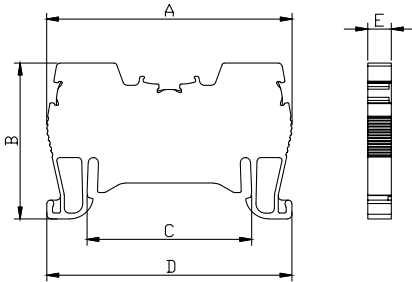
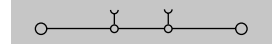

* MONOBLOCK *

* MONOBLOCK *

Dimension (mm)	A	B	C	D	E
	52,0	33,0	34,5	51,9	5,0

Dimension (mm)	A	B	C	D	E
	52,0	33,0	34,5	51,9	5,8

MATERIAL			
Body	PA6.6	Spring	Stainless Steel
Bridge	Copper	Temp.	-40 °C, +140 °C
Orange Button	PA6.6	Cable Strip L.	9 mm

MATERIAL			
Body	PA6.6	Spring	Stainless Steel
Bridge	Copper	Temp.	-40 °C, +140 °C
Orange Button	PA6.6	Cable Strip L.	9 mm

DATA	TSE / CE
Voltage	750 V
Current	17,5 A
Section	1,5 mm ²
Norm	EN-60947-7-1

DATA	TSE / CE	UL
Voltage	750 V	600 V
Current	24 A	20 A
Section	2,5 mm ²	12 AWG
Norm	EN-60947-7-1	UL 1059

COLOURS					
	V2	V2	V0	V0	
COLOUR	New Code	Old Code	New Code	Old Code	Pcs.
GREY	1020002	1592	1020074	0532	100
CREAM	1020003	1593	1020075	0533	100
BLACK	1020004	1594	1020076	0534	100
BLUE	1020005	1595	1020077	0535	100
BROWN	1020006	1596	1020078	0536	100
RED	1020007	1597	1020079	0537	100
YELLOW	1020008	1598	1020080	0538	100
GREEN	1020009	1599	1020081	0539	100

COLOURS					
	V2	V2	V0	V0	
COLOUR	New Code	Old Code	New Code	Old Code	Pcs.
GREY	1020013	1502	1020083	0922	100
CREAM	1020014	1503			100
BLACK	1020015	1504	1020084	0924	100
BLUE	1020016	1505	1020085	0925	100
BROWN	1020017	1506	1020086	0926	100
RED	1020018	1507	1020087	0927	100
YELLOW	1020019	1508			100
GREEN	1020020	1509	1020088	0929	100

ACCESSORIES					
Cross Connection	New Code	Old Code	Section	Pcs.	See Page
	1060101	1920	1,5 / 2	100	Pg. 67
	1060102	1921	1,5 / 3	100	
	1060103	1922	1,5 / 4	100	
	1060104	1923	1,5 / 10	30	
	1060105	1924	1,5 / 20	20	
Stopper	1060002	1202		100	Pg. 65-66
	1060005	1212		100	
	1060014	1222		100	
Group Sticker	1060024	1232		100	

ACCESSORIES					
Cross Connection	New Code	Old Code	Section	Pcs.	See Page
	1060106	1925	2,5 / 2	100	Pg. 67
	1060107	1926	2,5 / 3	100	
	1060108	1927	2,5 / 4	75	
	1060109	1928	2,5 / 10	30	
	1060110	1929	2,5 / 20	20	
Stopper	1060002	1202		100	Pg. 65-66
	1060005	1212		100	
	1060014	1222		100	
Group Sticker	1060024	1232		100	

MARKING			
	New Code	Old Code	See Page
Dekafix	1060198	5443	Pg. 181 - 185
	1060194	4442	
	-	9540	
	-	9770	
Roll Label	-	8943-S11	Pg. 176

MARKING			
	New Code	Old Code	See Page
Dekafix	1060192	4440	Pg. 181 - 185
	1060194	4442	
	-	9540	
	-	9770	
Roll Label	-	8943-S11	Pg. 176



OPK SERIES PUSH-IN CONNECTION TERMINAL BLOCKS



OPK 2,5 SLIM

New Code: 1020814
Old Code: 1810

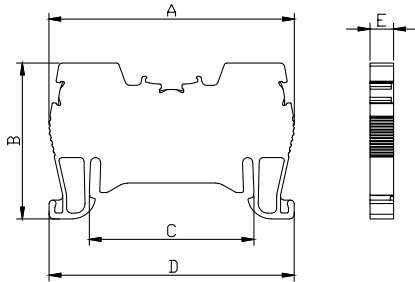

* MONOBLOCK *

Dimension (mm)	A	B	C	D	E
	52,0	33,0	34,5	51,9	5,0

MATERIAL

Body	PA6.6	Spring	Stainless Steel
Bridge	Copper	Temp.	-40 °C, +140 °C
Orange Button	PA6.6	Cable Strip L.	9 mm

DATA	TSE / CE
Voltage	750 V
Current	17,5 A
Section	2,5 mm ²
Norm	EN-60947-7-1

COLOURS

COLOUR	V2	V0	Pcs.
	New Code	New Code	
GREY	1020814	1020825	100
CREAM	1020815	1020826	100
BLACK	1020816	1020827	100
BLUE	1020817	1020828	100
BROWN	1020818	1020829	100
RED	1020819	1020830	100
YELLOW	1020820	1020831	100
GREEN	1020821	1020832	100

ACCESSORIES

Cross Connection	New Code	Old Code	Section	Pcs.	See Page
	1060101	1920	1,5 / 2	100	Pg. 67
	1060102	1921	1,5 / 3	100	
	1060103	1922	1,5 / 4	100	
	1060104	1923	1,5 / 10	30	
	1060105	1924	1,5 / 20	20	
Stopper	1060002	1202		100	Pg. 65-66
	1060005	1212		100	
	1060014	1222		100	
Group Sticker	1060024	1232		100	

MARKING

	New Code	Old Code	See Page
Dekafix	1060198	5443	Pg. 181 - 185
	1060194	4442	
	-	9540	
	-	9770	
Roll Label	-	8943-S11	Pg. 176



OPK 4

New Code: 1020024
Old Code: 1512

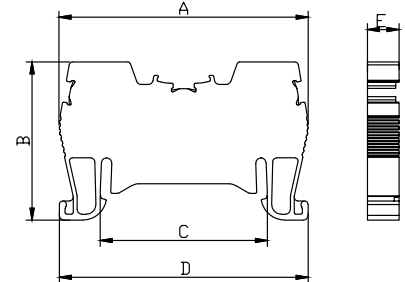

* MONOBLOCK *

Dimension (mm)	A	B	C	D	E
	52,0	33,0	34,5	51,9	6,6

MATERIAL

Body	PA6.6	Spring	Stainless Steel
Bridge	Copper	Temp.	-40 °C, +140 °C
Orange Button	PA6.6	Cable Strip L.	9 mm

DATA	TSE / CE	UL
Voltage	750 V	600 V
Current	32 A	26 A
Section	4,0 mm ²	10 AWG
Norm	EN-60947-7-1	UL 1059

COLOURS

COLOUR	V2	V2	V0	V0	Pcs.
	New Code	Old Code	New Code	Old Code	
GREY	1020024	1512	1020090	0932	100
CREAM	1020025	1513			100
BLACK	1020026	1514	1020091	0934	100
BLUE	1020027	1515	1020092	0935	100
BROWN	1020028	1516	1020093	0936	100
RED	1020029	1517	1020094	0937	100
YELLOW	1020030	1518			100
GREEN	1020031	1519	1020095	0939	100

ACCESSORIES

Cross Connection	New Code	Old Code	Section	Pcs.	See Page
	1060111	1930	4 / 2	100	Pg. 67
	1060112	1931	4 / 3	100	
	1060113	1932	4 / 4	50	
	1060114	1933	4 / 10	30	
	1060115	1934	4 / 20	20	
Stopper	1060002	1202		100	Pg. 65-66
	1060005	1212		100	
	1060014	1222		100	
Group Sticker	1060024	1232		100	

MARKING

	New Code	Old Code	See Page
Dekafix	1060190	4390	Pg. 181 - 185
	1060194	4442	
	-	9540	
	-	9770	
Roll Label	-	8943-S11	Pg. 176

OPK SERIES PUSH-IN CONNECTION TERMINAL BLOCKS



OPK 6

New Code: 1020034
Old Code: 1522

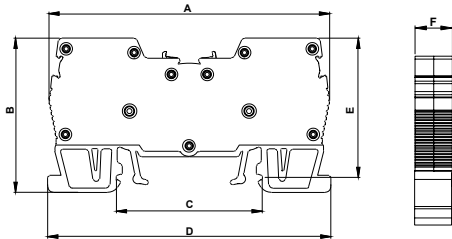
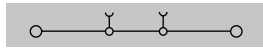

Dimension (mm)	A	B	C	D	E	F
	66,3	36,4	34,5	66,8	32,9	8,1

MATERIAL

Body	PA6.6	Spring	Stainless Steel
Bridge	Copper	Temp.	-40 °C, +140 °C
Orange Button	PA6.6	Cable Strip L.	12 mm

DATA	TSE / CE
Voltage	750 V
Current	41 A
Section	6,0 mm ²
Norm	EN-60947-7-1

COLOURS

COLOUR	V2	V2	V0	V0	Pcs.
	New Code	Old Code	New Code	Old Code	
GREY	1020034	1522	1020096	0942	100
CREAM	1020035	1523			100
BLACK	1020036	1524			100
BLUE	1020037	1525	1020550		100
BROWN	1020038	1526			100
RED	1020039	1527			100
YELLOW	1020040	1528			100
GREEN	1020041	1529	1020551		100

ACCESSORIES

Cross Connection	New Code	Old Code	Section	Pcs.	See Page
	1060126	1945	6 / 2	100	Pg. 67
	1060127	1946	6 / 3	50	
	1060128	1947	6 / 4	50	
	1060129	1948	6 / 10	15	
	1060130	1949	6 / 20	10	
Stopper	1060002	1202		100	Pg. 65-66
	1060005	1212		100	
	1060014	1222		100	
Group Sticker	1060024	1232		100	

MARKING

	New Code	Old Code	See Page
Dekafix	1060188	2630	Pg. 181 - 185
	1060194	4442	
	-	9540	
	-	9770	
Roll Label	-	8943-S11	Pg. 176



OPK 10

New Code: 1020044
Old Code: 1532

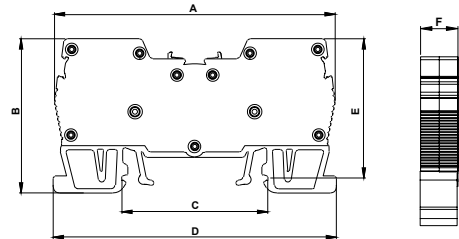

Dimension (mm)	A	B	C	D	E	F
	66,3	36,4	34,5	66,8	32,9	10

MATERIAL

Body	PA6.6	Spring	Stainless Steel
Bridge	Copper	Temp.	-40 °C, +140 °C
Orange Button	PA6.6	Cable Strip L.	12 mm

DATA	TSE / CE
Voltage	750 V
Current	57 A
Section	10 mm ²
Norm	EN-60947-7-1

COLOURS

COLOUR	V2	V2	V0	V0	Pcs.
	New Code	Old Code	New Code	Old Code	
GREY	1020044	1532	1020097	0952	100
CREAM	1020045	1533			100
BLACK	1020046	1534			100
BLUE	1020047	1535			100
BROWN	1020048	1536			100
RED	1020049	1537			100
YELLOW	1020050	1538			100
GREEN	1020051	1539			100

ACCESSORIES

Cross Connection	New Code	Old Code	Section	Pcs.	See Page
	1060131	1950	10 / 2	100	Pg. 67
	1060132	1951	10 / 3	50	
	1060133	1952	10 / 4	50	
	1060134	1953	10 / 10	15	
	1060135	1954	10 / 20	10	
Stopper	1060002	1202		100	Pg. 65-66
	1060005	1212		100	
	1060014	1222		100	
Group Sticker	1060024	1232		100	

MARKING

	New Code	Old Code	See Page
Dekafix	1060188	2630	Pg. 181 - 185
	1060194	4442	
	-	9540	
	-	9770	
Roll Label	-	8943-S11	Pg. 176



OPK SERIES PUSH-IN CONNECTION TERMINAL BLOCKS



OPK 16
New Code: 1020054
Old Code: 1542

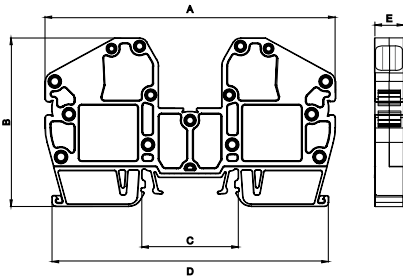

OPK 35
New Code: 1020064
Old Code: 1552

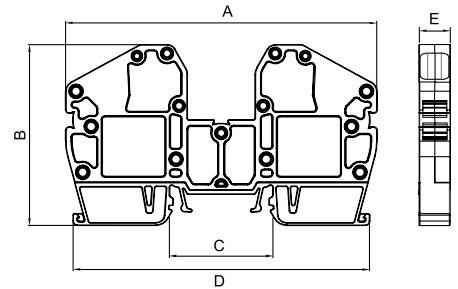

Dimension (mm)	A	B	C	D	E
	103,0	60,0	34,5	98,0	10,7

MATERIAL				
Body	PA6.6	Spring	Stainless Steel	
Bridge	Copper	Temp.	-40 °C, +140 °C	
Orange Button	PA6.6	Cable Strip L.	22 mm	

DATA	TSE / CE
Voltage	750 V
Current	76 A
Section	16 mm ²
Norm	EN-60947-7-1

COLOURS					
	V2	V2	V0	V0	
COLOUR	New Code	Old Code	New Code	Old Code	Pcs.
GREY	1020054	1542	1020098	0962	30
CREAM	1020055	1543			30
BLACK	1020056	1544			30
BLUE	1020057	1545			30
BROWN	1020058	1546			30
RED	1020059	1547			30
YELLOW	1020060	1548			30
GREEN	1020061	1549			30

ACCESSORIES					
Cross Connection	New Code	Old Code	Section	Pcs.	See Page
	1060136	1955	16 / 2	10	Pg. 67
	1060137	1956	16 / 3	10	
	1060138	1957	16 / 4	10	
	1060139	1958	16 / 10	10	
Stopper	1060002	1202		100	Pg. 65-66
	1060005	1212		100	
	1060014	1222		100	
Group Sticker	1060024	1232		100	

MARKING			
	New Code	Old Code	See Page
Dekafix	1060194	4442	Pg. 181 - 185
	-	9540	
	-	9770	
	-	9770	

Dimension (mm)	A	B	C	D	E
	103,0	60,0	34,5	98,0	15,2

MATERIAL				
Body	PA6.6	Spring	Stainless Steel	
Bridge	Copper	Temp.	-40 °C, +140 °C	
Orange Button	PA6.6	Cable Strip L.	22 mm	

DATA	TSE / CE
Voltage	750 V
Current	125 A
Section	35 mm ²
Norm	EN-60947-7-1

COLOURS					
	V2	V2	V0	V0	
COLOUR	New Code	Old Code	New Code	Old Code	Pcs.
GREY	1020064	1552	1020099	0972	20
CREAM	1020065	1553			20
BLACK	1020066	1554			20
BLUE	1020067	1555			20
BROWN	1020068	1556			20
RED	1020069	1557			20
YELLOW	1020070	1558			20
GREEN	1020071	1559			20

ACCESSORIES					
Cross Connection	New Code	Old Code	Section	Pcs.	See Page
	1060140	1959	35 / 2	10	Pg. 67
	1060141	1960	35 / 3	10	
	1060142	1961	35 / 4	10	
	1060143	1962	35 / 10	10	
Stopper	1060002	1202		100	Pg. 65-66
	1060005	1212		100	
	1060014	1222		100	
Group Sticker	1060024	1232		100	

MARKING			
	New Code	Old Code	See Page
Dekafix	1060194	4442	Pg. 181 - 185
	-	9540	
	-	9770	
	-	9770	

OPK SERIES PUSH-IN CONNECTION DOUBLE RAIL TERMINAL BLOCKS

**OPK - C2,5**

New Code: 1020379

Old Code: 1722

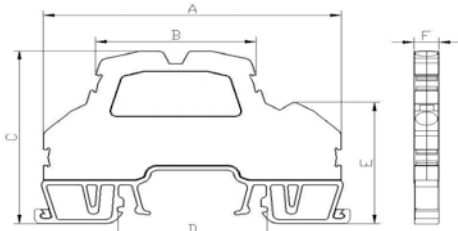
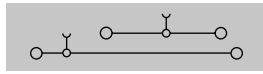

Dimensions (mm)	A	B	C	D	E	F
	69,0	37,0	50,0	34,5	35,5	5,9

MATERIAL

Body	PA6.6	Spring	Stainless Steel
Bridge	Copper	Temp.	-40 °C, +140 °C
Orange Button	PA6.6	Cable Strip L.	9 mm

DATA	TSE / CE	UL
Voltage	750 V	300 V
Current	24 A	16 A
Section	2,5 mm ²	12 AWG
Norm	EN-60947-7-1	UL 1059

COLOURS

COLOUR	New Code	Old Code	Pcs.
GREY	1020379	1722	50
CREAM	1020380	1723	50
BLACK	1020381	1724	50
BLUE	1020382	1725	50
BROWN	1020383	1726	50
RED	1020384	1727	50
YELLOW	1020385	1728	50
GREEN	1020386	1729	50

ACCESSORIES

Cross Connection	New Code	Old Code	Section	Pcs.	See Page
	1060106	1925	2,5 / 2	100	Pg. 67
	1060107	1926	2,5 / 3	100	
	1060108	1927	2,5 / 4	75	
	1060109	1928	2,5 / 10	30	
	1060110	1929	2,5 / 20	20	
Stopper	1060002	1202		100	Pg. 65-66
	1060005	1212		100	
	1060014	1222		100	
Group Sticker	1060024	1232		100	
Bridged	1020388	1732			
Diode	1020397	1742			

MARKING

	New Code	Old Code	See Page
Dekafix	1060192	4440	Pg. 181 - 185
	1060194	4442	
	-	9540	
	-	9770	
Roll Label	-	8943-S11	Pg. 176

**OPK - C4**

New Code: 1020406

Old Code: 1752

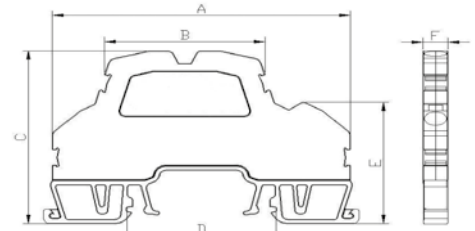
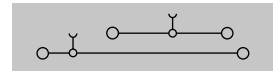

Dimensions (mm)	A	B	C	D	E	F
	69,0	37,0	50,0	34,5	35,5	6,7

MATERIAL

Body	PA6.6	Spring	Stainless Steel
Bridge	Copper	Temp.	-40 °C, +140 °C
Orange Button	PA6.6	Cable Strip L.	9 mm

DATA	TSE / CE	UL
Voltage	750 V	300 V
Current	32 A	22 A
Section	4,0 mm ²	10 AWG
Norm	EN-60947-7-1	UL 1059

COLOURS

COLOUR	New Code	Old Code	Pcs.
GREY	1020406	1752	50
CREAM	1020407	1753	50
BLACK	1020408	1754	50
BLUE	1020409	1755	50
BROWN	1020410	1756	50
RED	1020411	1757	50
YELLOW	1020412	1758	50
GREEN	1020413	1759	50

ACCESSORIES

Cross Connection	New Code	Old Code	Section	Pcs.	See Page
	1060111	1930	4 / 2	100	Pg. 67
	1060112	1931	4 / 3	100	
	1060113	1932	4 / 4	50	
	1060114	1933	4 / 10	30	
	1060115	1934	4 / 20	20	
Stopper	1060002	1202		100	Pg. 65-66
	1060005	1212		100	
	1060014	1222		100	
Group Sticker	1060024	1232		100	
Bridged	1020415	1762			
Diode	1020424	1772			

MARKING

	New Code	Old Code	See Page
Dekafix	1060190	4390	Pg. 181 - 185
	1060194	4442	
	-	9540	
	-	9770	
Roll Label	-	8943-S11	Pg. 176



OPK SERIES PUSH-IN CONNECTION DOUBLE RAIL TERMINAL BLOCKS



OPK - C2,5

New Code: 1020101

Old Code: 1782

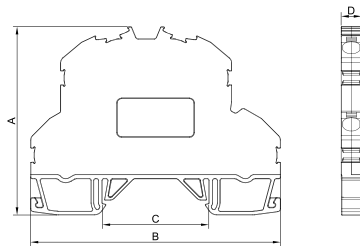
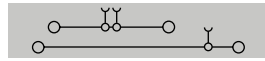

OPK - C4

New Code: 1020128

Old Code: 1792

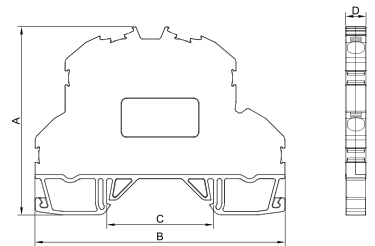
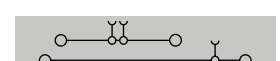

Dimensions (mm)	A	B	C	D
	61,0	81,0	34,5	5,9

MATERIAL			
Body	PA6.6	Spring	Stainless Steel
Bridge	Copper	Temp.	-40 °C, +140 °C
Orange Button	PA6.6	Cable Strip L.	9 mm

DATA	TSE / CE	UL
Voltage	750 V	300 V
Current	24 A	16 A
Section	2,5 mm ²	12 AWG
Norm	EN-60947-7-1	UL 1059

COLOURS			
COLOUR	New Code	Old Code	Pcs.
GREY	1020101	1782	50
CREAM	1020102	1783	50
BLACK	1020103	1784	50
BLUE	1020104	1785	50
BROWN	1020105	1786	50
RED	1020106	1787	50
YELLOW	1020107	1788	50
GREEN	1020108	1789	50

ACCESSORIES					
Cross Connection	New Code	Old Code	Section	Pcs.	See Page
	1060106	1925	2,5 / 2	100	Pg. 67
	1060107	1926	2,5 / 3	100	
	1060108	1927	2,5 / 4	75	
	1060109	1928	2,5 / 10	30	
	1060110	1929	2,5 / 20	20	
Stopper	1060002	1202		100	Pg. 65-66
	1060005	1212		100	
	1060014	1222		100	
Group Sticker	1060024	1232		100	
Bridged	1020110	2572			
Diode	1020119	2582			

MARKING			
	New Code	Old Code	See Page
Dekafix	1060192	4440	Pg. 181 - 185
	1060194	4442	
	-	9540	
	-	9770	
Roll Label	-	8943-S11	Pg. 176

Dimensions (mm)	A	B	C	D
	61,0	81,0	34,5	6,7

MATERIAL			
Body	PA6.6	Spring	Stainless Steel
Bridge	Copper	Temp.	-40 °C, +140 °C
Orange Button	PA6.6	Cable Strip L.	9 mm

DATA	TSE / CE	UL
Voltage	750 V	300 V
Current	32 A	22 A
Section	4,0 mm ²	10 AWG
Norm	EN-60947-7-1	UL 1059

COLOURS			
COLOUR	New Code	Old Code	Pcs.
GREY	1020128	1792	50
CREAM	1020129	1793	50
BLACK	1020130	1794	50
BLUE	1020131	1795	50
BROWN	1020132	1796	50
RED	1020133	1797	50
YELLOW	1020134	1798	50
GREEN	1020135	1799	50

ACCESSORIES					
Cross Connection	New Code	Old Code	Section	Pcs.	See Page
	1060111	1930	4 / 2	100	Pg. 67
	1060112	1931	4 / 3	100	
	1060113	1932	4 / 4	50	
	1060114	1933	4 / 10	30	
	1060115	1934	4 / 20	20	
Stopper	1060002	1202		100	Pg. 65-66
	1060005	1212		100	
	1060014	1222		100	
Group Sticker	1060024	1232		100	
Bridged	1020137	2592			
Diode	1020146	2602			

MARKING			
	New Code	Old Code	See Page
Dekafix	1060190	4390	Pg. 181 - 185
	1060194	4442	
	-	9540	
	-	9770	
Roll Label	-	8943-S11	Pg. 176

OPK SERIES PUSH-IN CONNECTION DOUBLE RAIL TERMINAL BLOCKS

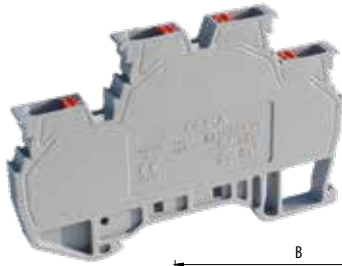

OPK - C2,5
Code: 1020441

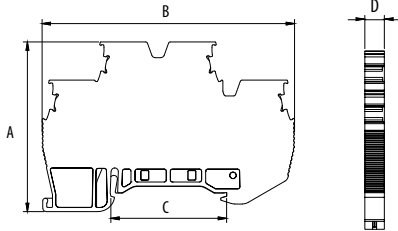
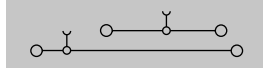

* MONOBLOCK *

Dimension (mm)	A	B	C	D
	50,5	75,15	34,5	5,8

MATERIAL

Body	PA6.6	Spring	Stainless Steel
Bridge	Copper	Temp.	-40 °C, +140 °C
Orange Button	PA6.6	Cable Strip L.	9 mm

DATA	TSE / CE	UL
Voltage	750 V	600 V
Current	24 A	24 A
Section	2,5 mm ²	12 AWG
Norm	EN-60947-7-1	UL 1059

COLOURS

COLOUR	V2 Code	V0 Code	Pcs.
GREY	1020441	1020468	50
CREAM	1020442	1020469	50
BLACK	1020443	1020470	50
BLUE	1020444	1020471	50
BROWN	1020445	1020472	50
RED	1020446	1020473	50
YELLOW	1020447	1020474	50
GREEN	1020448	1020475	50

ACCESSORIES

Cross Connection	New Code	Old Code	Section	Pcs.	See Page
	1060106	1925	2,5 / 2	100	Pg. 67
	1060107	1926	2,5 / 3	100	
	1060108	1927	2,5 / 4	75	
	1060109	1928	2,5 / 10	30	
	1060110	1929	2,5 / 20	20	
	1060002	1202		100	
Stopper	1060005	1212		100	Pg. 65-66
	1060014	1222		100	
	1060024	1232		100	
Group Sticker	1060024	1232		100	
Bridged	1020450				
Diode	1020459				

MARKING

	New Code	Old Code	See Page
Dekafix	1060192	4440	Pg. 181 - 185
	1060194	4442	
	-	9540	
	-	9770	
Roll Label	-	8943-S11	Pg. 176



OPK - C4
Code: 1020495

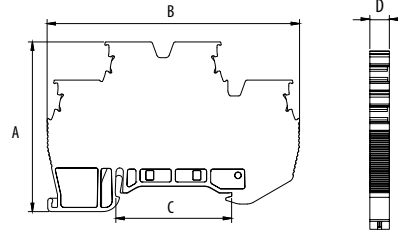
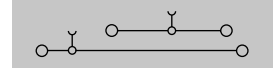

* MONOBLOCK *

Dimension (mm)	A	B	C	D
	50,5	75,15	34,5	6,6

MATERIAL

Body	PA6.6	Spring	Stainless Steel
Bridge	Copper	Temp.	-40 °C, +140 °C
Orange Button	PA6.6	Cable Strip L.	9 mm

DATA	TSE / CE	UL
Voltage	750 V	300 V
Current	32 A	22 A
Section	4 mm ²	10 AWG
Norm	EN-60947-7-1	UL 1059

COLOURS

COLOUR	V2 Code	V0 Code	Pcs.
GREY	1020495	1020522	50
CREAM	1020496	1020523	50
BLACK	1020497	1020524	50
BLUE	1020498	1020525	50
BROWN	1020499	1020526	50
RED	1020500	1020527	50
YELLOW	1020501	1020528	50
GREEN	1020502	1020529	50

ACCESSORIES

Cross Connection	New Code	Old Code	Section	Pcs.	See Page
	1060111	1930	4 / 2	100	Pg. 67
	1060112	1931	4 / 3	100	
	1060113	1932	4 / 4	50	
	1060114	1933	4 / 10	30	
	1060115	1934	4 / 20	20	
	1060002	1202		100	
Stopper	1060005	1212		100	Pg. 65-66
	1060014	1222		100	
	1060024	1232		100	
Group Sticker	1060024	1232		100	
Bridged	1020504				
Diode	1020513				

MARKING

	New Code	Old Code	See Page
Dekafix	1060190	4390	Pg. 181 - 185
	1060194	4442	
	1060432	-	
	-	9540	
Roll Label	-	8943-S11	Pg. 176

OPK SERIES PUSH-IN CONNECTION DOUBLE RAIL TERMINAL BLOCKS

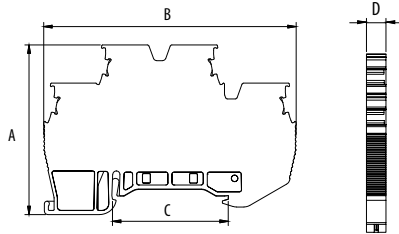
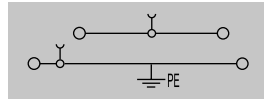
OPK - C 2,5
 Code: 1020432
 EARTH

* MONOBLOCK *

Dimension (mm)	A	B	C	D
	50,5	75,15	34,5	5,8

MATERIAL			
Body	PA6.6	Spring	Stainless Steel
Bridge	Copper	Temp.	-40 °C, +140 °C
Orange Button	PA6.6	Cable Strip L.	9 mm
The Foot Which Contact to the Rail	Brass		

DATA	TSE / CE	UL
Voltage	750 V	300 V
Current	24 A	16 A
Section	2,5 mm ²	12 AWG
Norm	EN-60947-7-1	UL 1059

COLOURS			
COLOUR	V2 Code	V0 Code	Pcs.
GREY	1020432	1020434	50

ACCESSORIES					
Cross Connection	New Code	Old Code	Section	Pcs.	See Page
	1060106	1925	2,5 / 2	100	Pg. 67
	1060107	1926	2,5 / 3	100	
	1060108	1927	2,5 / 4	75	
	1060109	1928	2,5 / 10	30	
	1060110	1929	2,5 / 20	20	
Stopper	1060002	1202		100	Pg. 65-66
	1060005	1212		100	
	1060014	1222		100	
Group Sticker	1060024	1232		100	

MARKING			
	New Code	Old Code	See Page
Dekafix	1060192	4440	Pg. 181 - 185
	1060194	4442	
	-	9540	
	-	9770	
Roll Label	-	8943-S11	Pg. 176

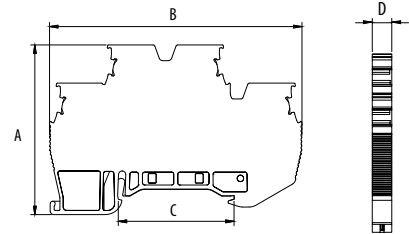
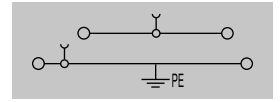
OPK - C 4
 Code: 1020436
 EARTH

* MONOBLOCK *

Dimension (mm)	A	B	C	D
	50,5	75,15	34,5	6,6

MATERIAL			
Body	PA6.6	Spring	Stainless Steel
Bridge	Copper	Temp.	-40 °C, +140 °C
Orange Button	PA6.6	Cable Strip L.	9 mm
The Foot Which Contact to the Rail	Brass		

DATA	TSE / CE	UL
Voltage	750 V	300 V
Current	32 A	22 A
Section	4 mm ²	12 AWG
Norm	EN-60947-7-1	UL 1059

COLOURS			
COLOUR	V2 Code	V0 Code	Pcs.
GREY	1020436	1020438	50

ACCESSORIES					
Cross Connection	New Code	Old Code	Section	Pcs.	See Page
	1060111	1930	4 / 2	100	Pg. 67
	1060112	1931	4 / 3	100	
	1060113	1932	4 / 4	50	
	1060114	1933	4 / 10	30	
	1060115	1934	4 / 20	20	
Stopper	1060002	1202		100	Pg. 65-66
	1060005	1212		100	
	1060014	1222		100	
Group Sticker	1060024	1232		100	

MARKING			
	New Code	Old Code	See Page
Dekafix	1060190	4390	Pg. 181 - 185
	1060194	4442	
	1060432	-	
	-	9540	
Roll Label	-	8943-S11	Pg. 176

OPK SERIES PUSH-IN CONNECTION DOUBLE RAIL TERMINAL BLOCKS

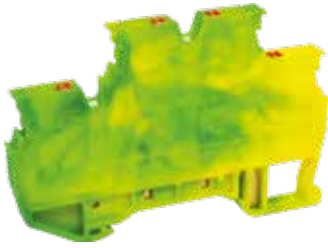
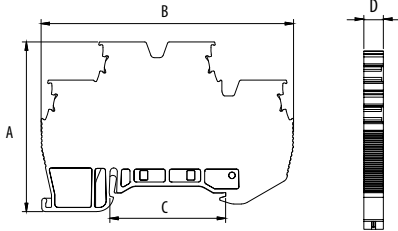
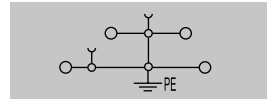
**OPK - C2,5**Code: 1020433
BRIDGED + EARTH

* MONOBLOCK *

Dimension (mm)	A	B	C	D
	50,5	75,15	34,5	5,8

MATERIAL

Body	PA6.6	Spring	Stainless Steel
Bridge	Copper	Temp.	-40 °C, +140 °C
Orange Button	PA6.6	Cable Strip L.	9 mm
The Foot Which Contact to the Rail	Brass		

DATA	TSE / CE	UL
Voltage	750 V	300 V
Current	24 A	16 A
Section	2,5 mm ²	12 AWG
Norm	EN-60947-7-1	UL 1059

COLOURS

COLOUR	V2 Code	V0 Code	Pcs.
CAMOUFLAGE	1020433	1020435	50

ACCESSORIES

Cross Connection	New Code	Old Code	Section	Pcs.	See Page
	1060106	1925	2,5 / 2	100	Pg. 67
	1060107	1926	2,5 / 3	100	
	1060108	1927	2,5 / 4	75	
	1060109	1928	2,5 / 10	30	
	1060110	1929	2,5 / 20	20	
Stopper	1060002	1202		100	Pg. 65-66
	1060005	1212		100	
	1060014	1222		100	
Group Sticker	1060024	1232		100	

MARKING

	New Code	Old Code	See Page
Dekafix	1060192	4440	Pg. 181 - 185
	1060194	4442	
	-	9540	
	-	9770	
Roll Label	-	8943-S11	Pg. 176

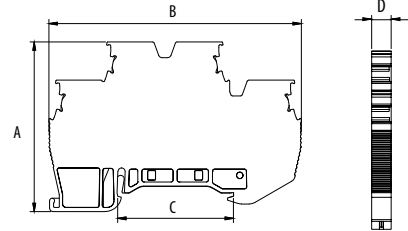
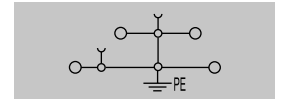
**OPK - C4**Code: 1020437
BRIDGED + EARTH

* MONOBLOCK *

Dimension (mm)	A	B	C	D
	50,5	75,15	34,5	6,6

MATERIAL

Body	PA6.6	Spring	Stainless Steel
Bridge	Copper	Temp.	-40 °C, +140 °C
Orange Button	PA6.6	Cable Strip L.	9 mm
The Foot Which Contact to the Rail	Brass		

DATA	TSE / CE	UL
Voltage	750 V	300 V
Current	32 A	22 A
Section	4 mm ²	12 AWG
Norm	EN-60947-7-1	UL 1059

COLOURS

COLOUR	V2 Code	V0 Code	Pcs.
CAMOUFLAGE	1020437	1020439	50

ACCESSORIES

Cross Connection	New Code	Old Code	Section	Pcs.	See Page
	1060111	1930	4 / 2	100	Pg. 67
	1060112	1931	4 / 3	100	
	1060113	1932	4 / 4	50	
	1060114	1933	4 / 10	30	
	1060115	1934	4 / 20	20	
Stopper	1060002	1202		100	Pg. 65-66
	1060005	1212		100	
	1060014	1222		100	
Group Sticker	1060024	1232		100	

MARKING

	New Code	Old Code	See Page
Dekafix	1060190	4390	Pg. 181 - 185
	1060194	4442	
	1060432	-	
	-	9540	
Roll Label	-	8943-S11	Pg. 176



OPK SERIES PUSH-IN CONNECTION TRIPLE RAIL TERMINAL BLOCKS



OPK-3K 2,5

Code: 1020155

Old Code: 1852

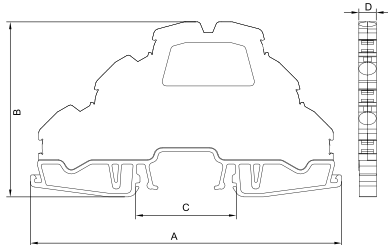
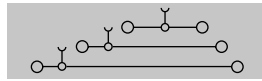

OPK-3K 4

Code: 1020183

Old Code: 1882

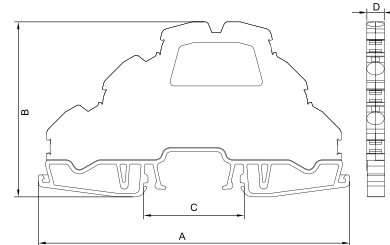
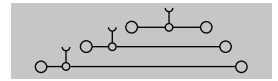

Dimension (mm)	A	B	C	D
	106,0	60,0	34,5	5,9

MATERIAL			
Body	PA6.6	Spring	Stainless Steel
Bridge	Copper	Temp.	-40 °C, +140 °C
Orange Button	PA6.6	Cable Strip L.	9 mm

DATA	TSE / CE
Voltage	750 V
Current	24 A
Section	2,5 mm ²
Norm	EN-60947-7-1

COLOURS					
	V2	V2	V0	V0	
COLOUR	New Code	Old Code	New Code	Old Code	Pcs.
GREY	1020155	1852	1020216	0682	50
CREAM	1020156	1853			50
BLACK	1020157	1854			50
BLUE	1020158	1855			50
BROWN	1020159	1856			50
RED	1020160	1857			50
YELLOW	1020161	1858			50
GREEN	1020162	1859			50

ACCESSORIES					
Cross Connection	New Code	Old Code	Section	Pcs.	See Page
	1060106	1925	2,5 / 2	100	Pg. 67
	1060107	1926	2,5 / 3	100	
	1060108	1927	2,5 / 4	75	
	1060109	1928	2,5 / 10	30	
	1060110	1929	2,5 / 20	20	
Stopper	1060002	1202		100	Pg. 65-66
	1060005	1212		100	
	1060014	1222		100	
Group Sticker	1060024	1232		100	
Bridged	1020164	1862			

MARKING			
	New Code	Old Code	See Page
Dekafix	1060192	4440	Pg. 181 - 185
	1060194	4442	
	-	9540	
	-	9770	
Roll Label	-	8943-S11	Pg. 176

Dimension (mm)	A	B	C	D
	106,0	60,0	34,5	6,7

MATERIAL			
Body	PA6.6	Spring	Stainless Steel
Bridge	Copper	Temp.	-40 °C, +140 °C
Orange Button	PA6.6	Cable Strip L.	9 mm

DATA	TSE / CE
Voltage	750 V
Current	32A
Section	4 mm ²
Norm	EN-60947-7-1

COLOURS					
	V2	V2	V0	V0	
COLOUR	New Code	Old Code	New Code	Old Code	Pcs.
GREY	1020183	1882	1020217	0683	50
CREAM	1020184	1883			50
BLACK	1020185	1884			50
BLUE	1020186	1885			50
BROWN	1020187	1886			50
RED	1020188	1887			50
YELLOW	1020189	1888			50
GREEN	1020190	1889			50

ACCESSORIES					
Cross Connection	New Code	Old Code	Section	Pcs.	See Page
	1060111	1930	4 / 2	100	Pg. 67
	1060112	1931	4 / 3	100	
	1060113	1932	4 / 4	50	
	1060114	1933	4 / 10	30	
	1060115	1934	4 / 20	20	
Stopper	1060002	1202		100	Pg. 65-66
	1060005	1212		100	
	1060014	1222		100	
Group Sticker	1060024	1232		100	
Bridged	1020192	1892			

MARKING			
	New Code	Old Code	See Page
Dekafix	1060190	4390	Pg. 181 - 185
	1060194	4442	
	1060432	-	
	-	9540	
Roll Label	-	8943-S11	Pg. 176

OPK SERIES PUSH-IN CONNECTION TRIPLE RAIL TERMINAL BLOCKS



OPK-3K 2,5
Code: 1020174
Old Code: 1872
EARTH

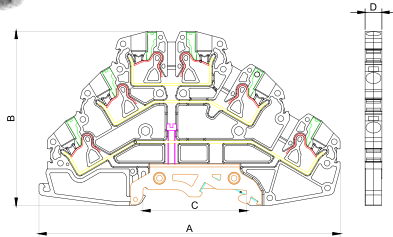
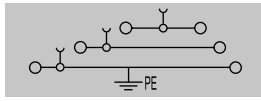

OPK-3K 4
Code: 1020201
Old Code: 1902
EARTH

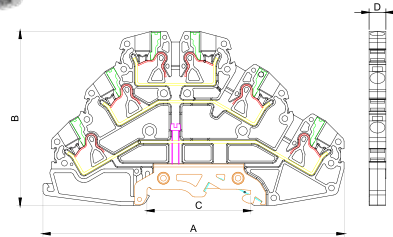
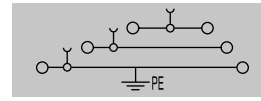

Dimension (mm)	A	B	C	D
	106,0	60,0	34,5	5,9

MATERIAL			
Body	PA6.6	Spring	Stainless Steel
Bridge	Copper	Temp.	-40 °C, +140 °C
Orange Button	PA6.6	Cable Strip L.	9 mm
The Foot Which Contact to the Rail	Brass		

DATA	TSE / CE
Voltage	750 V
Current	24 A
Section	2,5 mm ²
Norm	EN-60947-7-2

COLOURS					
	V2	V2	V0	V0	
COLOUR	New Code	Old Code	New Code	Old Code	Pcs.
GREY	1020174	1872	1020219	0672	50
CREAM	1020175	1873			50
BLACK	1020176	1874			50
BLUE	1020177	1875			50
BROWN	1020178	1876			50
RED	1020179	1877			50
YELLOW	1020180	1878			50
GREEN	1020181	1879			50

ACCESSORIES					
	New Code	Old Code	Section	Pcs.	See Page
	1060106	1925	2,5 / 2	100	Pg. 67
	1060107	1926	2,5 / 3	100	
	1060108	1927	2,5 / 4	75	
	1060109	1928	2,5 / 10	30	
	1060110	1929	2,5 / 20	20	
	1060002	1202		100	Pg. 65-66
	1060005	1212		100	
	1060014	1222		100	
	1060024	1232		100	

MARKING			
	New Code	Old Code	See Page
	1060192	4440	Pg. 181 - 185
	1060194	4442	
	-	9540	
	-	9770	
	-	8943-S11	Pg. 176

Dimension (mm)	A	B	C	D
	106,0	60,0	34,5	6,7

MATERIAL			
Body	PA6.6	Spring	Stainless Steel
Bridge	Copper	Temp.	-40 °C, +140 °C
Orange Button	PA6.6	Cable Strip L.	9 mm
The Foot Which Contact to the Rail	Brass		

DATA	TSE / CE
Voltage	750 V
Current	32A
Section	4 mm ²
Norm	EN-60947-7-2

COLOURS					
	V2	V2	V0	V0	
COLOUR	New Code	Old Code	New Code	Old Code	Pcs.
GREY	1020201	1902	1020220	0412	50
CREAM	1020202	1903			50
BLACK	1020203	1904			50
BLUE	1020204	1905			50
BROWN	1020205	1906			50
RED	1020206	1907			50
YELLOW	1020207	1908			50
GREEN	1020208	1909			50

ACCESSORIES					
	New Code	Old Code	Section	Pcs.	See Page
	1060111	1930	4 / 2	100	Pg. 67
	1060112	1931	4 / 3	100	
	1060113	1932	4 / 4	50	
	1060114	1933	4 / 10	30	
	1060115	1934	4 / 20	20	
	1060002	1202		100	Pg. 65-66
	1060005	1212		100	
	1060014	1222		100	
	1060024	1232		100	

MARKING			
	New Code	Old Code	See Page
	1060190	4390	Pg. 181 - 185
	1060194	4442	
	1060432	-	
	-	9540	
	-	8943-S11	Pg. 176

OPK SERIES PUSH-IN CONNECTION TRIPLE RAIL TERMINAL BLOCKS

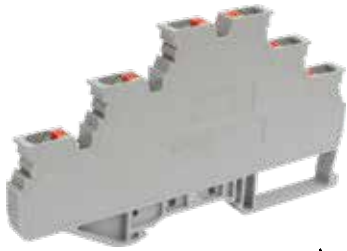

OPK-3K 2,5
Code: 1020565

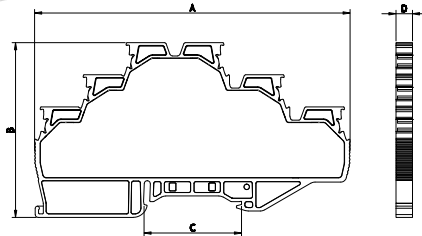
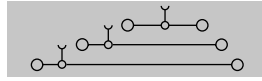

* MONOBLOCK *



OPK-3K 4
Code: 1020574

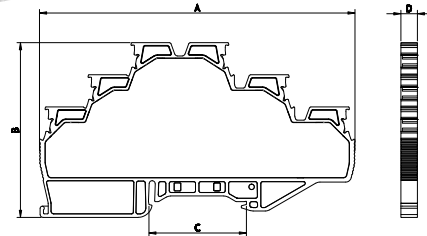
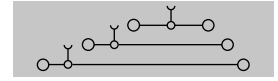

* MONOBLOCK *

!
Please, contact our sales representatives for different function options

Dimension (mm)	A	B	C	D
	111,7	61,9	34,5	5,85

MATERIAL

Body	PA6.6	Spring	Stainless Steel
Bridge	Copper	Temp.	-40 °C, +140 °C
Orange Button	PA6.6	Cable Strip L.	9 mm

DATA	TSE / CE
Voltage	750 V
Current	24 A
Section	2,5 mm ²
Norm	EN-60947-7-1

COLOURS

COLOUR	V2		V0		Pcs.
	Code		Code		
GREY	1020565		1020683		50
CREAM	1020566		1020684		50
BLACK	1020567		1020685		50
BLUE	1020568		1020686		50
BROWN	1020569		1020687		50
RED	1020570		1020688		50
YELLOW	1020571		1020689		50
GREEN	1020572		1020690		50

ACCESSORIES

Cross Connection	New Code	Old Code	Section	Pcs.	See Page
	1060106	1925	2,5 / 2	100	Pg. 67
	1060107	1926	2,5 / 3	100	
	1060108	1927	2,5 / 4	75	
	1060109	1928	2,5 / 10	30	
	1060110	1929	2,5 / 20	20	
Stopper	1060002	1202		100	Pg. 65-66
	1060005	1212		100	
	1060014	1222		100	
Group Sticker	1060024	1232		100	
Bridged	1020583				

MARKING

	New Code	Old Code	See Page
Dekafix	1060192	4440	Pg. 181 - 185
	1060194	4442	
	-	9540	
	-	9770	
Roll Label	-	8943-S11	Pg. 176

Dimension (mm)	A	B	C	D
	111,7	61,9	34,5	6,65

MATERIAL

Body	PA6.6	Spring	Stainless Steel
Bridge	Copper	Temp.	-40 °C, +140 °C
Orange Button	PA6.6	Cable Strip L.	9 mm

DATA	TSE / CE
Voltage	750 V
Current	32A
Section	4 mm ²
Norm	EN-60947-7-1

COLOURS

COLOUR	V2		V0		Pcs.
	Code		Code		
GREY	1020574		1020742		50
CREAM	1020575		1020743		50
BLACK	1020576		1020744		50
BLUE	1020577		1020745		50
BROWN	1020578		1020746		50
RED	1020579		1020747		50
YELLOW	1020580		1020748		50
GREEN	1020581		1020749		50

ACCESSORIES

Cross Connection	New Code	Old Code	Section	Pcs.	See Page
	1060111	1930	4 / 2	100	Pg. 67
	1060112	1931	4 / 3	100	
	1060113	1932	4 / 4	50	
	1060114	1933	4 / 10	30	
	1060115	1934	4 / 20	20	
Stopper	1060002	1202		100	Pg. 65-66
	1060005	1212		100	
	1060014	1222		100	
Group Sticker	1060024	1232		100	
Bridged	1020633				

MARKING

	New Code	Old Code	See Page
Dekafix	1060190	4390	Pg. 181 - 185
	1060194	4442	
	1060432	-	
	-	9540	
Roll Label	-	8943-S11	Pg. 176

OPK SERIES PUSH-IN CONNECTION TRIPLE RAIL TERMINAL BLOCKS

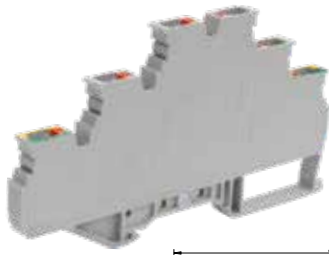
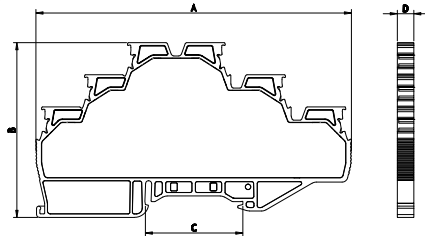
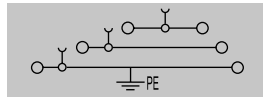
**OPK-3K 2,5**Code: 1020627
EARTH

* MONOBLOCK *

Dimension (mm)	A	B	C	D
	111,7	61,9	34,5	5,85

MATERIAL			
Body	PA6.6	Spring	Stainless Steel
Bridge	Copper	Temp.	-40 °C, +140 °C
Orange Button	PA6.6	Cable Strip L.	9 mm
The Foot Which Contact to the Rail	Brass		

DATA	TSE / CE
Voltage	750 V
Current	24 A
Section	2,5 mm ²
Norm	EN-60947-7-2

COLOURS			
COLOUR	V2 Code	V0 Code	Pcs.
GREY	1020627	1020736	50

ACCESSORIES					
Cross Connection	New Code	Old Code	Section	Pcs.	See Page
	1060106	1925	2,5 / 2	100	Pg. 67
	1060107	1926	2,5 / 3	100	
	1060108	1927	2,5 / 4	75	
	1060109	1928	2,5 / 10	30	
	1060110	1929	2,5 / 20	20	
Stopper	1060002	1202		100	Pg. 65-66
	1060005	1212		100	
	1060014	1222		100	
Group Sticker	1060024	1232		100	

MARKING			
	New Code	Old Code	See Page
Dekafix	1060192	4440	Pg. 181 - 185
	1060194	4442	
	-	9540	
	-	9770	
Roll Label	-	8943-S11	Pg. 176

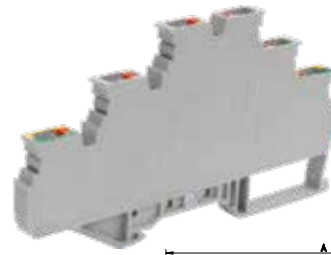
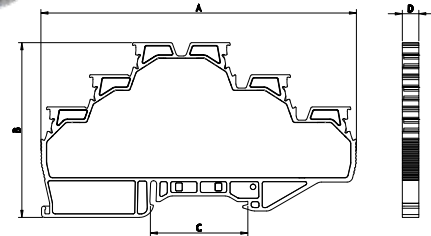
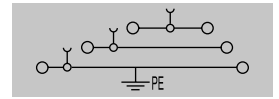
**OPK-3K 4**Code: 1020677
EARTH

* MONOBLOCK *

Dimension (mm)	A	B	C	D
	111,7	61,9	34,5	6,65

MATERIAL			
Body	PA6.6	Spring	Stainless Steel
Bridge	Copper	Temp.	-40 °C, +140 °C
Orange Button	PA6.6	Cable Strip L.	9 mm
The Foot Which Contact to the Rail	Brass		

DATA	TSE / CE
Voltage	750 V
Current	32A
Section	4 mm ²
Norm	EN-60947-7-2

COLOURS			
COLOUR	V2 Code	V0 Code	Pcs.
GREY	1020677	1020795	50

ACCESSORIES					
Cross Connection	New Code	Old Code	Section	Pcs.	See Page
	1060111	1930	4 / 2	100	Pg. 67
	1060112	1931	4 / 3	100	
	1060113	1932	4 / 4	50	
	1060114	1933	4 / 10	30	
	1060115	1934	4 / 20	20	
Stopper	1060002	1202		100	Pg. 65-66
	1060005	1212		100	
	1060014	1222		100	
Group Sticker	1060024	1232		100	

MARKING			
	New Code	Old Code	See Page
Dekafix	1060190	4390	Pg. 181 - 185
	1060194	4442	
	1060432	-	
	-	9540	
Roll Label	-	8943-S11	Pg. 176

OPK SERIES PUSH-IN CONNECTION TRIPLE RAIL TERMINAL BLOCKS

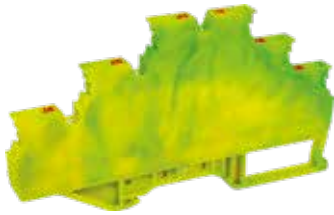

OPK-3K 2,5 EARTH

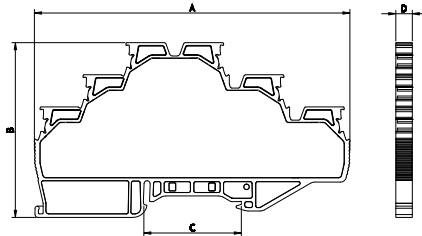
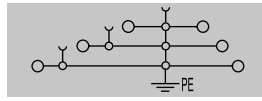
Code: 1020628
BRIDGED + EARTH

* MONOBLOCK *

Dimension (mm)	A	B	C	D
	111,7	61,9	34,5	5,85

MATERIAL

Body	PA6.6	Spring	Stainless Steel
Bridge	Copper	Temp.	-40 °C, +140 °C
Orange Button	PA6.6	Cable Strip L.	9 mm
The Foot Which Contact to the Rail	Brass		

DATA	TSE / CE
Voltage	750 V
Current	24 A
Section	2,5 mm ²
Norm	EN-60947-7-2

COLOURS

COLOUR	V2	V0	Pcs.
	Code	Code	
CAMOUFLAGE	1020628	1020737	50

ACCESSORIES

Cross Connection	New Code	Old Code	Section	Pcs.	See Page
	1060106	1925	2,5 / 2	100	Pg. 67
	1060107	1926	2,5 / 3	100	
	1060108	1927	2,5 / 4	75	
	1060109	1928	2,5 / 10	30	
	1060110	1929	2,5 / 20	20	
Stopper	1060002	1202		100	Pg. 65-66
	1060005	1212		100	
	1060014	1222		100	
Group Sticker	1060024	1232		100	

MARKING

	New Code	Old Code	See Page
	Dekafix	1060192	4440
1060194		4442	
-		9540	
-		9770	
Roll Label	-	8943-S11	Pg. 176

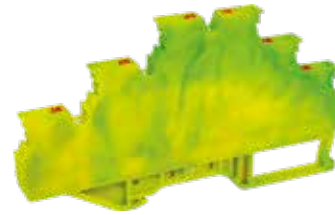

OPK-3K 4 EARTH

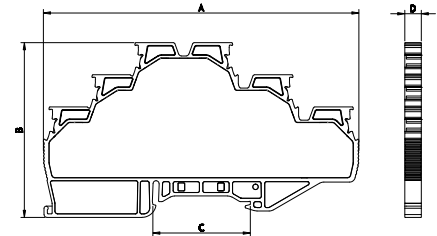
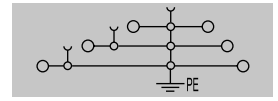
Code: 1020678
BRIDGED + EARTH

* MONOBLOCK *

Dimension (mm)	A	B	C	D
	111,7	61,9	34,5	6,65

MATERIAL

Body	PA6.6	Spring	Stainless Steel
Bridge	Copper	Temp.	-40 °C, +140 °C
Orange Button	PA6.6	Cable Strip L.	9 mm
The Foot Which Contact to the Rail	Brass		

DATA	TSE / CE
Voltage	750 V
Current	32A
Section	4 mm ²
Norm	EN-60947-7-2

COLOURS

COLOUR	V2	V0	Pcs.
	Code	Code	
CAMOUFLAGE	1020678	1020796	50

ACCESSORIES

Cross Connection	New Code	Old Code	Section	Pcs.	See Page
	1060111	1930	4 / 2	100	Pg. 67
	1060112	1931	4 / 3	100	
	1060113	1932	4 / 4	50	
	1060114	1933	4 / 10	30	
	1060115	1934	4 / 20	20	
Stopper	1060002	1202		100	Pg. 65-66
	1060005	1212		100	
	1060014	1222		100	
Group Sticker	1060024	1232		100	

MARKING

	New Code	Old Code	See Page
	Dekafix	1060190	4390
1060194		4442	
1060432		-	
-		9540	
Roll Label	-	8943-S11	Pg. 176

OPK SERIES PUSH-IN CONNECTION TERMINAL BLOCKS

**OPK - 1IN / 2OUT - 2,5**

New Code: 1020285

Old Code: 1262

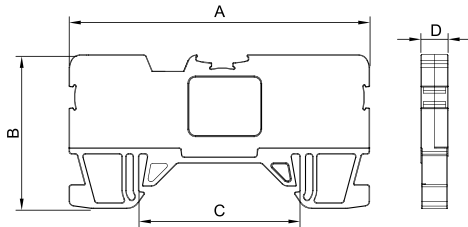
**OPK - 2IN / 2OUT - 2,5**

New Code: 1020275

Old Code: 1252

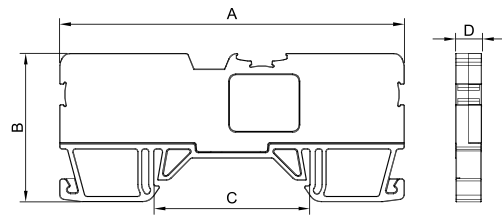
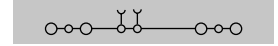

Dimension (mm)	A	B	C	D
	64,8	33,0	34,5	5,9

MATERIAL

Body	PA6.6	Spring	Stainless Steel
Bridge	Copper	Temp.	-40 °C, +140 °C
Orange Button	PA6.6	Cable Strip L.	9 mm

DATA	TSE / CE
Voltage	750 V
Current	24 A
Section	2,5 mm ²
Norm	EN-60947-7-1

COLOURS

COLOUR	V2	V2	V0	V0	Pcs.
	New Code	Old Code	New Code	Old Code	
GREY	1020285	1262	1020295	0662	50
CREAM	1020286	1263			50
BLACK	1020287	1264			50
BLUE	1020288	1265	1020296	0665	50
BROWN	1020289	1266			50
RED	1020290	1267	1020297	0667	50
YELLOW	1020291	1268			50
GREEN	1020292	1269			50

ACCESSORIES

Cross Connection	New Code	Old Code	Section	Pcs.	See Page
	1060106	1925	2,5 / 2	100	Pg. 67
	1060107	1926	2,5 / 3	100	
	1060108	1927	2,5 / 4	75	
	1060109	1928	2,5 / 10	30	
	1060110	1929	2,5 / 20	20	
Stopper	1060002	1202		100	Pg. 65-66
	1060005	1212		100	
	1060014	1222		100	
Group Sticker	1060024	1232		100	

MARKING

	New Code	Old Code	See Page
Dekafix	1060192	4440	Pg. 181 - 185
	1060194	4442	
	-	9540	
	-	9770	
Roll Label	-	8943-S11	Pg. 176

Dimension (mm)	A	B	C	D
	77,3	33,3	34,5	5,9

MATERIAL

Body	PA6.6	Spring	Stainless Steel
Bridge	Copper	Temp.	-40 °C, +140 °C
Orange Button	PA6.6	Cable Strip L.	9 mm

DATA	TSE / CE
Voltage	750 V
Current	24 A
Section	2,5 mm ²
Norm	EN-60947-7-1

COLOURS

COLOUR	V2	V2	V0	V0	Pcs.
	New Code	Old Code	New Code	Old Code	
GREY	1020275	1252	1020294	0652	50
CREAM	1020276	1253			50
BLACK	1020277	1254			50
BLUE	1020278	1255			50
BROWN	1020279	1256			50
RED	1020280	1257			50
YELLOW	1020281	1258			50
GREEN	1020282	1259			50

ACCESSORIES

Cross Connection	New Code	Old Code	Section	Pcs.	See Page
	1060106	1925	2,5 / 2	100	Pg. 67
	1060107	1926	2,5 / 3	100	
	1060108	1927	2,5 / 4	75	
	1060109	1928	2,5 / 10	30	
	1060110	1929	2,5 / 20	20	
Stopper	1060002	1202		100	Pg. 65-66
	1060005	1212		100	
	1060014	1222		100	
Group Sticker	1060024	1232		100	

MARKING

	New Code	Old Code	See Page
Dekafix	1060192	4440	Pg. 181 - 185
	1060194	4442	
	-	9540	
	-	9770	
Roll Label	-	8943-S11	Pg. 176



OPK SERIES PUSH-IN TEST TERMINAL BLOCKS



OPK - 2IN/2OUT - 2,5

New Code: 1020265

Old Code: 1242

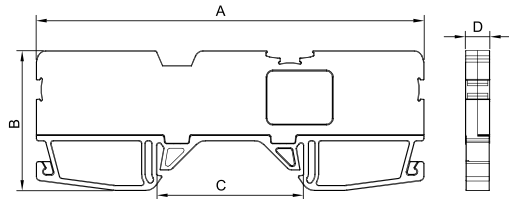
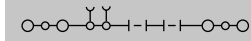

Dimension (mm)	A	B	C	D
	91,8	33,0	34,5	5,9
MATERIAL				
Body	PA6.6	Spring	Stainless Steel	
Bridge	Copper	Temp.	-40 °C, +140 °C	
Orange Button	PA6.6	Cable Strip L.	9 mm	
DATA	TSE / CEw			
Voltage	750 V		Section	2,5 mm ²
Current	24 A		Norm	EN-60947-7-1
Section	2,5 mm ²			
Norm	EN-60947-7-1			

COLOURS					
COLOUR	V2 New Code	V2 Old Code	V0 New Code	V0 Old Code	Pcs.
GREY	1020265	1242	1020293	0642	50
CREAM	1020266	1243			50
BLACK	1020267	1244			50
BLUE	1020268	1245			50
BROWN	1020269	1246			50
RED	1020270	1247			50
YELLOW	1020271	1248			50
GREEN	1020272	1249			50

ACCESSORIES					
Cross Connection	New Code	Old Code	Section	Pcs.	See Page
	1060106	1925	2,5 / 2	100	Pg. 67
	1060107	1926	2,5 / 3	100	
	1060108	1927	2,5 / 4	75	
	1060109	1928	2,5 / 10	30	
	1060110	1929	2,5 / 20	20	
Stopper	1060002	1202		100	Pg. 65-66
	1060005	1212		100	
	1060014	1222		100	
Group Sticker	1060024	1232		100	

MARKING			
	New Code	Old Code	See Page
Dekafix	1060192	4440	Pg. 181 - 185
	1060194	4442	
	-	9540	
	-	9770	
Roll Label	-	8943-S11	Pg. 176

OPK SERIES PUSH-IN FUSED TERMINAL BLOCKS



OPK - S 2,5

New Code: 1020223

Old Code: 2482

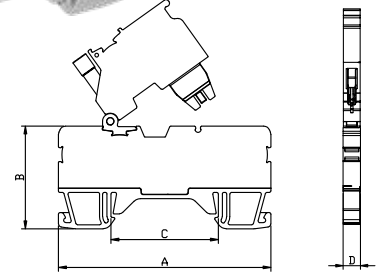
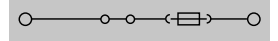

Dimension (mm)	A	B	C	D
	68,3	33,0	34,5	5,9
MATERIAL				
Body	PA6.6	Spring	Stainless Steel	
Bridge	Copper	Temp.	-40 °C, +140 °C	
Orange Button	PA6.6	Cable Strip L.	9 mm	
DATA	TSE / CEw			
Voltage	750 V		Section	2,5 mm ²
Current	6,3 A		Norm	EN-60947-7-1

COLOURS				VOLTAGE		
COLOUR	New Code	Old Code	Pcs.	Volt	New Code	Old Code
GREY	1020223	2482	50	Empty	1020223	2482
CREAM	1020224	2483	50	Bar	1020232	2492
BLACK	1020225	2484	50	12 V AC/DC LED	1020236	2502
BLUE	1020226	2485	50	24 V AC/DC LED	1020245	2512
BROWN	1020227	2486	50	48 V AC/DC LED	1020254	2532
RED	1020228	2487	50	110 V AC/DC LED	1020256	2552
YELLOW	1020229	2488	50	220 V AC/DC LED	1020258	2562
GREEN	1020230	2489	50			

ACCESSORIES					
Cross Connection	New Code	Old Code	Section	Pcs.	See Page
	1060106	1925	2,5 / 2	100	Pg. 67
	1060107	1926	2,5 / 3	100	
	1060108	1927	2,5 / 4	75	
	1060109	1928	2,5 / 10	30	
	1060110	1929	2,5 / 20	20	
Stopper	1060002	1202		100	Pg. 65-66
	1060005	1212		100	
	1060014	1222		100	
Group Sticker	1060024	1232		100	
Glass Fuse	WE-FS-52	-		100	-
5x20 mm Glass Fuse (0.2.....10A Please inform amp.)					

MARKING			
	New Code	Old Code	See Page
Dekafix	1060192	4440	Pg. 181 - 185
	1060194	4442	
	-	9540	
	-	9770	

OPK SERIES PUSH-IN CONNECTION EARTH RAIL TERMINAL BLOCKS

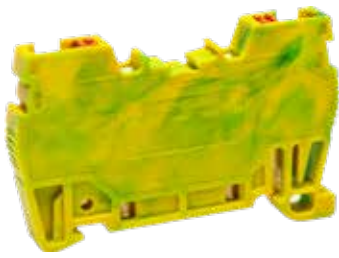

OPK-T 1,5
Code: 1020834

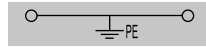

OPK-T 2,5
Code: 1020835

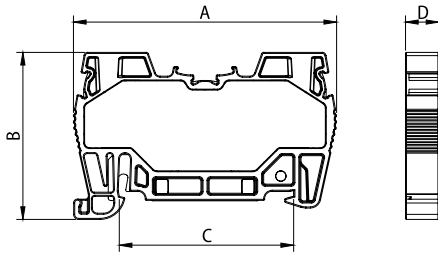
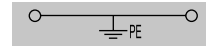

* MONOBLOCK *

Dimension (mm)	A	B	C	D
	52,0	33,0	34,5	5,0

MATERIAL

Body	PA6.6	Spring	Stainless Steel
Bridge	Copper	Temp.	-40 °C, +140 °C
Orange Button	PA6.6	Cable Strip L.	9 mm
The Foot Which Contact to the Rail	Brass		

DATA	TSE / CE
Voltage	750 V
Section	1,5 mm ²
Norm	EN-60947-7-2

COLOURS

COLOUR	New Code	Old Code	Pcs.
CAMOUFLAGE	1020834	-	100

ACCESSORIES

Cross Connection	New Code	Old Code	Section	Pcs.	See Page
	1060101	1920	1,5 / 2	100	Pg. 67
	1060102	1921	1,5 / 3	100	
	1060103	1922	1,5 / 4	100	
	1060104	1923	1,5 / 10	30	
	1060105	1924	1,5 / 20	20	
Stopper	1060002	1202		100	Pg. 65-66
	1060005	1212		100	
	1060014	1222		100	
Group Sticker	1060024	1232		100	

MARKING

	New Code	Old Code	See Page
Dekafix	1060198	5443	Pg. 181 - 185
	1060194	4442	
	-	9540	
	-	9770	
Roll Label	-	8943-S11	Pg. 176

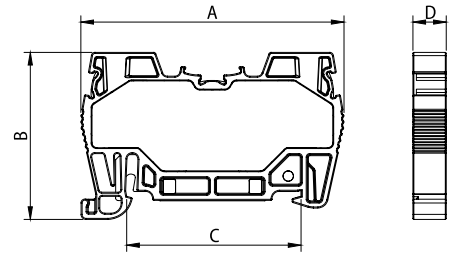

* MONOBLOCK *

Dimension (mm)	A	B	C	D
	52,0	33,0	34,5	5,8

MATERIAL

Body	PA6.6	Spring	Stainless Steel
Bridge	Copper	Temp.	-40 °C, +140 °C
Orange Button	PA6.6	Cable Strip L.	9 mm
The Foot Which Contact to the Rail	Brass		

DATA	TSE / CE
Voltage	750 V
Section	2,5 mm ²
Norm	EN-60947-7-2

COLOURS

COLOUR	New Code	Old Code	Pcs.
CAMOUFLAGE	1020835	-	100

ACCESSORIES

Cross Connection	New Code	Old Code	Section	Pcs.	See Page
	1060106	1925	2,5 / 2	100	Pg. 67
	1060107	1926	2,5 / 3	100	
	1060108	1927	2,5 / 4	75	
	1060109	1928	2,5 / 10	30	
	1060110	1929	2,5 / 20	20	
Stopper	1060002	1202		100	Pg. 65-66
	1060005	1212		100	
	1060014	1222		100	
Group Sticker	1060024	1232		100	

MARKING

	New Code	Old Code	See Page
Dekafix	1060192	4440	Pg. 181 - 185
	1060194	4442	
	-	9540	
	-	9770	
Roll Label	-	8943-S11	Pg. 176

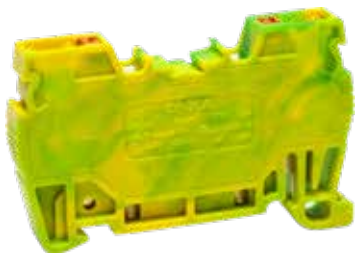
OPK SERIES PUSH-IN CONNECTION EARTH RAIL TERMINAL BLOCKS

OPK-T4
New Code: 1020299
Old Code: 1199

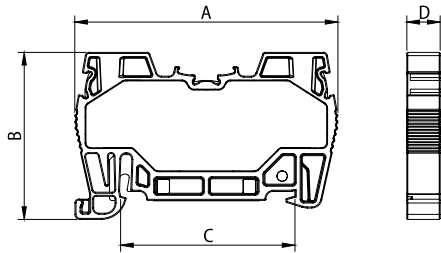

* MONOBLOCK *

Dimension (mm)	A	B	C	D
	52,0	33,0	34,5	6,6

MATERIAL

Body	PA6.6	Spring	Stainless Steel
Bridge	Copper	Temp.	-40 °C, +140 °C
Orange Button	PA6.6	Cable Strip L.	9 mm
The Foot Which Contact to the Rail	Brass		

DATA	TSE / CE
Voltage	750 V
Section	4 mm ²
Norm	EN-60947-7-2

COLOURS

COLOUR	New Code	Old Code	Pcs.
CAMOUFLAGE	1020299	1199	100

ACCESSORIES

Cross Connection	New Code	Old Code	Section	Pcs.	See Page
	1060111	1930	4 / 2	100	Pg. 67
	1060112	1931	4 / 3	100	
	1060113	1932	4 / 4	50	
	1060114	1933	4 / 10	30	
	1060115	1934	4 / 20	20	
Stopper	1060002	1202		100	Pg. 65-66
	1060005	1212		100	
	1060014	1222		100	
Group Sticker	1060024	1232		100	

MARKING

	New Code	Old Code	See Page
Dekafix	1060190	4390	Pg. 181 - 185
	1060194	4442	
	-	9540	
	-	9770	
Roll Label	-	8943-S11	Pg. 176

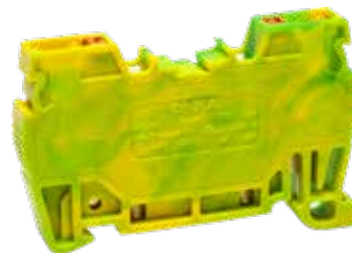

OPK-T6
Code: 1020836

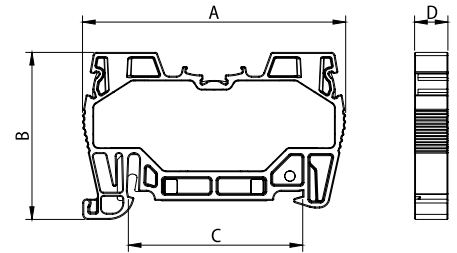
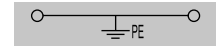

* MONOBLOCK *

Dimension (mm)	A	B	C	D
	66,3	38,0	34,5	8,1

MATERIAL

Body	PA6.6	Spring	Stainless Steel
Bridge	Copper	Temp.	-40 °C, +140 °C
Orange Button	PA6.6	Cable Strip L.	12 mm
The Foot Which Contact to the Rail	Brass		

DATA	TSE / CE
Voltage	750 V
Section	6 mm ²
Norm	EN-60947-7-2

COLOURS

COLOUR	New Code	Old Code	Pcs.
CAMOUFLAGE	1020836	-	100

ACCESSORIES

Cross Connection	New Code	Old Code	Section	Pcs.	See Page
	1060126	1945	6 / 2	100	Pg. 67
	1060127	1946	6 / 3	50	
	1060128	1947	6 / 4	50	
	1060129	1948	6 / 10	15	
	1060130	1949	6 / 20	10	
Stopper	1060002	1202		100	Pg. 65-66
	1060005	1212		100	
	1060014	1222		100	
Group Sticker	1060024	1232		100	

MARKING

	New Code	Old Code	See Page
Dekafix	1060188	2630	Pg. 181 - 185
	1060194	4442	
	-	9540	
	-	9770	
Roll Label	-	8943-S11	Pg. 176

OPK SERIES PUSH-IN CONNECTION EARTH RAIL TERMINAL BLOCKS

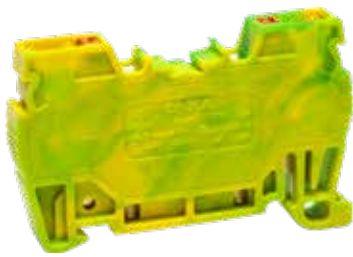

OPK-T 10

New Code: 1020300

Old Code: 1200

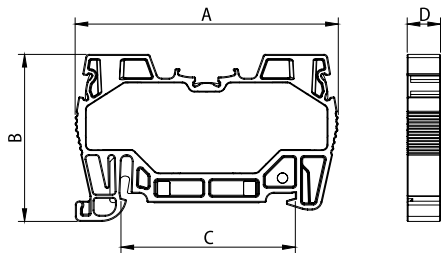

* MONOBLOCK *

Dimension (mm)	A	B	C	D
	66,3	38,0	34,5	9,5

MATERIAL

Body	PA6.6	Spring	Stainless Steel
Bridge	Copper	Temp.	-40 °C, +140 °C
Orange Button	PA6.6	Cable Strip L.	12 mm
The Foot Which Contact to the Rail	Brass		

DATA	TSE / CE
Voltage	750 V
Section	10 mm ²
Norm	EN-60947-7-2

COLOURS

COLOUR	New Code	Old Code	Pcs.
CAMOUFLAGE	1020300	1200	100

ACCESSORIES

Cross Connection	New Code	Old Code	Section	Pcs.	See Page
	1060131	1950	10 / 2	100	Pg. 67
	1060132	1951	10 / 3	50	
	1060133	1952	10 / 4	50	
	1060134	1953	10 / 10	15	
	1060135	1954	10 / 20	10	
Stopper	1060002	1202		100	Pg. 65-66
	1060005	1212		100	
	1060014	1222		100	
Group Sticker	1060024	1232		100	

MARKING

	New Code	Old Code	See Page
Dekafix	1060188	2630	Pg. 181 - 185
	1060194	4442	
	-	9540	
	-	9770	
Roll Label	-	8943-S11	Pg. 176

OPK SERIES SENSOR RAIL TERMINAL BLOCKS



OPK - 1,5 SENSOR

Code: 1020846

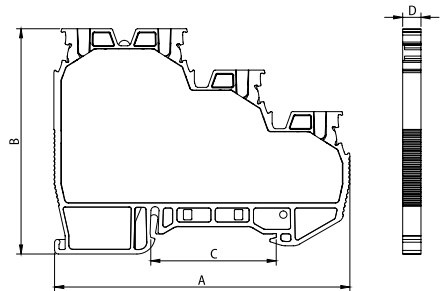
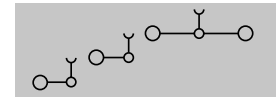

* MONOBLOCK *

Dimension (mm)	A	B	C	D
	81,1	61,9	34,5	5,0

MATERIAL

Body	PA6.6	Spring	Stainless Steel
Bridge	Copper	Temp.	-40 °C, +140 °C
Orange Button	PA6.6	Cable Strip L.	9 mm

DATA	TSE / CE
Voltage	750 V
Section	1,5 mm ²
Norm	EN-60947-7-2

COLOURS

COLOUR	V2 Code	V0 Code	Pcs.
GRAY	1020846	1020847	20

ACCESSORIES

Cross Connection	New Code	Old Code	Section	Pcs.	See Page
	1060101	1920	1,5 / 2	100	Pg. 67
	1060102	1921	1,5 / 3	100	
	1060103	1922	1,5 / 4	100	
	1060104	1923	1,5 / 10	30	
	1060105	1924	1,5 / 20	20	
Stopper	1060002	1202		100	Pg. 65-66
	1060005	1212		100	
	1060014	1222		100	
Group Sticker	1060024	1232		100	
EARTH	1020848				

MARKING

	New Code	Old Code	See Page
Dekafix	1060198	5443	Pg. 181 - 185
	1060194	4442	
	-	9540	
	-	9770	
Roll Label	-	8943-S11	Pg. 176

OPK SERIES SENSOR RAIL TERMINAL BLOCKS

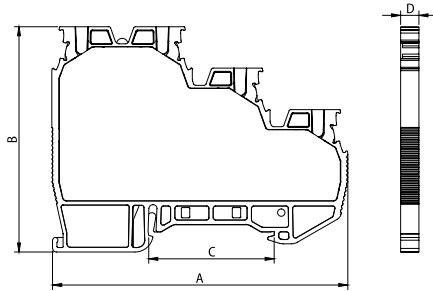
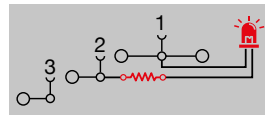
OPK - 1,5 PNP SENSOR
 Code: 1020850

* MONOBLOCK *

Dimension (mm)	A	B	C	D
	81,1	61,9	34,5	5,0

MATERIAL

Body	PA6.6	Spring	Stainless Steel
Bridge	Copper	Temp.	-40 °C, +140 °C
Orange Button	PA6.6	Cable Strip L.	9 mm

DATA	TSE / CE
Voltage	750 V
Section	1,5 mm ²
Norm	EN-60947-7-2

COLOURS

COLOUR	V2 Code	V0 Code	Pcs.
GRAY	1020850	1020851	20

ACCESSORIES

Cross Connection	New Code	Old Code	Section	Pcs.	See Page
	1060101	1920	1,5 / 2	100	Pg. 67
	1060102	1921	1,5 / 3	100	
	1060103	1922	1,5 / 4	100	
	1060104	1923	1,5 / 10	30	
	1060105	1924	1,5 / 20	20	
Stopper	1060002	1202		100	Pg. 65-66
	1060005	1212		100	
	1060014	1222		100	
Group Sticker	1060024	1232		100	

MARKING

	New Code	Old Code	See Page
Dekafix	1060198	5443	Pg. 181 - 185
	1060194	4442	
	-	9540	
	-	9770	
Roll Label	-	8943-S11	Pg. 176

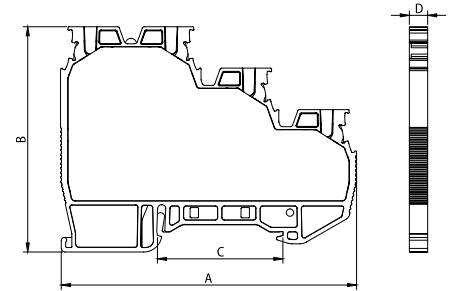
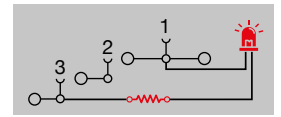
OPK - 1,5 NPN SENSOR
 Code: 1020852

* MONOBLOCK *

Dimension (mm)	A	B	C	D
	81,1	61,9	34,5	5,0

MATERIAL

Body	PA6.6	Spring	Stainless Steel
Bridge	Copper	Temp.	-40 °C, +140 °C
Orange Button	PA6.6	Cable Strip L.	9 mm

DATA	TSE / CE
Voltage	750 V
Section	1,5 mm ²
Norm	EN-60947-7-2

COLOURS

COLOUR	V2 Code	V0 Code	Pcs.
GRAY	1020852	1020853	20

ACCESSORIES

Cross Connection	New Code	Old Code	Section	Pcs.	See Page
	1060101	1920	1,5 / 2	100	Pg. 67
	1060102	1921	1,5 / 3	100	
	1060103	1922	1,5 / 4	100	
	1060104	1923	1,5 / 10	30	
	1060105	1924	1,5 / 20	20	
Stopper	1060002	1202		100	Pg. 65-66
	1060005	1212		100	
	1060014	1222		100	
Group Sticker	1060024	1232		100	

MARKING

	New Code	Old Code	See Page
Dekafix	1060198	5443	Pg. 181 - 185
	1060194	4442	
	-	9540	
	-	9770	
Roll Label	-	8943-S11	Pg. 176

PUSH-IN TERMINAL BLOCK FOR PCB CONNECTION

SOCKET TERMINAL FEMALE 5,08 MM



PC-P 2,5

New Code: 1020302

Old Code: 0382

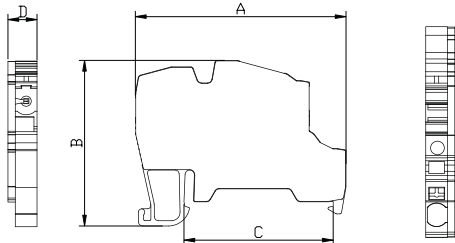
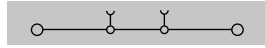

Dimension (mm)	A	B	C	D
	49,0	38,5	34,5	6,7

MATERIAL

Body	PA6.6	Spring	Stainless Steel
Bridge	Copper	Temp.	-40 °C, +140 °C
Orange Button	PA6.6	Cable Strip L.	10 mm

DATA	TSE / CE
Voltage	500 V
Current	17,5 A
Section	2,5 mm ²
Norm	EN-60947-7-1

COLOURS

COLOUR	V2	V2	V0	V0	Pcs.
	New Code	Old Code	New Code	Old Code	
GREY	1020302	0382	1020304	0322	50
CREAM		0383		0323	50
BLACK		0384		0324	50
BLUE		0385		0325	50
BROWN		0386		0326	50
RED		0387		0327	50
YELLOW		0388		0328	50
GREEN		0389		0329	50

ACCESSORIES

Cross Connection	New Code	Old Code	Section	Pcs.	See Page
	1060106	1925	2,5 / 2	100	Pg. 67
	1060107	1926	2,5 / 3	100	
	1060108	1927	2,5 / 4	75	
	1060109	1928	2,5 / 10	30	
	1060110	1929	2,5 / 20	20	
Stopper	1060002	1202		100	Pg. 65-66
	1060005	1212		100	
	1060014	1222		100	
Group Sticker	1060024	1232		100	
PCB-N End Plate	1020301	0352		10	
PCB-N End Plate (V0)	1020303	0312		10	

MARKING

	New Code	Old Code	See Page
Dekafix	1060192	4440	Pg. 181 - 185
	1060194	4442	
	-	9540	
	-	9770	
Roll Label	-	8943-S11	Pg. 176

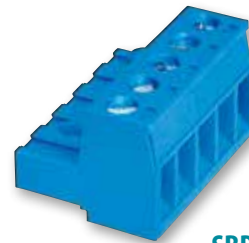
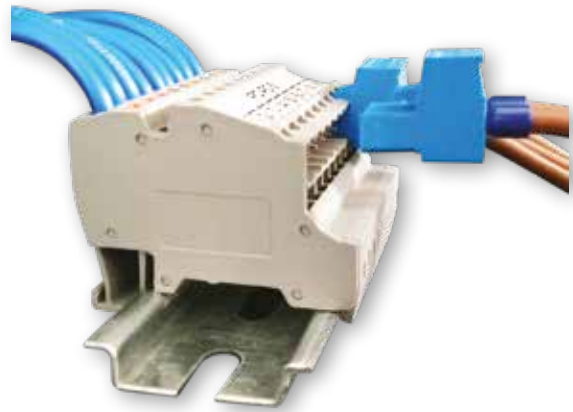

SBDK 5,08

PIN NUMBER	Blue Order No.	Green Order No.	Pcs. Box
2	10.202	11.202	200
3	10.203	11.203	100
4	10.204	11.204	100
5	10.205	11.205	100
6	10.206	11.206	100
7	10.207	11.207	100
8	10.208	11.208	100
9	10.209	11.209	100
10	10.210	11.210	50
11	10.211	11.211	50
12	10.212	11.212	50

MRK AND OPK SERIES SCREWLESS STOPPER



Screwless Stopper

New Code: 1060002

Old Code: 1202

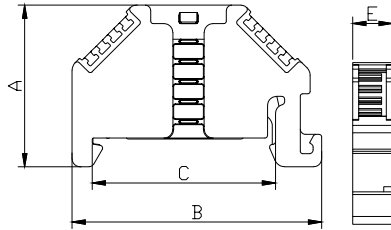

Dimension (mm)	A	B	C	D
	30,7	47,4	34,5	7,5

MATERIAL

Body	PA	Temp.	-40 °C, +140 °C
Screw	Stainless Steel	Pcs	100

MARKING

	New Code	Old Code	See Page
	Dekafix	1060188	2630
	1060190	4390	
	1060192	4440	
	1060194	4442	
	1060198	5443	
	-	9540	
	-	9770	

MRK AND OPK SERIES MINI STOPPER



Mini Stopper

New Code: 1060014

Old Code: 1222

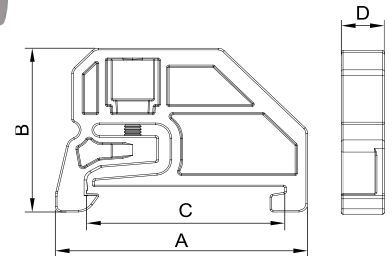

Dimension (mm)	A	B	C	D
	43,0	30,0	34,5	7,5

MATERIAL

Body	PA	Temp.	-40 °C, +140 °C
Screw	Steel	Pcs	100

MARKING

	New Code	Old Code	See Page
	Dekafix	1060190	4390
	1060192	4440	
	1060194	4442	
	1060198	5443	
	-	9540	
	-	9770	
	-	9770	

GROUP MARKER



Group Marker

New Code: 1060093

Old Code: 1482

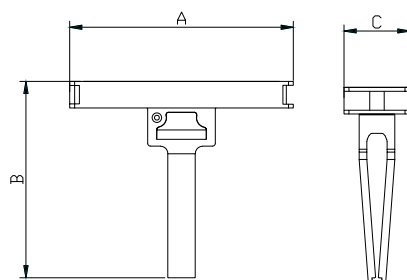

Dimension (mm)	A	B	C
	46,2	40,6	13,6

MATERIAL

Body	PC	Temp.	-40 °C, +140 °C
Pcs	100		

GROUP LABEL



Group Label

Code: 1060500

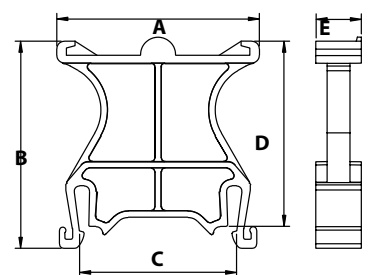

It can be marked by "ONKA-8920-736SE/SB" sticker.

Dimension (mm)	A	B	C	D	E
	44,5	45,5	34,5	40,7	10

MATERIAL

Body	PA 6.6	Pcs	100
Temp.	-40 °C, +140 °C		

MRK AND OPK SERIES BIG STOPPER

**Big Stopper**

New Code: 1060005

Old Code: 1212

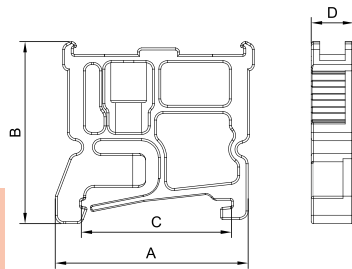

It can be marked by
"ONKA-8920-736SE/SB" sticker.

Dimension (mm)	A	B	C	D
	44,6	43,5	34,5	9,8

MATERIAL

Body	PA	Temp.	-40 °C, +140 °C
Screw	Steel	Pcs	100

MARKING

Dekafix	New Code	Old Code	See Page
	1060190	4390	Pg. 181 - 185
1060192	4440		
1060194	4442		
1060198	5443		
-	9540		
-	9770		

MRK AND OPK SERIES BIG STOPPER

**Stopper With Group Sticker**

New Code: 1060024

Old Code: 1232

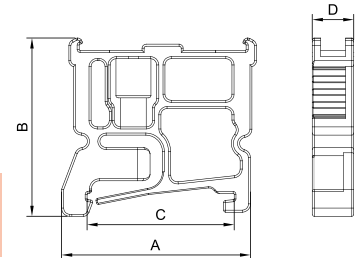

It can be marked by
"ONKA-8920-736SE/SB" sticker.

Dimension (mm)	A	B	C	D
	44,6	43,5	34,5	9,8

MATERIAL

Body	PA	Temp.	-40 °C, +140 °C
Screw	Steel	Pcs	100

MARKING

Dekafix	New Code	Old Code	See Page
	1060190	4390	Pg. 181 - 185
1060192	4440		
1060194	4442		
1060198	5443		
-	9540		
-	9770		

OPK SERIES SEPARATION PLATE

**OPK Series Separation Plate**

New Code: 1060053

Old Code: 0592

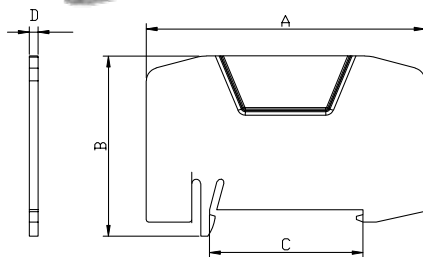

Dimension (mm)	A	B	C	D
	63,5	41,3	34,5	2,0

MATERIAL

Body	PA	Temp.	-40 °C, +140 °C
Pcs	25		

COLOURS

COLOUR	New Code	Old Code	Pcs.
GREY	1060053	0592	25
RED	1060054	0597	25

MRK AND OPK SERIES SEPARATION PLATE

**High Type Separation Plate**

Code: 1060527

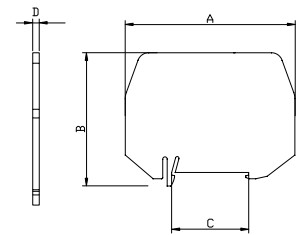

Dimension (mm)	A	B	C	D
	52,0	48,0	34,5	2,0

MATERIAL

Body	PA	Temp.	-40 °C, +140 °C
Pcs	25		

COLOURS

COLOUR	Code	Pcs.
GREY	1060527	25
CREAM	1060528	25
BLACK	1060529	25
BLUE	1060530	25
BROWN	1060531	25
RED	1060532	25
YELLOW	1060533	25
GREEN	1060534	25

OPK SERIES CROSS CONNECTIONS

MATERIAL	
Isolation	PA 6.6
Body	Brass
Covering	Tin

Note: All 1,5 mm², 2,5 mm² and 4 mm² cross connections can be both used for MRK and OPK Series.

For the Slim Series, please check the relevant product accessories section.

COLOUR	NEW CODE	OLD CODE	TYPE	PCS
Orange	1060101	1920	1.5 x 2	100
Orange	1060102	1921	1.5 x 3	100
Orange	1060103	1922	1.5 x 4	100
Orange	1060104	1923	1.5 x 10	30
Orange	1060105	1924	1.5 x 20	20
Orange	1060106	1925	2.5 x 2	100
Orange	1060107	1926	2.5 x 3	100
Orange	1060108	1927	2.5 x 4	75
Orange	1060109	1928	2.5 x 10	30
Orange	1060110	1929	2.5 x 20	20
Orange	1060111	1930	4 x 2	100
Orange	1060112	1931	4 x 3	100
Orange	1060113	1932	4 x 4	50
Orange	1060114	1933	4 x 10	30
Orange	1060115	1934	4 x 20	20
Red	1060126	1945	6 x 2	100
Red	1060127	1946	6 x 3	50
Red	1060128	1947	6 x 4	50
Red	1060129	1948	6 x 10	15
Red	1060130	1949	6 x 20	10
Red	1060131	1950	10 x 2	100
Red	1060132	1951	10 x 3	50
Red	1060133	1952	10 x 4	50
Red	1060134	1953	10 x 10	15
Red	1060135	1954	10 x 20	10
Red	1060136	1955	16 x 2	10
Red	1060137	1956	16 x 3	10
Red	1060138	1957	16 x 4	10
Red	1060139	1958	16 x 10	10
Red	1060140	1959	35 x 2	10
Red	1060141	1960	35 x 3	10
Red	1060142	1961	35 x 4	10
Red	1060143	1962	35 x 10	10

USED ONLY WITH OPK SERIES



Monolithic insulated body provides high durability to the conductor busbar



Due to the channels on the comb bridge, it gives the chance to be cut from the center of the pin gap
This feature is valid with 10 and 20 pin bridges



It can be easily disassembled with a screwdriver, by the help of the notch over the bridge

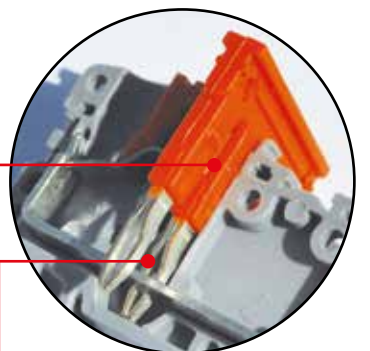

Continuous and safe contact from four points due to the diagonal structure of the pins

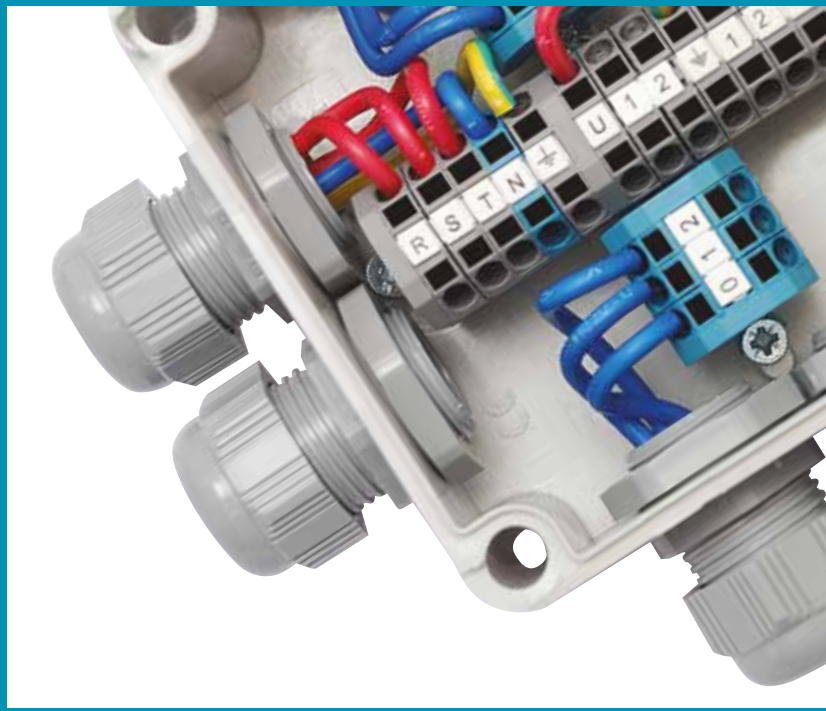
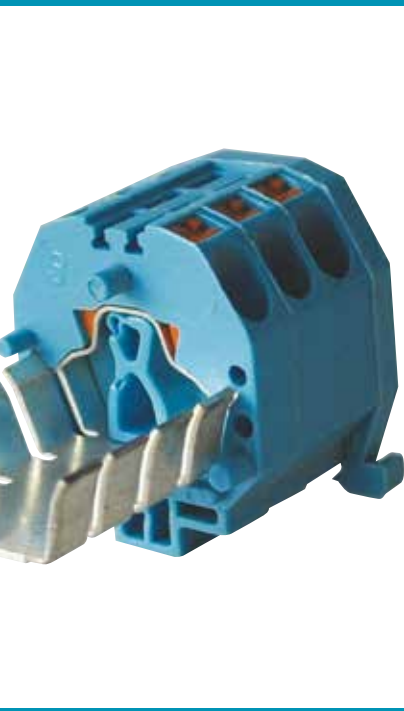

Range of Products;

- MPK Series Push-In connection mini terminal blocks
- MPK Series Push-In connection mini earth terminal blocks
- MPK Series Push-In connection bridged mini terminal blocks
- MPK Series Screwless stopper
- MPK Series Stopper & end Bracket (Rail Mountable)
- MPK Series Stopper & end Bracket (Ground Mountable)

MPK SERIES



MPK SERIES PUSH-IN CONNECTION MINI TERMINAL BLOCKS



MPK 2,5
Closed Type
 New Code: 1020306
 Old Code: 1422



MPK 2,5
Open Type
 New Code: 1020327
 Old Code: 1462

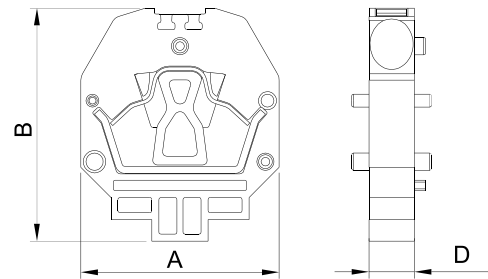
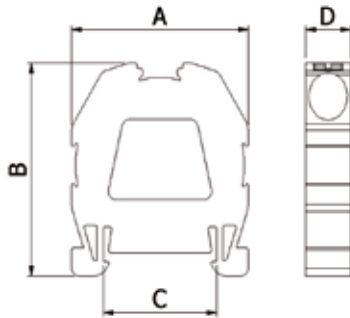

* MONOBLOCK *

Dimension (mm)	A	B	C	D
	23,0	26,4	15,0	5,9

MATERIAL			
Body	PA6.6	Spring	Stainless Steel
Bridge	Copper	Temp.	-40 °C, +140 °C
Orange Button	PA6.6	Cable Strip L.	8 mm

DATA	TSE / CE
Voltage	750 V
Current	24 A
Section	2,5 mm ²
Norm	EN-60947-7-1

COLOURS			
COLOUR	New Code	Old Code	Pcs.
GREY	1020306	1422	100
CREAM	1020307	1423	100
BLACK	1020308	1424	100
BLUE	1020309	1425	100
BROWN	1020310	1426	100
RED	1020311	1427	100
YELLOW	1020312	1428	100
GREEN	1020313	1429	100

ACCESSORIES			
	New Code	Old Code	See Page
Stopper	1060084	1472	Pg. 72
	1100110	4247	
Rail	1100115	4252	Pg. 129
	1100055	4102	
	1100060	4112	

MARKING			
Dekafix	New Code	Old Code	See Page
	-	9540	Pg. 184

Dimension (mm)	A	B	D
	23,0	27,0	5,3

MATERIAL			
Body	PA6.6	Spring	Stainless Steel
Bridge	Copper	Temp.	-40 °C, +140 °C
Orange Button	PA6.6	Cable Strip L.	8 mm

DATA	TSE / CE
Voltage	750 V
Current	24 A
Section	2,5 mm ²
Norm	EN-60947-7-1

COLOURS			
COLOUR	New Code	Old Code	Pcs.
GREY	1020327	1462	100
CREAM	1020328	1463	100
BLACK	1020329	1464	100
BLUE	1020330	1465	100
BROWN	1020331	1466	100
RED	1020332	1467	100
YELLOW	1020333	1468	100
GREEN	1020334	1469	100

ACCESSORIES			
	New Code	Old Code	See Page
Stopper	1060034	1442	Pg. 72
	1060043	1452	
Rail	1100110	4247	Pg. 129
	1100115	4252	
	1100055	4102	
	1100060	4112	

MARKING			
Dekafix	New Code	Old Code	See Page
	-	9540	Pg. 184

MPK SERIES PUSH-IN CONNECTION EARTH MINI TERMINAL BLOCKS

MPK SERIES PUSH-IN CONNECTION BRIDGED MINI TERMINAL BLOCKS



MPK 2,5 (Earth)

Closed Type

New Code: 1020335

Old Code: 1470

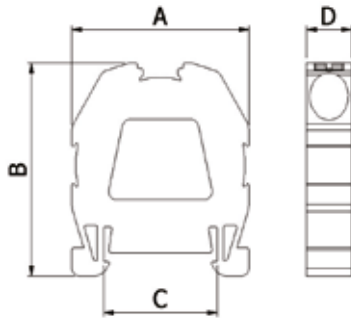
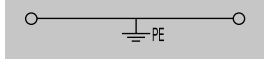

* MONOBLOCK *

Dimension (mm)	A	B	C	D
	23,0	26,4	15,0	5,9

MATERIAL

Body	PA6.6	Spring	Stainless Steel
Bridge	Copper	Temp.	-40 °C, +140 °C
Orange Button	PA6.6	Cable Strip L.	8 mm
The Foot Which Contact to the Rail	Brass		

DATA	TSE / CE
Voltage	750 V
Current	24 A
Section	2,5 mm ²
Norm	EN-60947-7-1

COLOURS

COLOUR	New Code	Old Code	Pcs.
CAMOUFLAGE	1020335	1470	100

ACCESSORIES

	New Code	Old Code	See Page
Stopper	1060084	1472	Pg. 72
Rail	1100110	4247	Pg. 129
	1100115	4252	
	1100055	4102	
	1100060	4112	

MARKING

Dekafix	New Code	Old Code	See Page
	-	9540	Pg. 184

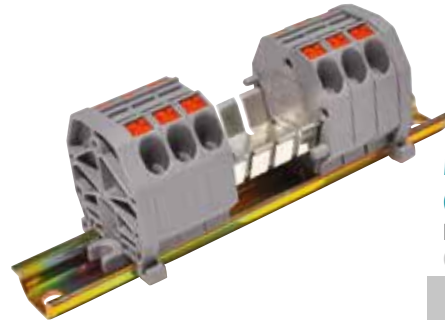

MPK 2,5 (Bridged)

Open Type

New Code: 1020315

Old Code: 1432

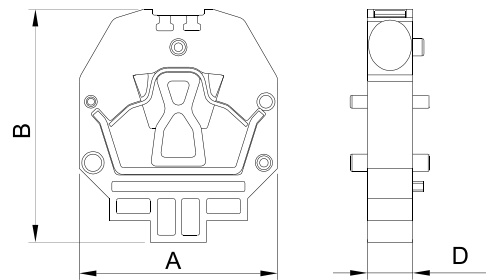

The price is determined by the number of bridged terminal blocks included in the set.

Dimension (mm)	A	B	D
	23,0	27,0	5,3

MATERIAL

Body	PA6.6	Spring	Stainless Steel
Bridge	Copper	Temp.	-40 °C, +140 °C
Orange Button	PA6.6	Cable Strip L.	8 mm

DATA	TSE / CE
Voltage	750 V
Current	24 A
Section	2,5 mm ²
Norm	EN-60947-7-1

COLOURS

COLOUR	New Code	Old Code	Pcs.
GREY	1020315	1432	100
CREAM	1020316	1433	100
BLACK	1020317	1434	100
BLUE	1020318	1435	100
BROWN	1020319	1436	100
RED	1020320	1437	100
YELLOW	1020321	1438	100
GREEN	1020322	1439	100

ACCESSORIES

	New Code	Old Code	See Page
Stopper	1060034	1442	Pg. 72
	1060043	1452	
Rail	1100110	4247	Pg. 129
	1100115	4252	
	1100055	4102	
	1100060	4112	

MARKING

Dekafix	New Code	Old Code	See Page
	-	9540	Pg. 176



MP SERIES PUSH-IN CONNECTION SETS FOR 6 mm² FEED MODULE (DISTRIBUTION BLOCK)



MP 6
Code: 1020838
Feed Module

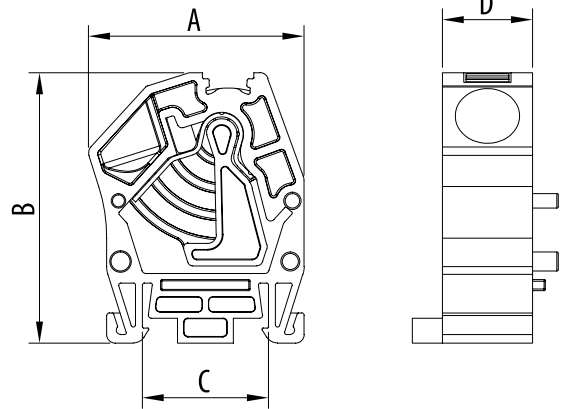

COLOURS		
COLOUR	Code	Pcs.
GREY	1020838	100
CREAM	1020839	100
BLACK	1020840	100
BLUE	1020841	100
BROWN	1020842	100
RED	1020843	100
YELLOW	1020844	100
GREEN	1020845	100

ACCESSORIES			
	New Code	Old Code	See Page
Stopper	1060034	1442	Pg. 72
	1060043	1452	
Rail	1100110	4247	Pg. 129
	1100115	4252	
	1100055	4102	
	1100060	4112	

Dimension (mm)	A	B	C	D
	25,1	31,5	14,7	10,5

MATERIAL			
Body	PA6.6	Spring	Stainless Steel
Bridge	Copper	Temp.	-40 °C, +140 °C
Orange Button	PA6.6	Cable Strip L.	12 mm

DATA	TSE / CE
Voltage	750 V
Current	41A
Section	6 mm ²
Norm	EN-60947-7-1

MARKING			
	New Code	Old Code	See Page
Dekafix	1060188	2630	Pg. 181 - 185
	1060194	4442	
	-	9540	
	-	9770	
Roll Label	-	8943-S11	Pg. 176



For adding cables in the range of 2.5 - 10 mm².

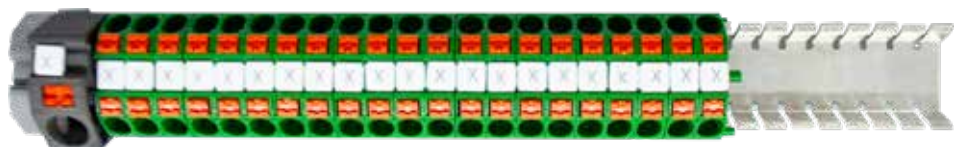
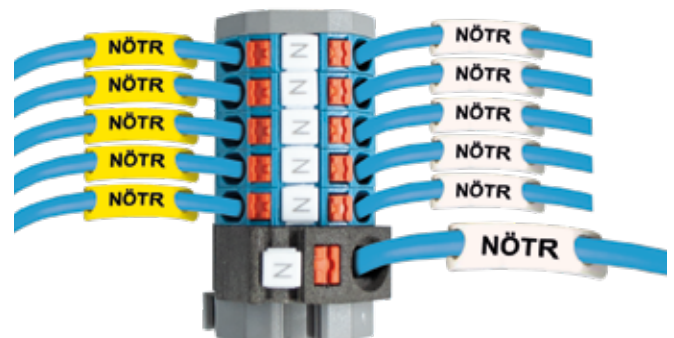

Unlimited flexible combination solutions with 0-2.5 mm² push-in connections for field electrification and panel internal distribution/collecting applications.

MPK SERIES SCREWLESS STOPPER



MPK Stopper
New Code: 1060084
Old Code: 1472

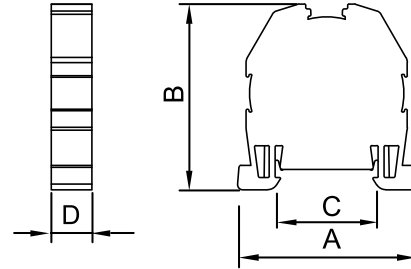

COLOURS			
COLOUR	New Code	Old Code	Pcs.
GREY	1060084	1472	100
CREAM	1060085	1473	100
BLACK	1060086	1474	100
BLUE	1060087	1475	100
BROWN	1060088	1476	100
RED	1060089	1477	100
YELLOW	1060090	1478	100
GREEN	1060091	1479	100

Dimension (mm)	A	B	C	D
	23	26,5	14,7	5,8

MATERIAL			
Body	PA6.6	Temp.	-40 °C, +140 °C
Metal Leg	Steel	Pcs	25

MARKING			
Dekafix	New Code	Old Code	See Page
	-	9540	Pg. 184

MPK SERIES STOPPER & END BRACKET (GROUND MOUNTABLE)



MPK Stopper & End Bracket
New Code: 1060034
Old Code: 1442

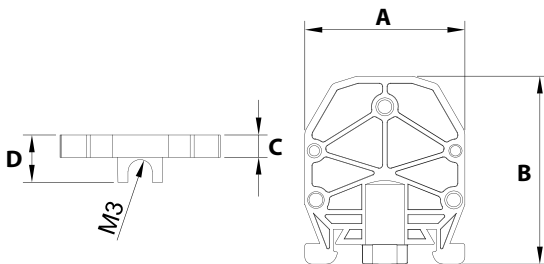

MPK Stopper & End Bracket
New Code: 1060043
Old Code: 1452

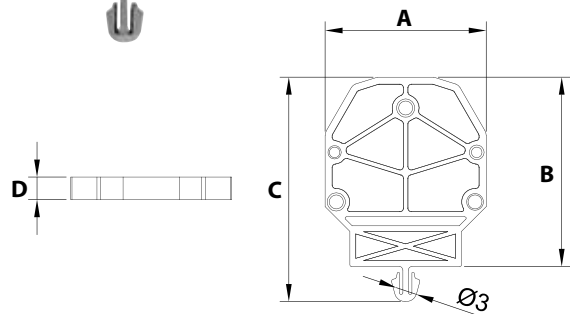

Dimension (mm)	A	B	C	D
	23,2	27,1	3,2	6,8

MATERIAL			
Body	PA6.6	Temp.	-40 °C, +140 °C
Pcs	100		

Dimension (mm)	A	B	C	D
	23,2	27,1	32,1	3,2

MATERIAL			
Body	PA6.6	Temp.	-40 °C, +140 °C
Pcs	100		