

MRK SERIES SCREW CONNECTION RAIL TERMINAL BLOCKS

Technical Features;

- Does not require final plate (Both sides are closed), provides cost saving and better isolation
- Symmetrical (Mountable to rail at both directions)
- Provides opportunity to assemble cable section from 0,06 mm² to 120 mm²
- Labelling system appropriate for roll labeling
- Double sided bridging opportunity
- Isolated comb bridge can be used from 1,5 mm² to 10 mm²
- Screw system is flat headed for sections 10 mm² to 35 mm²
- In 50 mm² and following sections, the screw system is allen headed
- MRK Series stopper can be used both as group label or end label

Range of Products;

- MRK Series standard rail terminal blocks
- MRK Series double rail terminal blocks
- MRK Series fused rail terminal blocks
- MRK Series knife rail terminal blocks
- MRK Series test disconnect terminal blocks
- MRK Series earth rail terminal blocks
- MRK and OPK Series stoppers
- MRK Series separation plate
- MRK Series Cross Connections
- MRK Series stud terminal blocks for cable lugs

MRK SERIES



In MRK Series, the roll label system can be applied to the products from 1.5 mm² to 35 mm² cross sections

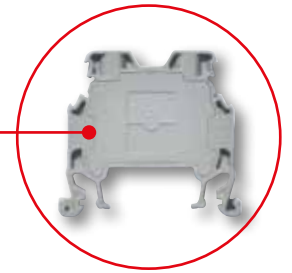

The main body of which end plate is embedded, is manufactured as monolithic



For MRK Series a new cross connection system is used from 1.5 mm² up to 10 mm²

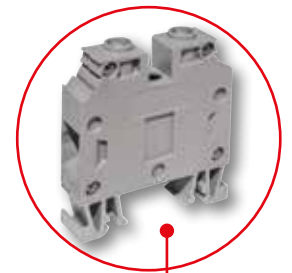
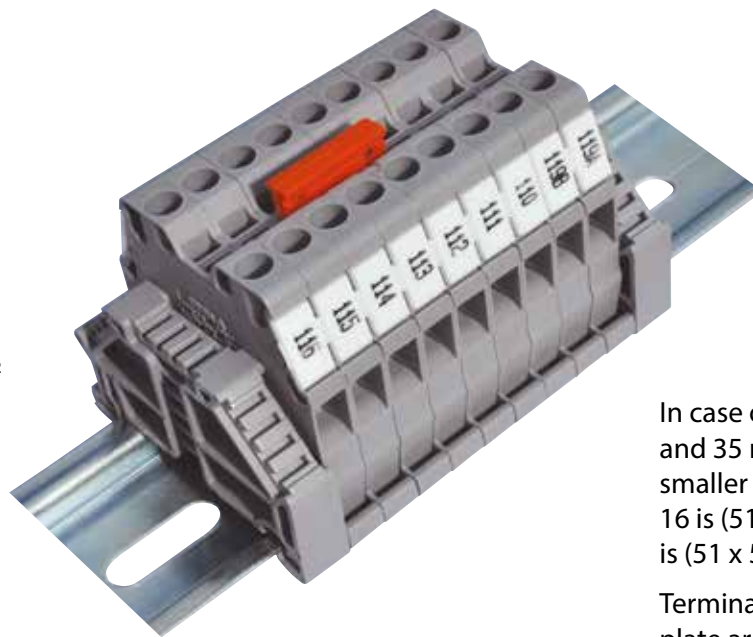

In case of the new MRK 16 mm² and 35 mm², the dimensions are smaller than the old series. MRK 16 is (51 x 54 x 12) mm, MRK 35 is (51 x 54 x 15) mm

Terminal block's body and end plate are connected within 4 steel screws

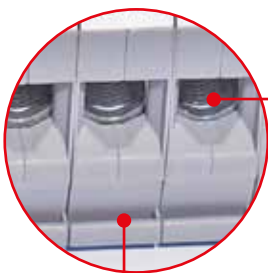

Due to the U form at the bottom of the sleeve system of MRK 6-10-16-25 and 35, much contact of the sleeve is provided to the cable

MRK 16 and 35 mm², the leg parts of terminal can be locked more better because of the same width as the terminal

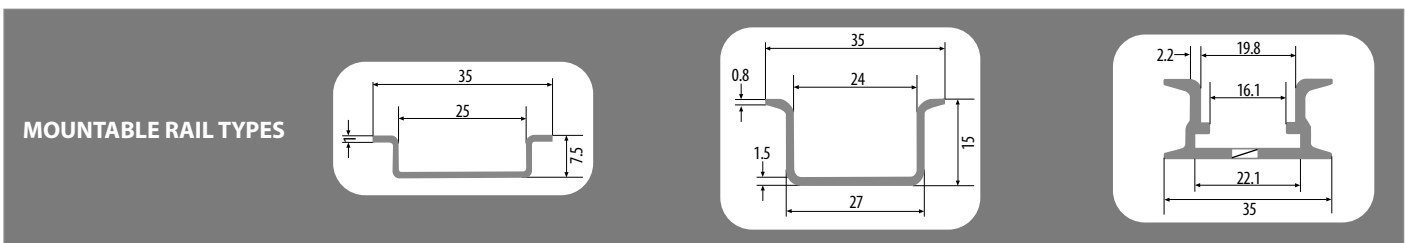
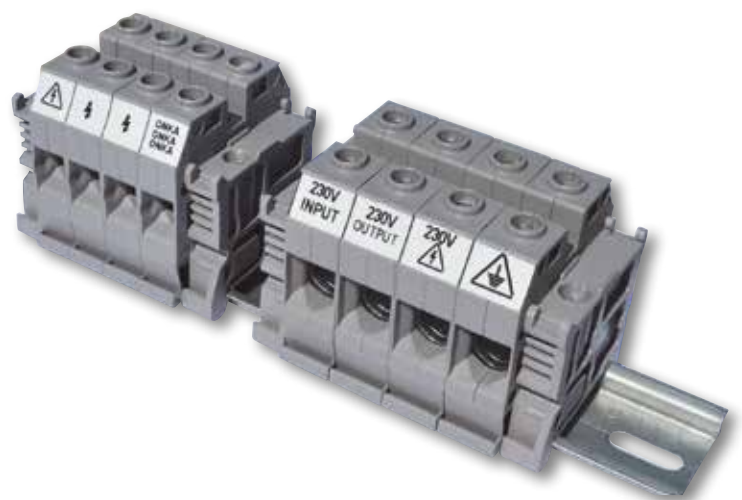

HRK HYBRID TERMINAL BLOCKS

**HRK 2,5**

New Code: 1040002
Old Code: 0362

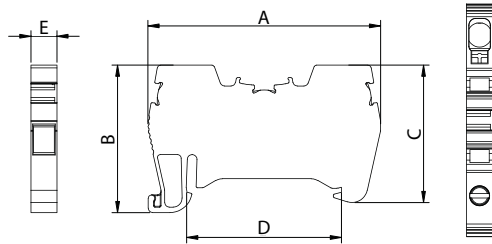
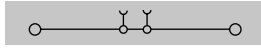

* MONOBLOCK *

Dimension (mm)	A	B	C	D	E
	52	33	30,75	34,5	5,8

MATERIAL

Body	PA6.6	Spring	Stainless Steel
Bridge	Copper	Temp.	-40 °C, +140 °C
Contact	CK45 Steel	Cable Strip L.	10 mm
Screw	Steel	Torque	0,4 Nm

DATA	TSE / CE
Voltage	750 V
Current	24 A
Section	2,5 mm ²
Norm	EN-60947-7-1

COLOURS

COLOUR	V2	V2	V0	V0	Pcs.
	New Code	Old Code	New Code	Old Code	
GREY	1040002	0362	1040022	0332	100
CREAM	1040003		1040023		100
BLACK	1040004		1040024		100
BLUE	1040005		1040025		100
BROWN	1040006		1040026		100
RED	1040007		1040027		100
YELLOW	1040008		1040028		100
GREEN	1040009		1040029		100

ACCESSORIES

Cross Connection	New Code	Old Code	Section	Pcs.	See Page
	1060106	1925	2,5 / 2	100	Pg.40
	1060107	1926	2,5 / 3	100	
	1060108	1927	2,5 / 4	75	
	1060109	1928	2,5 / 10	30	
	1060110	1929	2,5 / 20	20	
Stopper	1060002	1202		100	Pg. 37-39
	1060005	1212		100	
	1060014	1222		100	
Group Sticker	1060024	1232		100	

MARKING

	New Code	Old Code	See Page
Dekafix	1060192	4440	Pg. 181 - 185
	1060194	4442	
	-	9540	
	-	9770	
Roll Label	-	8943-S11	Pg. 176

**HRK 6**

New Code 1040012
Old Code 0372

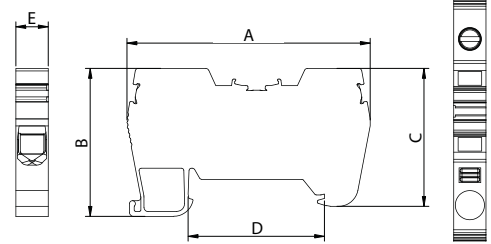

* MONOBLOCK *

Dimension (mm)	A	B	C	D	E
	61,8	37,6	35	34,5	8,2

MATERIAL

Body	PA6.6	Spring	Stainless Steel
Bridge	Copper	Temp.	-40 °C, +140 °C
Contact	CK45 Steel	Cable Strip L.	10 mm
Screw	Steel	Torque	0,4 Nm

DATA	TSE / CE
Voltage	750 V
Current	41 A
Section	6 mm ²
Norm	EN-60947-7-1

COLOURS

COLOUR	V2	V2	V0	V0	Pcs.
	New Code	Old Code	New Code	Old Code	
GREY	1040012	0372	1040032	0342	100
CREAM	1040013		1040033		100
BLACK	1040014		1040034		100
BLUE	1040015		1040035		100
BROWN	1040016		1040036		100
RED	1040017		1040037		100
YELLOW	1040018		1040038		100
GREEN	1040019		1040039		100

ACCESSORIES

Cross Connection	New Code	Old Code	Section	Pcs.	See Page
	1060116	1935	6 / 2	100	Pg. 40
	1060117	1936	6 / 3	50	
	1060118	1937	6 / 4	50	
	1060119	1938	6 / 10	15	
	1060120	1939	6 / 20	10	
Stopper	1060002	1202		100	Pg. 37-39
	1060005	1212		100	
	1060014	1222		100	
Group Sticker	1060024	1232		100	

MARKING

	New Code	Old Code	See Page
Dekafix	1060188	2630	Pg. 181 - 185
	1060194	4442	
	-	9540	
	-	9770	
Roll Label	-	8943-S11	Pg. 176

MRK SLIM SERIES SCREW CONNECTION RAIL TERMINAL BLOCKS

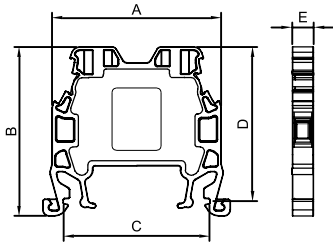
MRK SLIM 2,5
 New Code: 1010132
 Old Code: 0902

* MONOBLOCK *

Dimension (mm)	A	B	C	D	E
	40	40	34,5	36,5	5,1

MATERIAL

Body	PA6.6	Temp.	-40 °C, +140 °C
Bridge	Copper	Cable Strip L.	10 mm
Contact	CK45 Steel	Torque	0,4 Nm
Screw	Steel		

DATA	TSE / CE
Voltage	750 V
Current	24 A
Section	2,5 mm ²
Norm	EN-60947-7-1

COLOURS

COLOUR	V2	V2	V0	V0	Pcs.
	New Code	Old Code	New Code	Old Code	
GREY	1010132	0902	1010207	0862	100
CREAM	1010133	0903			100
BLACK	1010134	0904			100
BLUE	1010135	0905			100
BROWN	1010136	0906			100
RED	1010137	0907			100
YELLOW	1010138	0908			100
GREEN	1010139	0909			100

ACCESSORIES

Cross Connection	New Code	Old Code	Section	Pcs.	See Page
	1060101	1920	2,5 / 2	100	Pg. 40
	1060102	1921	2,5 / 3	100	
	1060103	1922	2,5 / 4	100	
	1060104	1923	2,5 / 10	30	
	1060105	1924	2,5 / 20	20	
Stopper	1060002	1202		100	Pg. 37-39
	1060005	1212		100	
	1060014	1222		100	
Group Sticker	1060024	1232		100	

MARKING

	New Code	Old Code	See Page
Dekafix	1060198	5443	Pg. 181 - 185
	1060194	4442	
	-	9540	
	-	9770	
Roll Label	-	8943-S11	Pg. 176

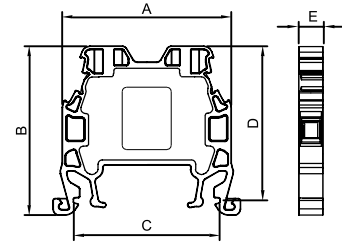
MRK SLIM 4
 New Code: 1010142
 Old Code: 0912

* MONOBLOCK *

Dimension (mm)	A	B	C	D	E
	40	40	34,5	36,5	5,9

MATERIAL

Body	PA6.6	Temp.	-40 °C, +140 °C
Bridge	Copper	Cable Strip L.	10 mm
Contact	CK45 Steel	Torque	0,4 Nm
Screw	Steel		

DATA	TSE / CE
Voltage	750 V
Current	32 A
Section	4 mm ²
Norm	EN-60947-7-1

COLOURS

COLOUR	V2	V2	V0	V0	Pcs.
	New Code	Old Code	New Code	Old Code	
GREY	1010142	0912	1010208	0872	100
CREAM	1010143	0913			100
BLACK	1010144	0914			100
BLUE	1010145	0915			100
BROWN	1010146	0916			100
RED	1010147	0917			100
YELLOW	1010148	0918			100
GREEN	1010149	0919			100

ACCESSORIES

Cross Connection	New Code	Old Code	Section	Pcs.	See Page
	1060106	1925	4 / 2	100	Pg. 40
	1060107	1926	4 / 3	100	
	1060108	1927	4 / 4	75	
	1060109	1928	4 / 10	30	
	1060110	1929	4 / 20	20	
Stopper	1060002	1202		100	Pg. 37-39
	1060005	1212		100	
	1060014	1222		100	
Group Sticker	1060024	1232		100	

MARKING

	New Code	Old Code	See Page
Dekafix	1060192	4440	Pg. 181 - 185
	1060194	4442	
	-	9540	
	-	9770	
Roll Label	-	8943-S11	Pg. 176

MRK SERIES SCREW CONNECTION RAIL TERMINAL BLOCKS



MRK 1,5

New Code: 1010002
Old Code: 1002

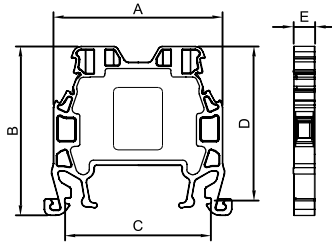

* MONOBLOCK *

Dimension (mm)	A	B	C	D	E
	40	40	34,5	36,5	5,1

MATERIAL

Body	PA6.6	Temp.	-40 °C, +140 °C
Bridge	Copper	Cable Strip L.	10 mm
Contact	CK45 Steel	Torque	0,4 Nm
Screw	Steel		

DATA	TSE / CE	UL
Voltage	750 V	300 V
Current	17,5 A	17,5 A
Section	1,5 mm ²	14 AWG
Norm	EN-60947-7-1	UL 1059

COLOURS

COLOUR	V2	V2	V0	V0	Pcs.
	New Code	Old Code	New Code	Old Code	
GREY	1010002	1002	1010151	0752	100
CREAM	1010003	1003			100
BLACK	1010004	1004			100
BLUE	1010005	1005			100
BROWN	1010006	1006			100
RED	1010007	1007			100
YELLOW	1010008	1008			100
GREEN	1010009	1009	1010152	0759	100

ACCESSORIES

Cross Connection	New Code	Old Code	Section	Pcs.	See Page
	1060101	1920	1,5 / 2	100	Pg. 40
	1060102	1921	1,5 / 3	100	
	1060103	1922	1,5 / 4	100	
	1060104	1923	1,5 / 10	30	
	1060105	1924	1,5 / 20	20	
Stopper	1060002	1202		100	Pg. 37-39
	1060005	1212		100	
	1060014	1222		100	
Group Sticker	1060024	1232		100	

MARKING

	New Code	Old Code	See Page
Dekafix	1060198	5443	Pg. 181 - 185
	1060194	4442	
	-	9540	
	-	9770	
Roll Label	-	8943-S11	Pg. 176



MRK 2,5

New Code: 1010012
Old Code: 1012

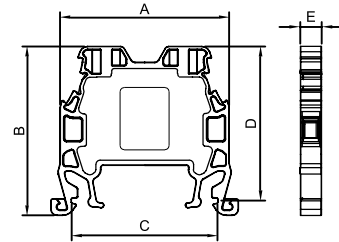

* MONOBLOCK *

Dimension (mm)	A	B	C	D	E
	40	40	34,5	36,5	5,9

MATERIAL

Body	PA6.6	Temp.	-40 °C, +140 °C
Bridge	Copper	Cable Strip L.	10 mm
Contact	CK45 Steel	Torque	0,4 Nm
Screw	Steel		

DATA	TSE / CE	UL
Voltage	750 V	300 V
Current	24 A	24 A
Section	2,5 mm ²	12 AWG
Norm	EN-60947-7-1	UL 1059

COLOURS

COLOUR	V2	V2	V0	V0	Pcs.
	New Code	Old Code	New Code	Old Code	
GREY	1010012	1012	1010153	0762	100
CREAM	1010013	1013	1010154	0763	100
BLACK	1010014	1014	1010155	0764	100
BLUE	1010015	1015	1010156	0765	100
BROWN	1010016	1016	1010157	0766	100
RED	1010017	1017	1010158	0767	100
YELLOW	1010018	1018	1010159	0768	100
GREEN	1010019	1019	1010160	0769	100

ACCESSORIES

Cross Connection	New Code	Old Code	Section	Pcs.	See Page
	1060106	1925	2,5 / 2	100	Pg. 40
	1060107	1926	2,5 / 3	100	
	1060108	1927	2,5 / 4	75	
	1060109	1928	2,5 / 10	30	
	1060110	1929	2,5 / 20	20	
Stopper	1060002	1202		100	Pg. 37-39
	1060005	1212		100	
	1060014	1222		100	
Group Sticker	1060024	1232		100	

MARKING

	New Code	Old Code	See Page
Dekafix	1060192	4440	Pg. 181 - 185
	1060194	4442	
	-	9540	
	-	9770	
Roll Label	-	8943-S11	Pg. 176

MRK SERIES SCREW CONNECTION RAIL TERMINAL BLOCKS

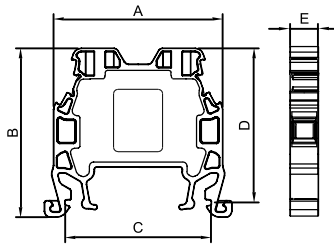
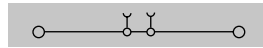
MRK 4
 New Code: 1010022
 Old Code: 1022

* MONOBLOCK *

Dimension (mm)	A	B	C	D	E
	40	40	34,5	36,5	6,7

MATERIAL

Body	PA6.6	Temp.	-40 °C, +140 °C
Bridge	Copper	Cable Strip L.	10 mm
Contact	CK45 Steel	Torque	0,5 Nm
Screw	Steel		

DATA	TSE / CE	UL
Voltage	750 V	300 V
Current	32 A	32 A
Section	4 mm ²	10 AWG
Norm	EN-60947-7-1	UL 1059

COLOURS

COLOUR	V2	V2	V0	V0	Pcs.
	New Code	Old Code	New Code	Old Code	
GREY	1010022	1022	1010162	0772	100
CREAM	1010023	1023	1010163	0773	100
BLACK	1010024	1024	1010164	0774	100
BLUE	1010025	1025	1010165	0775	100
BROWN	1010026	1026	1010166	0776	100
RED	1010027	1027	1010167	0777	100
YELLOW	1010028	1028			100
GREEN	1010029	1029			100

ACCESSORIES

Cross Connection	New Code	Old Code	Section	Pcs.	See Page
	1060111	1930	4 / 2	100	Pg. 40
	1060112	1931	4 / 3	100	
	1060113	1932	4 / 4	50	
	1060114	1933	4 / 10	30	
	1060115	1934	4 / 20	20	
Stopper	1060002	1202		100	Pg. 37-39
	1060005	1212		100	
	1060014	1222		100	
Group Sticker	1060024	1232		100	

MARKING

	New Code	Old Code	See Page
Dekafix	1060190	4390	Pg. 181 - 185
	1060194	4442	
	-	9540	
	-	9770	
Roll Label	-	8943-S11	Pg. 176

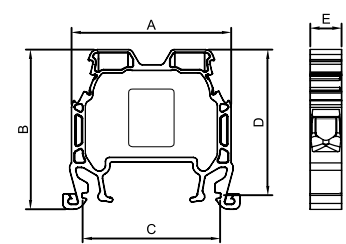
MRK 6
 New Code: 1010032
 Old Code: 1032

* MONOBLOCK *

Dimension (mm)	A	B	C	D	E
	40	40	34,5	36,5	8,2

MATERIAL

Body	PA6.6	Temp.	-40 °C, +140 °C
Bridge	Copper	Cable Strip L.	12 mm
Contact	CK45 Steel	Torque	0,8 Nm
Screw	Steel		

DATA	TSE / CE	UL
Voltage	750 V	300 V
Current	41 A	41 A
Section	6 mm ²	8 AWG
Norm	EN-60947-7-1	UL 1059

COLOURS

COLOUR	V2	V2	V0	V0	Pcs.
	New Code	Old Code	New Code	Old Code	
GREY	1010032	1032	1010168	0782	100
CREAM	1010033	1033	1010169	0783	100
BLACK	1010034	1034	1010170	0784	100
BLUE	1010035	1035	1010171	0785	100
BROWN	1010036	1036	1010172	0786	100
RED	1010037	1037	1010173	0787	100
YELLOW	1010038	1038			100
GREEN	1010039	1039			100

ACCESSORIES

Cross Connection	New Code	Old Code	Section	Pcs.	See Page
	1060116	1935	6 / 2	100	Pg. 40
	1060117	1936	6 / 3	50	
	1060118	1937	6 / 4	50	
	1060119	1938	6 / 10	15	
	1060120	1939	6 / 20	10	
Stopper	1060002	1202		100	Pg. 37-39
	1060005	1212		100	
	1060014	1222		100	
Group Sticker	1060024	1232		100	

MARKING

	New Code	Old Code	See Page
Dekafix	1060188	2630	Pg. 181 - 185
	1060194	4442	
	-	9540	
	-	9770	
Roll Label	-	8943-S11	Pg. 176

MRK SERIES SCREW CONNECTION RAIL TERMINAL BLOCKS



MRK 10
New Code: 1010042
Old Code: 1042

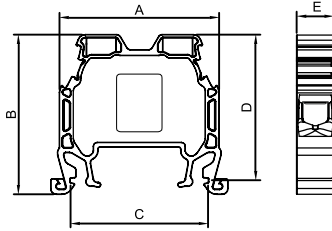

* MONOBLOCK *

Dimension (mm)	A	B	C	D	E
	40	40	34,5	36,5	9,5

MATERIAL			
Body	PA6.6	Temp.	-40 °C, +140 °C
Bridge	Copper	Cable Strip L.	12 mm
Contact	CK45 Steel	Torque	0,8 Nm
Screw	Steel		

DATA	TSE / CE	UL
Voltage	750 V	600 V
Current	57 A	57 A
Section	10 mm ²	8 AWG
Norm	EN-60947-7-1	UL 1059

COLOURS					
	V2	V2	V0	V0	
COLOUR	New Code	Old Code	New Code	Old Code	Pcs.
GREY	1010042	1042	1010174	0792	100
CREAM	1010043	1043	1010175	0793	100
BLACK	1010044	1044	1010176	0794	100
BLUE	1010045	1045	1010177	0795	100
BROWN	1010046	1046	1010178	0796	100
RED	1010047	1047	1010179	0797	100
YELLOW	1010048	1048			100
GREEN	1010049	1049			100

ACCESSORIES					
Cross Connection	New Code	Old Code	Section	Pcs.	See Page
	1060121	1940	10 / 2	100	Pg. 40
	1060122	1941	10 / 3	50	
	1060123	1942	10 / 4	50	
	1060124	1943	10 / 10	15	
	1060125	1944	10 / 20	10	
Stopper	1060002	1202		100	Pg. 37-39
	1060005	1212		100	
	1060014	1222		100	
Group Sticker	1060024	1232		100	

MARKING			
	New Code	Old Code	See Page
Dekafix	1060188	2630	Pg. 181 - 185
	1060194	4442	
	-	9540	
	-	9770	
Roll Label	-	8943-S11	Pg. 176



MRK 16
New Code: 1010052
Old Code: 1132

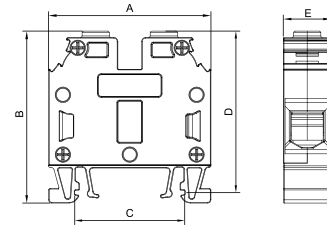

Dimension (mm)	A	B	C	D	E
	51	54	34,5	51	12

MATERIAL			
Body	PA6.6	Temp.	-40 °C, +140 °C
Bridge	Copper	Cable Strip L.	18 mm
Contact	CK45 Steel	Torque	2,0 Nm
Screw	Steel		

DATA	TSE / CE	UL
Voltage	750 V	600 V
Current	76 A	63 A
Section	16 mm ²	6 AWG
Norm	EN-60947-7-1	UL 1059

COLOURS					
	V2	V2	V0	V0	
COLOUR	New Code	Old Code	New Code	Old Code	Pcs.
GREY	1010052	1132	1010209	0882	50
CREAM	1010053	1133		0883	50
BLACK	1010054	1134		0884	50
BLUE	1010055	1135		0885	50
BROWN	1010056	1136		0886	50
RED	1010057	1137		0887	50
YELLOW	1010058	1138			50
GREEN	1010059	1139			50

ACCESSORIES					
Cross Connection	New Code	Old Code	Section	Pcs.	See Page
	1060152	2257	16 / 2	10	Pg. 40
	1060153	2258	16 / 3	10	
	1060154	2259	16 / 4	10	
	1060155	2260	16 / 5	10	
	1060160	2265	16 / 10	10	
Stopper	1060002	1202		100	Pg. 37-39
	1060005	1212		100	
	1060014	1222		100	
Group Sticker	1060024	1232		100	

MARKING			
	New Code	Old Code	See Page
Dekafix	1060188	2630	Pg. 181 - 185
	1060194	4442	
	-	9540	
	-	9770	
Roll Label	-	8943-S11	Pg. 176



MRK SERIES SCREW CONNECTION RAIL TERMINAL BLOCKS



MRK 25
New Code: 1010062
Old Code: 0302

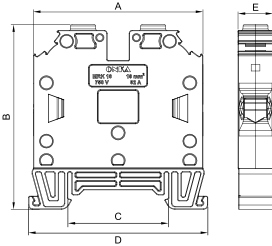
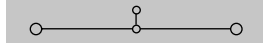

With Non - Insulated Cord End Terminals

Dimension (mm)	A	B	C	D	E
	58	63,2	34,5	61,2	12

MATERIAL

Body	PA6.6	Temp.	-40 °C, +140 °C
Bridge	Copper	Cable Strip L.	18 mm
Contact	CK45 Steel	Torque	2,0 Nm
Screw	Steel		

DATA	TSE / CE
Voltage	750 V
Current	101 A
Section	25 mm ²
Norm	EN-60947-7-1

COLOURS

COLOUR	V2		V0		Pcs.
	New Code	Old Code	New Code	Old Code	
GREY	1010062	0302	1010180	0802	50
CREAM	1010063	0303	1010181		50
BLACK	1010064	0304	1010182		50
BLUE	1010065	0305	1010183		50
BROWN	1010066	0306	1010184		50
RED	1010067	0307	1010185		50
YELLOW	1010068	0308			50
GREEN	1010069	0309			50

ACCESSORIES

Cross Connection	New Code	Old Code	Section	Pcs.	See Page
	1060152	2257	16 / 2	10	Pg. 40
	1060153	2258	16 / 3	10	
	1060154	2259	16 / 4	10	
	1060155	2260	16 / 5	10	
	1060160	2265	16 / 10	10	
Stopper	1060002	1202		100	Pg. 37-39
	1060005	1212		100	
	1060014	1222		100	
Group Sticker	1060024	1232		100	

MARKING

	New Code	Old Code	See Page
Dekafix	1060188	2630	Pg. 181 - 185
	1060194	4442	
	-	9540	
	-	9770	
Roll Label	-	8943-S11	Pg. 176



MRK 35 (HIGH)
New Code: 1010082
Old Code: 1062

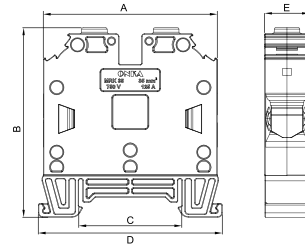
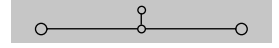

Dimension (mm)	A	B	C	D	E
	58	63,2	34,5	61,2	15

MATERIAL

Body	PA6.6	Temp.	-40 °C, +140 °C
Bridge	Copper	Cable Strip L.	18 mm
Contact	CK45 Steel	Torque	2,0 Nm
Screw	Steel		

DATA	TSE / CE
Voltage	750 V
Current	125 A
Section	35 mm ²
Norm	EN-60947-7-1

COLOURS

COLOUR	V2		V0		Pcs.
	New Code	Old Code	New Code	Old Code	
GREY	1010082	1062	1010186	0812	30
CREAM	1010083	1063	1010187	0813	30
BLACK	1010084	1064	1010188	0814	30
BLUE	1010085	1065	1010189	0815	30
BROWN	1010086	1066	1010190	0816	30
RED	1010087	1067	1010191	0817	30
YELLOW	1010088	1068	1010192	0818	30
GREEN	1010089	1069	1010193	0819	30

ACCESSORIES

Cross Connection	New Code	Old Code	Section	Pcs.	See Page
	1060161	2266	35 / 2	10	Pg. 40
	1060162	2267	35 / 3	10	
	1060163	2268	35 / 4	10	
	1060164	2269	35 / 5	10	
	1060169	2274	35 / 10	10	
Stopper	1060002	1202		100	Pg. 37-39
	1060005	1212		100	
	1060014	1222		100	
Group Sticker	1060024	1232		100	

MARKING

	New Code	Old Code	See Page
Dekafix	1060188	2630	Pg. 181 - 185
	1060194	4442	
	-	9540	
	-	9770	
Roll Label	-	8943-S11	Pg. 176

MRK SERIES SCREW CONNECTION RAIL TERMINAL BLOCKS

**MRK 35 (NEW)**

Medium Size

New Code: 1010072

Old Code: 1142

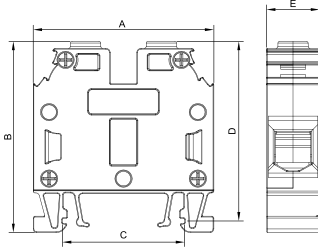
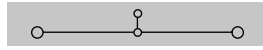

Dimension (mm)	A	B	C	D	E
	50,7	54	34,5	51	15

MATERIAL

Body	PA6.6	Temp.	-40 °C, +140 °C
Bridge	Copper	Cable Strip L.	18 mm
Contact	CK45 Steel	Torque	2,0 Nm
Screw	Steel		

DATA	TSE / CE
Voltage	750 V
Current	125 A
Section	35 mm ²
Norm	EN-60947-7-1

COLOURS

COLOUR	V2	V2	V0	V0	Pcs.
	New Code	Old Code	New Code	Old Code	
GREY	1010072	1142	1010210	0892	30
CREAM	1010073	1143			30
BLACK	1010074	1144			30
BLUE	1010075	1145			30
BROWN	1010076	1146			30
RED	1010077	1147			30
YELLOW	1010078	1148			30
GREEN	1010079	1149			30

ACCESSORIES

Cross Connection	New Code	Old Code	Section	Pcs.	See Page
	1060161	2266	35 / 2	10	Pg. 40
	1060162	2267	35 / 3	10	
	1060163	2268	35 / 4	10	
	1060164	2269	35 / 5	10	
Stopper	1060169	2274	35 / 10	10	Pg. 37-39
	1060002	1202		100	
	1060005	1212		100	
Group Sticker	1060014	1222		100	
	1060024	1232		100	

MARKING

	New Code	Old Code	See Page
Dekafix	1060188	2630	Pg. 181 - 185
	1060194	4442	
	-	9540	
	-	9770	
Roll Label	-	8943-S11	Pg. 176

**MRK 50**

New Code: 1010092

Old Code: 1072

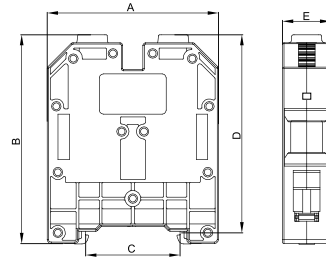
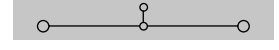

Dimension (mm)	A	B	C	D	E
	64	78	34,5	74	18

MATERIAL

Body	PA6.6	Temp.	-40 °C, +140 °C
Bridge	Copper	Cable Strip L.	18 mm
Contact	DKP	Torque	6,0 Nm
Screw	Steel		

DATA	TSE / CE	UL
Voltage	750 V	600 V
Current	150 A	100 A
Section	50 mm ²	AWG 1/0 str
Norm	EN-60947-7-1	UL 1059

COLOURS

COLOUR	V2	V2	V0	V0	Pcs.
	New Code	Old Code	New Code	Old Code	
GREY	1010092	1072	1010194	0822	20
CREAM	1010093	1073	1010195	0823	20
BLACK	1010094	1074	1010196	0824	20
BLUE	1010095	1075	1010197	0825	20
BROWN	1010096	1076	1010198	0826	20
RED	1010097	1077	1010199	0827	20
YELLOW	1010098	1078	1010200	0828	20
GREEN	1010099	1079	1010201	0829	20

ACCESSORIES

	New Code	Old Code	See Page
Stopper	1060002	1202	Pg. 37-39
	1060005	1212	
	1060014	1222	
Group Sticker	1060024	1232	

MARKING

	New Code	Old Code	See Page
Dekafix	1060194	4442	Pg. 181 - 185
	-	9540	
	-	9770	
	-	9770	



MRK SERIES SCREW CONNECTION RAIL TERMINAL BLOCKS



MRK 70

New Code: 1010102
Old Code: 1082

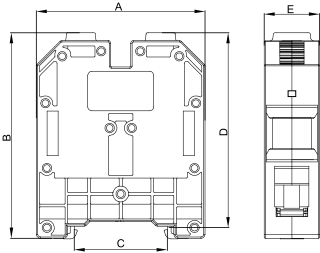
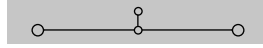

Dimension (mm)	A	B	C	D	E
	64	78	34,5	74	21

MATERIAL

Body	PA6.6	Temp.	-40 °C, +140 °C
Bridge	Copper	Cable Strip L.	20 mm
Contact	DKP	Torque	6,0 Nm
Screw	Steel		

DATA	TSE / CE	UL
Voltage	750 V	600 V
Current	192 A	125 A
Section	70 mm ²	AWG 2/O str
Norm	EN-60947-7-1	UL 1059

COLOURS

COLOUR	V2	V2	V0	V0	Pcs.
	New Code	Old Code	New Code	Old Code	
GREY	1010102	1082	1010202	0832	20
CREAM	1010103	1083			20
BLACK	1010104	1084			20
BLUE	1010105	1085	1010203	0835	20
BROWN	1010106	1086			20
RED	1010107	1087			20
YELLOW	1010108	1088			20
GREEN	1010109	1089			20

ACCESSORIES

	New Code	Old Code	See Page
Stopper	1060002	1202	Pg. 37-39
	1060005	1212	
	1060014	1222	
Group Sticker	1060024	1232	

MARKING

	New Code	Old Code	See Page
Dekafix	1060194	4442	Pg. 181 - 185
	-	9540	
	-	9770	



MRK 95

New Code: 1010112
Old Code: 1092

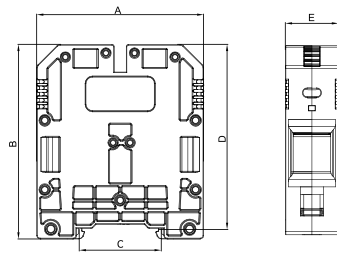
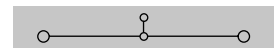

Dimension (mm)	A	B	C	D	E
	75	88	34,5	83	23,8

MATERIAL

Body	PA6.6	Temp.	-40 °C, +140 °C
Bridge	Copper	Cable Strip L.	20 mm
Contact	DKP	Torque	6,0 Nm
Screw	Steel		

DATA	TSE / CE
Voltage	1000 V
Current	232 A
Section	95 mm ²
Norm	EN-60947-7-1

COLOURS

COLOUR	V2	V2	V0	V0	Pcs.
	New Code	Old Code	New Code	Old Code	
GREY	1010112	1092	1010204	0842	10
CREAM	1010113	1093			10
BLACK	1010114	1094			10
BLUE	1010115	1095	1010205	0845	10
BROWN	1010116	1096			10
RED	1010117	1097			10
YELLOW	1010118	1098			10
GREEN	1010119	1099			10

ACCESSORIES

	New Code	Old Code	See Page
Stopper	1060002	1202	Pg. 37-39
	1060005	1212	
	1060014	1222	
Group Sticker	1060024	1232	

MARKING

	New Code	Old Code	See Page
Dekafix	1060194	4442	Pg. 181 - 185
	-	9540	
	-	9770	

MRK SERIES SCREW CONNECTION RAIL TERMINAL BLOCKS



MRK 120
New Code: 1010122
Old Code: 1102

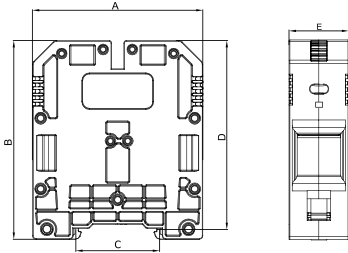
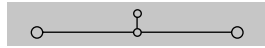

Dimension (mm)	A	B	C	D	E
	75	88	34,5	83	26

MATERIAL

Body	PA6.6	Temp.	-40 °C, +140 °C
Bridge	Copper	Cable Strip L.	20 mm
Contact	DKP	Torque	6,0 Nm
Screw	Steel		

DATA	TSE / CE
Voltage	1000 V
Current	269 A
Section	120 mm ²
Norm	EN-60947-7-1

COLOURS

COLOUR	V2	V2	V0	V0	Pcs.
	New Code	Old Code	New Code	Old Code	
GREY	1010122	1102	1010206	0852	10
CREAM	1010123	1103			10
BLACK	1010124	1104			10
BLUE	1010125	1105			10
BROWN	1010126	1106			10
RED	1010127	1107			10
YELLOW	1010128	1108			10
GREEN	1010129	1109			10

ACCESSORIES

	New Code	Old Code	See Page
Stopper	1060002	1202	Pg. 37-39
	1060005	1212	
	1060014	1222	
Group Sticker	1060024	1232	

MARKING

	New Code	Old Code	See Page
Dekafix	1060194	4442	Pg. 181 - 185
	-	9540	
	-	9770	

MRK SERIES TRANSFER CONNECTORS



MRK
New Code: 1060068
Old Code: 1175



MRK
New Code: 1060056
Old Code: 1162

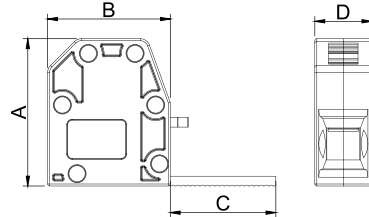

Dimension (mm)	New Code	Code	A	B	C	D
	1060056	1162	30	25	18	11,5
	1060065	1175	30	25	23	11,5

MATERIAL

Body	PA6.6	Temp.	-40 °C, +140 °C
Bridge	Copper	Cable Strip L.	18 mm
Contact	CK45 Steel	Torque	2,0 Nm
Screw	Steel		

DATA	TSE / CE
Voltage	750 V
Current	76 A
Section	16 mm ²
Norm	EN-60947-7-1

COLOURS

COLOUR	35 - 50 mm ²		70 - 90 - 120 mm ²		Pcs.
	New Code	Old Code	New Code	Old Code	
GREY	1060056	1162	1060065	1172	100
CREAM	1060057	1163	1060066	1173	100
BLACK	1060058	1164	1060067	1174	100
BLUE	1060059	1165	1060068	1175	100
BROWN	1060060	1166	1060069	1176	100
RED	1060061	1167	1060070	1177	100
YELLOW	1060062	1168	1060071	1178	100
GREEN	1060063	1169	1060072	1179	100

MARKING

	New Code	Old Code	See Page
Dekafix	1060194	4442	Pg. 181 - 185
	-	9540	
	-	9770	



MRK SERIES DOUBLE LEVEL SCREW CONNECTION RAIL TERMINAL BLOCKS



MRK-C 2,5

New Code: 1010332
Old Code: 1612

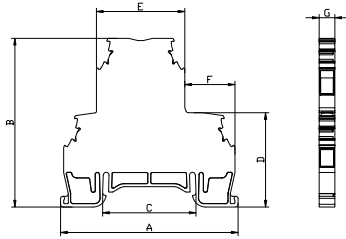
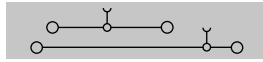

* MONOBLOCK *

Dimension (mm)	A	B	C	D	E	F	G
	66,3	63	34,5	35,2	33	18,75	5,8

MATERIAL

Body	PA6.6	Temp.	-40 °C, +140 °C
Bridge	Copper	Cable Strip L.	9 mm
Contact	CK45 Steel	Torque	0,4 Nm
Screw	Steel		

DATA	TSE / CE	UL
Voltage	750 V	600 V
Current	24 A	24A
Section	2,5 mm ²	12 AWG
Norm	EN-60947-7-1	UL 1059

COLOURS

COLOUR	V2		V0		Pcs.
	New Code	Old Code	New Code	Old Code	
GREY	1010332	1612	1010411	0732	50
CREAM	1010333	1613			50
BLACK	1010334	1614			50
BLUE	1010335	1615			50
BROWN	1010336	1616			50
RED	1010337	1617			50
YELLOW	1010338	1618			50
GREEN	1010339	1619			50

ACCESSORIES

Cross Connection	New Code	Old Code	Section	Pcs.	See Page
	1060106	1925	2,5 / 2	100	Pg. 40
	1060107	1926	2,5 / 3	100	
	1060108	1927	2,5 / 4	75	
	1060109	1928	2,5 / 10	30	
	1060110	1929	2,5 / 20	20	
Stopper	1060002	1202		100	Pg. 37-39
	1060005	1212		100	
	1060014	1222		100	
Group Sticker	1060024	1232		100	

MARKING

	New Code	Old Code	See Page
Dekafix	1060192	4440	Pg. 181 - 185
	1060194	4442	
	-	9540	
	-	9770	
Roll Label	-	8943-S11	Pg. 176



MRK-C 4

New Code: 1010368
Old Code: 1652

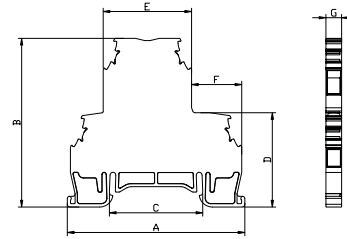
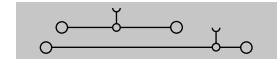

* MONOBLOCK *

Dimension (mm)	A	B	C	D	E	F	G
	66,3	63	34,5	35,2	33	18,75	6,6

MATERIAL

Body	PA6.6	Temp.	-40 °C, +140 °C
Bridge	Copper	Cable Strip L.	9 mm
Contact	CK45 Steel	Torque	0,5 Nm
Screw	Steel		

DATA	TSE / CE	UL
Voltage	750 V	600 V
Current	32 A	32
Section	4 mm ²	10 AWG
Norm	EN-60947-7-1	UL 1059

COLOURS

COLOUR	V2		V0		Pcs.
	New Code	Old Code	New Code	Old Code	
GREY	1010368	1652	1010410	0722	50
CREAM	1010369	1653			50
BLACK	1010370	1654			50
BLUE	1010371	1655			50
BROWN	1010372	1656			50
RED	1010373	1657			50
YELLOW	1010374	1658			50
GREEN	1010375	1659			50

ACCESSORIES

Cross Connection	New Code	Old Code	Section	Pcs.	See Page
	1060111	1930	4 / 2	100	Pg. 40
	1060112	1931	4 / 3	100	
	1060113	1932	4 / 4	50	
	1060114	1933	4 / 10	30	
	1060115	1934	4 / 20	20	
Stopper	1060002	1202		100	Pg. 37-39
	1060005	1212		100	
	1060014	1222		100	
Group Sticker	1060024	1232		100	

MARKING

	New Code	Old Code	See Page
Dekafix	1060190	4390	Pg. 181 - 185
	1060194	4442	
	-	9540	
	-	9770	
Roll Label	-	8943-S11	Pg. 176

MRK SERIES DOUBLE LEVEL SCREW CONNECTION BRIDGED RAIL TERMINAL BLOCKS



MRK-C2,5
New Code: 1010341
Old Code: 1622
Bridged

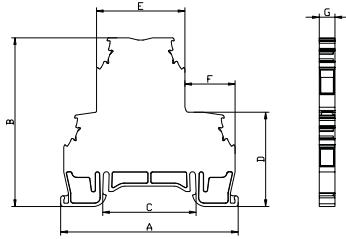
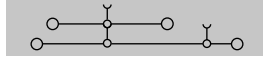

* MONOBLOCK *

Dimension (mm)	A	B	C	D	E	F	G
	66,3	63	34,5	35,2	33	18,75	5,8

MATERIAL

Body	PA6.6	Temp.	-40 °C, +140 °C
Bridge	Copper	Cable Strip L.	9 mm
Contact	CK45 Steel	Torque	0,4 Nm
Screw	Steel		

DATA	TSE / CE	UL
Voltage	750 V	600 V
Current	24 A	24 A
Section	2,5 mm ²	12 AWG
Norm	EN-60947-7-1	UL 1059

COLOURS

COLOUR	V2	V2	V0	V0	Pcs.
	New Code	Old Code	New Code	Old Code	
GREY	1010341	1622	1010407	0482	50
CREAM	1010342	1623			50
BLACK	1010343	1624			50
BLUE	1010344	1625			50
BROWN	1010345	1626			50
RED	1010346	1627			50
YELLOW	1010347	1628			50
GREEN	1010348	1629			50

ACCESSORIES

Cross Connection	New Code	Old Code	Section	Pcs.	See Page
	1060106	1925	2,5 / 2	100	Pg. 40
	1060107	1926	2,5 / 3	100	
	1060108	1927	2,5 / 4	75	
	1060109	1928	2,5 / 10	30	
	1060110	1929	2,5 / 20	20	
Stopper	1060002	1202		100	Pg. 37-39
	1060005	1212		100	
	1060014	1222		100	
Group Sticker	1060024	1232		100	

MARKING

	New Code	Old Code	See Page
Dekafix	1060192	4440	Pg. 181 - 185
	1060194	4442	
	-	9540	
	-	9770	
Roll Label	-	8943-S11	Pg. 176



MRK-C4
New Code: 1010377
Old Code: 1662
Bridged

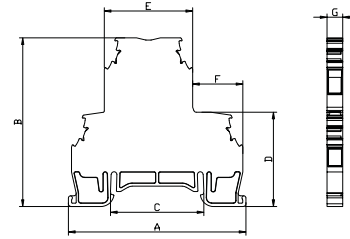
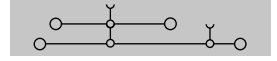

* MONOBLOCK *

Dimension (mm)	A	B	C	D	E	F	G
	66,3	63	34,5	35,2	33	18,75	6,6

MATERIAL

Body	PA6.6	Temp.	-40 °C, +140 °C
Bridge	Copper	Cable Strip L.	9 mm
Contact	CK45 Steel	Torque	0,5 Nm
Screw	Steel		

DATA	TSE / CE	UL
Voltage	750 V	600 V
Current	32 A	32 A
Section	4 mm ²	10 AWG
Norm	EN-60947-7-1	UL 1059

COLOURS

COLOUR	V2	V2	V0	V0	Pcs.
	New Code	Old Code	New Code	Old Code	
GREY	1010377	1662	1010408	0492	50
CREAM	1010378	1663			50
BLACK	1010379	1664			50
BLUE	1010380	1665			50
BROWN	1010381	1666			50
RED	1010382	1667			50
YELLOW	1010383	1668			50
GREEN	1010384	1669			50

ACCESSORIES

Cross Connection	New Code	Old Code	Section	Pcs.	See Page
	1060111	1930	4 / 2	100	Pg. 40
	1060112	1931	4 / 3	100	
	1060113	1932	4 / 4	50	
	1060114	1933	4 / 10	30	
	1060115	1934	4 / 20	20	
Stopper	1060002	1202		100	Pg. 37-39
	1060005	1212		100	
	1060014	1222		100	
Group Sticker	1060024	1232		100	

MARKING

	New Code	Old Code	See Page
Dekafix	1060190	4390	Pg. 181 - 185
	1060194	4442	
	-	9540	
	-	9770	
Roll Label	-	8943-S11	Pg. 176



MRK SERIES DOUBLE LEVEL SCREW CONNECTION RAIL TERMINAL BLOCKS (WITH DIODE)



MRK-C 2,5

New Code: 1010350

Old Code: 1632

Diode

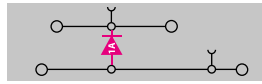

Please Specify The Diode Direction!

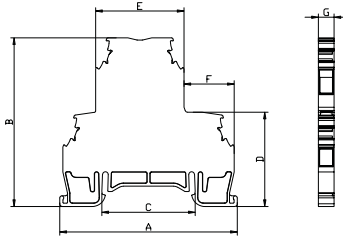

MONOBLOCK

Dimension (mm)	A	B	C	D	E	F	G
	66,3	63	34,5	35,2	33	18,75	5,8

MATERIAL

Body	PA6.6	Temp.	-40 °C, +140 °C
Bridge	Copper	Cable Strip L.	9 mm
Contact	CK45 Steel	Torque	0,4 Nm
Screw	Steel		

DATA	TSE / CE	UL
Voltage	750 V	600 V
Current		
Section	2,5 mm ²	12 AWG
Norm	EN-60947-7-1	UL 1059

COLOURS

COLOUR	V2		V0		Pcs.
	New Code	Old Code	New Code	Old Code	
GREY	1010350	1632	1010406	0402	50
CREAM	1010351	1633			50
BLACK	1010352	1634			50
BLUE	1010353	1635			50
BROWN	1010354	1636			50
RED	1010355	1637			50
YELLOW	1010356	1638			50
GREEN	1010357	1639			50

ACCESSORIES

Cross Connection	New Code	Old Code	Section	Pcs.	See Page
	1060106	1925	2,5 / 2	100	Pg. 40
	1060107	1926	2,5 / 3	100	
	1060108	1927	2,5 / 4	75	
	1060109	1928	2,5 / 10	30	
	1060110	1929	2,5 / 20	20	
Stopper	1060002	1202		100	Pg. 37-39
	1060005	1212		100	
	1060014	1222		100	
Group Sticker	1060024	1232		100	

MARKING

	New Code	Old Code	See Page
Dekafix	1060192	4440	Pg. 181 - 185
	1060194	4442	
	-	9540	
	-	9770	
Roll Label	-	8943-S11	Pg. 176



MRK-C 4

New Code: 1010386

Old Code: 1672

Diode

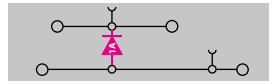

Please Specify The Diode Direction!

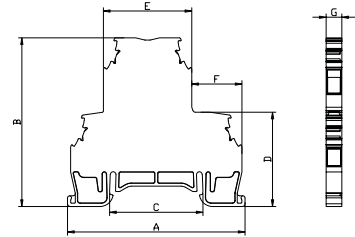

MONOBLOCK

Dimension (mm)	A	B	C	D	E	F	G
	66,3	63	34,5	35,2	33	18,75	6,6

MATERIAL

Body	PA6.6	Temp.	-40 °C, +140 °C
Bridge	Copper	Cable Strip L.	9 mm
Contact	CK45 Steel	Torque	0,5 Nm
Screw	Steel		

DATA	TSE / CE	UL
Voltage	750 V	600 V
Current		
Section	4 mm ²	10 AWG
Norm	EN-60947-7-1	UL 1059

COLOURS

COLOUR	V2		V0		Pcs.
	New Code	Old Code	New Code	Old Code	
GREY	1010386	1672	1010405	0392	50
CREAM	1010387	1673			50
BLACK	1010388	1674			50
BLUE	1010389	1675			50
BROWN	1010390	1676			50
RED	1010391	1677			50
YELLOW	1010392	1678			50
GREEN	1010393	1679			50

ACCESSORIES

Cross Connection	New Code	Old Code	Section	Pcs.	See Page
	1060111	1930	4 / 2	100	Pg. 40
	1060112	1931	4 / 3	100	
	1060113	1932	4 / 4	50	
	1060114	1933	4 / 10	30	
	1060115	1934	4 / 20	20	
Stopper	1060002	1202		100	Pg. 37-39
	1060005	1212		100	
	1060014	1222		100	
Group Sticker	1060024	1232		100	

MARKING

	New Code	Old Code	See Page
Dekafix	1060190	4390	Pg. 181 - 185
	1060194	4442	
	-	9540	
	-	9770	
Roll Label	-	8943-S11	Pg. 176

MRK SERIES DOUBLE LEVEL SCREW CONNECTION EARTH RAIL TERMINAL BLOCKS

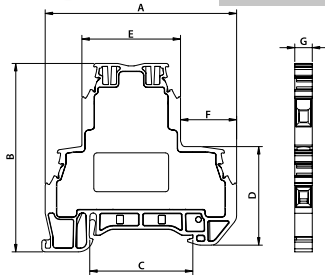
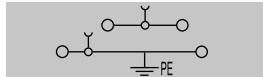
**MRK-C2,5**Code: 1010573
Earth

* MONOBLOCK *

Dimension (mm)	A	B	C	D	E	F	G
	64	63	34,50	33	33	18,80	5,85

MATERIAL

Body	PA6.6	Temp.	-40 °C, +140 °C
Bridge	Copper	Cable Strip L.	9 mm
Contact	CK45 Steel	Torque	0,4 Nm
Screw	Steel		

DATA	TSE / CE
Voltage	750 V
Current	24 A
Section	2,5 mm ²
Norm	EN-60947-7-1

COLOURS

	V2	V0	
COLOUR	Code	Code	Pcs.
GREY	1010573	1010579	50

ACCESSORIES

Cross Connection	New Code	Old Code	Section	Pcs.	See Page
	1060106	1925	2,5 / 2	100	Pg. 40
	1060107	1926	2,5 / 3	100	
	1060108	1927	2,5 / 4	75	
	1060109	1928	2,5 / 10	30	
	1060110	1929	2,5 / 20	20	
Stopper	1060002	1202		100	Pg. 37-39
	1060005	1212		100	
	1060014	1222		100	
Group Sticker	1060024	1232		100	

MARKING

	New Code	Old Code	See Page
Dekafix	1060192	4440	Pg. 181 - 185
	1060194	4442	
	-	9540	
	-	9770	
Roll Label	-	8943-S11	Pg. 176

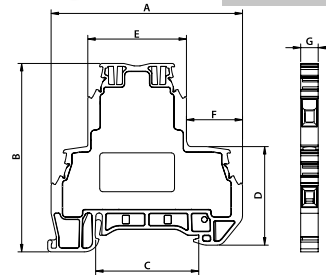
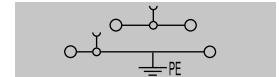
**MRK-C4**Code: 1010574
Earth

* MONOBLOCK *

Dimension (mm)	A	B	C	D	E	F	G
	64	63	34,50	33	33	18,80	6,65

MATERIAL

Body	PA6.6	Temp.	-40 °C, +140 °C
Bridge	Copper	Cable Strip L.	9 mm
Contact	CK45 Steel	Torque	0,5 Nm
Screw	Steel		

DATA	TSE / CE
Voltage	750 V
Current	32 A
Section	4 mm ²
Norm	EN-60947-7-1

COLOURS

	V2	V0	
COLOUR	Code	Code	Pcs.
GREY	1010574	1010580	50

ACCESSORIES

Cross Connection	New Code	Old Code	Section	Pcs.	See Page
	1060111	1930	4 / 2	100	Pg. 40
	1060112	1931	4 / 3	100	
	1060113	1932	4 / 4	50	
	1060114	1933	4 / 10	30	
	1060115	1934	4 / 20	20	
Stopper	1060002	1202		100	Pg. 37-39
	1060005	1212		100	
	1060014	1222		100	
Group Sticker	1060024	1232		100	

MARKING

	New Code	Old Code	See Page
Dekafix	1060190	4390	Pg. 181 - 185
	1060194	4442	
	-	9540	
	-	9770	
Roll Label	-	8943-S11	Pg. 176

MRK SERIES DOUBLE LEVEL SCREW CONNECTION BRIDGED EARTH RAIL TERMINAL BLOCKS

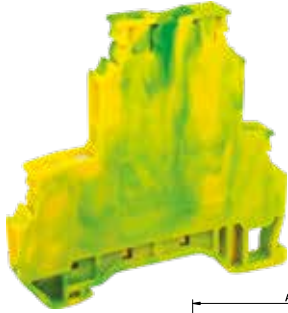
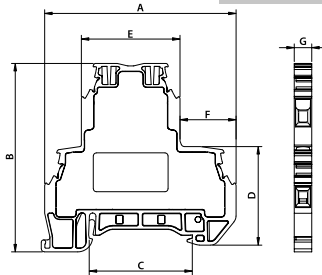
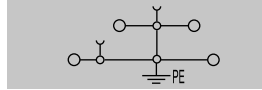
**MRK-C 2,5**Code: 1010575
Bridged - Earth

* MONOBLOCK *

Dimension (mm)	A	B	C	D	E	F	G
	64	63	34,50	33	33	18,80	5,85

MATERIAL

Body	PA6.6	Temp.	-40 °C, +140 °C
Bridge	Copper	Cable Strip L.	9 mm
Contact	CK45 Steel	Torque	0,4 Nm
Screw	Steel		

DATA	TSE / CE
Voltage	750 V
Current	24 A
Section	2,5 mm ²
Norm	EN-60947-7-1

COLOURS

	V2	V0	
COLOUR	Code	Code	Pcs.
GREY	1010575	1010581	50

ACCESSORIES

Cross Connection	New Code	Old Code	Section	Pcs.	See Page
	1060106	1925	2,5 / 2	100	Pg. 40
	1060107	1926	2,5 / 3	100	
	1060108	1927	2,5 / 4	75	
	1060109	1928	2,5 / 10	30	
	1060110	1929	2,5 / 20	20	
Stopper	1060002	1202		100	Pg. 37-39
	1060005	1212		100	
	1060014	1222		100	
Group Sticker	1060024	1232		100	

MARKING

	New Code	Old Code	See Page
Dekafix	1060192	4440	Pg. 181 - 185
	1060194	4442	
	-	9540	
	-	9770	
Roll Label	-	8943-S11	Pg. 176

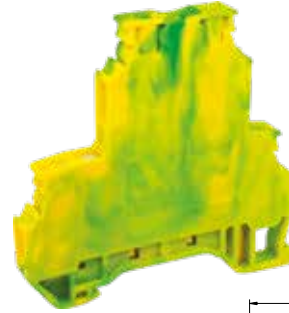
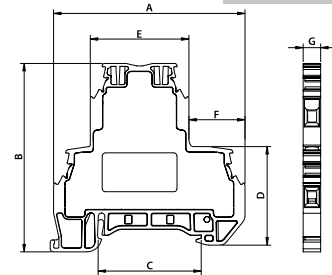
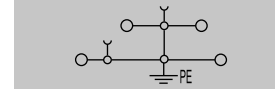
**MRK-C 4**Code: 1010576
Bridged - Earth

* MONOBLOCK *

Dimension (mm)	A	B	C	D	E	F	G
	64	63	34,50	33	33	18,80	6,65

MATERIAL

Body	PA6.6	Temp.	-40 °C, +140 °C
Bridge	Copper	Cable Strip L.	9 mm
Contact	CK45 Steel	Torque	0,5 Nm
Screw	Steel		

DATA	TSE / CE
Voltage	750 V
Current	32 A
Section	4 mm ²
Norm	EN-60947-7-1

COLOURS

	V2	V0	
COLOUR	Code	Code	Pcs.
GREY	1010576	1010582	50

ACCESSORIES

Cross Connection	New Code	Old Code	Section	Pcs.	See Page
	1060111	1930	4 / 2	100	Pg. 40
	1060112	1931	4 / 3	100	
	1060113	1932	4 / 4	50	
	1060114	1933	4 / 10	30	
	1060115	1934	4 / 20	20	
Stopper	1060002	1202		100	Pg. 37-39
	1060005	1212		100	
	1060014	1222		100	
Group Sticker	1060024	1232		100	

MARKING

	New Code	Old Code	See Page
Dekafix	1060190	4390	Pg. 181 - 185
	1060194	4442	
	-	9540	
	-	9770	
Roll Label	-	8943-S11	Pg. 176

MRK SERIES TRIPLE LEVEL SCREW CONNECTION RAIL TERMINAL BLOCKS



MRK-3K 2,5
Code: 1010425

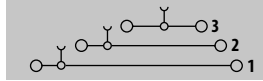

MRK-3K 2,5
Code: 1010443
Level 2 + 3 Bridged

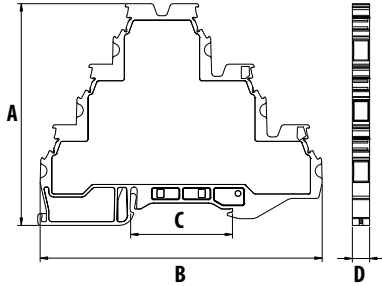
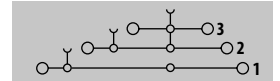

MRK-3K 2,5
Code: 1010434
Bridged

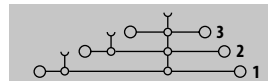

* MONOBLOCK *

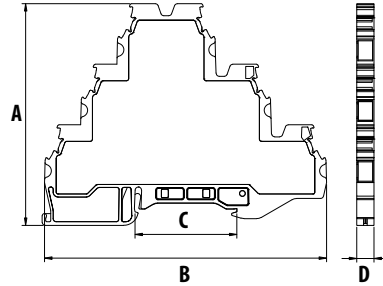

MRK-3K 2,5
Code: 1010452
Level 1 + 2 Bridged

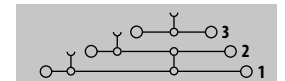

* MONOBLOCK *

Dimension (mm)	A	B	C	D
	75	94,5	34,5	5,85

MATERIAL			
Body	PA6.6	Temp.	-40 °C, +140 °C
Bridge	Copper	Cable Strip L.	9 mm
Contact	CK45 Steel	Torque	0,4 Nm
Screw	Steel		

DATA	TSE / CE
Voltage	750 V
Current	24 A
Section	2,5 mm ²
Norm	EN-60947-7-1

COLOUR	COLOURS		BRIDGED COLOURS		Pcs.
	V2 Code	V0 Code	V2 Code	V0 Code	
GREY	1010425	1010479	1010434	1010488	50
CREAM	1010426	1010480	1010435	1010489	50
BLACK	1010427	1010481	1010436	1010490	50
BLUE	1010428	1010482	1010437	1010491	50
BROWN	1010429	1010483	1010438	1010492	50
RED	1010430	1010484	1010439	1010493	50
YELLOW	1010431	1010485	1010440	1010494	50
GREEN	1010432	1010486	1010441	1010495	50

ACCESSORIES				
Cross Connection	Code	Section	Pcs.	See Page
	1060206	2,5 / 2	100	Pg. 40
	1060207	2,5 / 3	100	
	1060208	2,5 / 4	75	
	1060209	2,5 / 10	30	
	1060210	2,5 / 20	20	
Stopper	1060002		100	Pg. 37-39
	1060005		100	
	1060014		100	
Group Sticker	1060024		100	

MARKING			
	New Code	Old Code	See Page
Dekafix	1060192	4440	Pg. 181 - 185
	1060194	4442	
	-	9540	
	-	9770	
Roll Label	-	8943-S11	Pg. 176

Dimension (mm)	A	B	C	D
	75	94,5	34,5	5,85

MATERIAL			
Body	PA6.6	Temp.	-40 °C, +140 °C
Bridge	Copper	Cable Strip L.	9 mm
Contact	CK45 Steel	Torque	0,4 Nm
Screw	Steel		

DATA	TSE / CE
Voltage	750 V
Current	24 A
Section	2,5 mm ²
Norm	EN-60947-7-1

COLOUR	LEVEL 2+3 BRIDGED COLOURS		LEVEL 1+2 BRIDGED COLOURS		Pcs.
	V2 Code	V0 Code	V2 Code	V0 Code	
GREY	1010443	1010497	1010452	1010506	50
CREAM	1010444	1010498	1010453	1010507	50
BLACK	1010445	1010499	1010454	1010508	50
BLUE	1010446	1010500	1010455	1010509	50
BROWN	1010447	1010501	1010456	1010510	50
RED	1010448	1010502	1010457	1010511	50
YELLOW	1010449	1010503	1010458	1010512	50
GREEN	1010450	1010504	1010459	1010513	50

ACCESSORIES				
Cross Connection	Code	Section	Pcs.	See Page
	1060206	2,5 / 2	100	Pg. 40
	1060207	2,5 / 3	100	
	1060208	2,5 / 4	75	
	1060209	2,5 / 10	30	
	1060210	2,5 / 20	20	
Stopper	1060002		100	Pg. 37-39
	1060005		100	
	1060014		100	
Group Sticker	1060024		100	

MARKING			
	New Code	Old Code	See Page
Dekafix	1060192	4440	Pg. 181 - 185
	1060194	4442	
	-	9540	
	-	9770	
Roll Label	-	8943-S11	Pg. 176

MRK SERIES TRIPLE LEVEL SCREW CONNECTION RAIL TERMINAL BLOCKS

MRK-3K 2,5

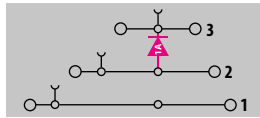
 Code: 1010461
 Level 2 + 3 Diode

Please Specify The Diode Direction!

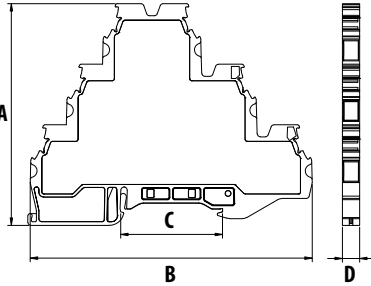
MRK-3K 2,5

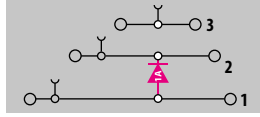
 Code: 1010470
 Level 1 + 2 Diode

Please Specify The Diode Direction!

* MONOBLOCK *

Dimension (mm)	A	B	C	D
	75	94,5	34,5	5,85

MATERIAL

Body	PA6.6	Temp.	-40 °C, +140 °C
Bridge	Copper	Cable Strip L.	9 mm
Contact	CK45 Steel	Torque	0,4 Nm
Screw	Steel		

DATA	TSE / CE
Voltage	750 V
Current	
Section	2,5 mm ²
Norm	EN-60947-7-1

COLOUR	2+3 DIODE COLOURS		1+2 DIODE COLOURS		Pcs.
	V2 Code	V0 Code	V2 Code	V0 Code	
GREY	1010461	1010515	1010470	1010524	50
CREAM	1010462	1010516	1010471	1010525	50
BLACK	1010463	1010517	1010472	1010526	50
BLUE	1010464	1010518	1010473	1010527	50
BROWN	1010465	1010519	1010474	1010528	50
RED	1010466	1010520	1010475	1010529	50
YELLOW	1010467	1010521	1010476	1010530	50
GREEN	1010468	1010522	1010477	1010531	50

ACCESSORIES

Cross Connection	Code	Section	Pcs.	See Page
	1060206	2,5 / 2	100	Pg. 40
	1060207	2,5 / 3	100	
	1060208	2,5 / 4	75	
	1060209	2,5 / 10	30	
	1060210	2,5 / 20	20	
Stopper	1060002		100	Pg. 37-39
	1060005		100	
	1060014		100	
Group Sticker	1060024		100	

MARKING

	New Code	Old Code	See Page
Dekafix	1060192	4440	Pg. 181 - 185
	1060194	4442	
	-	9540	
	-	9770	
Roll Label	-	8943-S11	Pg. 176

MRK-3K 2,5

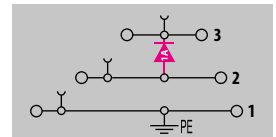
 Code: 1010418
 Level 2 + 3 Diode - Earth

Please Specify The Diode Direction!

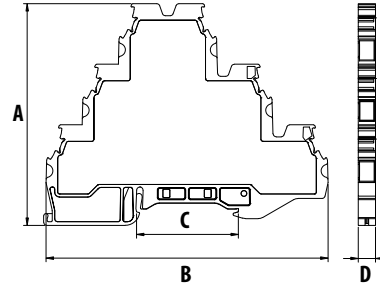

Dimension (mm)	A	B	C	D
	75	94,5	34,5	5,85

MATERIAL

Body	PA6.6	Temp.	-40 °C, +140 °C
Bridge	Copper	Cable Strip L.	9 mm
Contact	CK45 Steel	Torque	0,4 Nm
Screw	Steel		
The Foot Which Contact to the Rail	Brass		

DATA	TSE / CE
Voltage	750 V
Current	
Section	2,5 mm ²
Norm	EN-60947-7-1

COLOUR	COLOURS		Pcs.
	V2 Code	V0 Code	
GREY	1010418	1010423	50

ACCESSORIES

Cross Connection	Code	Section	Pcs.	See Page
	1060206	2,5 / 2	100	Pg. 40
	1060207	2,5 / 3	100	
	1060208	2,5 / 4	75	
	1060209	2,5 / 10	30	
	1060210	2,5 / 20	20	
Stopper	1060002		100	Pg. 37-39
	1060005		100	
	1060014		100	
Group Sticker	1060024		100	

MARKING

	New Code	Old Code	See Page
Dekafix	1060192	4440	Pg. 181 - 185
	1060194	4442	
	-	9540	
	-	9770	
Roll Label	-	8943-S11	Pg. 176

MRK SERIES TRIPLE LEVEL SCREW CONNECTION EARTH RAIL TERMINAL BLOCKS

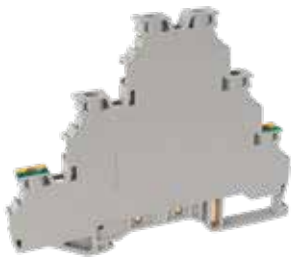

MRK-3K 2,5
Code: 1010414
Earth

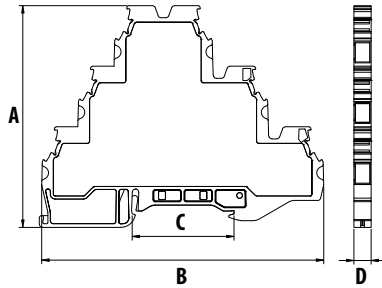
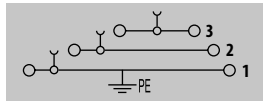

* MONOBLOCK *

Dimension (mm)	A	B	C	D
	75	94,5	34,5	5,85

MATERIAL

Body	PA6.6	Temp.	-40 °C, +140 °C
Bridge	Copper	Cable Strip L.	9 mm
Contact	CK45 Steel	Torque	0,4 Nm
Screw	Steel		
The Foot Which Contact to the Rail	Brass		

DATA	TSE / CE
Voltage	750 V
Current	24 A
Section	2,5 mm ²
Norm	EN-60947-7-1

EARTH COLOURS

BRIDGED - EARTH COLOURS

COLOUR	EARTH COLOURS		BRIDGED - EARTH COLOURS		Pcs.
	V2 Code	V0 Code	V2 Code	V0 Code	
GREY	1010414	1010419	1010415	1010420	50

ACCESSORIES

Cross Connection	Code	Section	Pcs.	See Page
	1060206	2,5 / 2	100	Pg. 40
	1060207	2,5 / 3	100	
	1060208	2,5 / 4	75	
	1060209	2,5 / 10	30	
	1060210	2,5 / 20	20	
Stopper	1060002		100	Pg. 37-39
	1060005		100	
	1060014		100	
Group Sticker	1060024		100	

MARKING

	New Code	Old Code	See Page
Dekafix	1060192	4440	Pg. 181 - 185
	1060194	4442	
	-	9540	
	-	9770	
Roll Label	-	8943-S11	Pg. 176

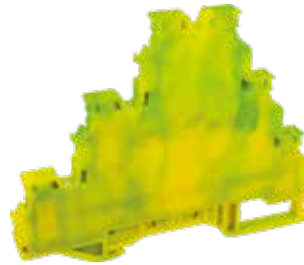

MRK-3K 2,5
Code: 1010415
Bridged - Earth

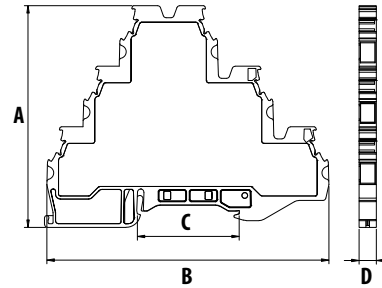
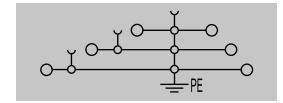

* MONOBLOCK *

Dimension (mm)	A	B	C	D
	75	94,5	34,5	5,85

MATERIAL

Body	PA6.6	Temp.	-40 °C, +140 °C
Bridge	Copper	Cable Strip L.	9 mm
Contact	CK45 Steel	Torque	0,4 Nm
Screw	Steel		
The Foot Which Contact to the Rail	Brass		

DATA	TSE / CE
Voltage	750 V
Current	24 A
Section	2,5 mm ²
Norm	EN-60947-7-1

EARTH COLOURS

BRIDGED - EARTH COLOURS

COLOUR	EARTH COLOURS		BRIDGED - EARTH COLOURS		Pcs.
	V2 Code	V0 Code	V2 Code	V0 Code	
GREY	1010414	1010419	1010415	1010420	50

ACCESSORIES

Cross Connection	Code	Section	Pcs.	See Page
	1060206	2,5 / 2	100	Pg. 40
	1060207	2,5 / 3	100	
	1060208	2,5 / 4	75	
	1060209	2,5 / 10	30	
	1060210	2,5 / 20	20	
Stopper	1060002		100	Pg. 37-39
	1060005		100	
	1060014		100	
Group Sticker	1060024		100	

MARKING

	New Code	Old Code	See Page
Dekafix	1060192	4440	Pg. 181 - 185
	1060194	4442	
	-	9540	
	-	9770	
Roll Label	-	8943-S11	Pg. 176

MRK SERIES TRIPLE LEVEL SCREW CONNECTION EARTH RAIL TERMINAL BLOCKS

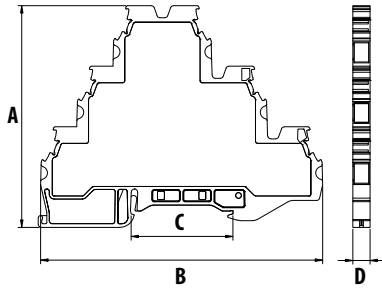
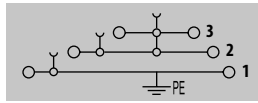
MRK-3K 2,5
Code: 1010416
Level 2 + 3 Bridged - Earth

* MONOBLOCK *

Dimension (mm)	A	B	C	D
	75	94,5	34,5	5,85

MATERIAL

Body	PA6.6	Temp.	-40 °C, +140 °C
Bridge	Copper	Cable Strip L.	9 mm
Contact	CK45 Steel	Torque	0,4 Nm
Screw	Steel		
The Foot Which Contact to the Rail	Brass		

DATA	TSE / CE
Voltage	750 V
Current	24 A
Section	2,5 mm ²
Norm	EN-60947-7-1

LEVEL 2+3 BRID. - EARTH COLOURS
LEVEL 1+2 BRID. - EARTH COLOURS

COLOUR	LEVEL 2+3 BRID. - EARTH COLOURS		LEVEL 1+2 BRID. - EARTH COLOURS		Pcs.
	V2 Code	V0 Code	V2 Code	V0 Code	
GREY	1010416	1010421	1010417	1010422	50

ACCESSORIES

Cross Connection	Code	Section	Pcs.	See Page
	1060206	2,5 / 2	100	Pg. 40
	1060207	2,5 / 3	100	
	1060208	2,5 / 4	75	
	1060209	2,5 / 10	30	
	1060210	2,5 / 20	20	
Stopper	1060002		100	Pg. 37-39
	1060005		100	
	1060014		100	
Group Sticker	1060024		100	

MARKING

	New Code	Old Code	See Page
	Dekafix	1060192	4440
1060194		4442	
-		9540	
-		9770	
Roll Label	-	8943-S11	Pg. 176

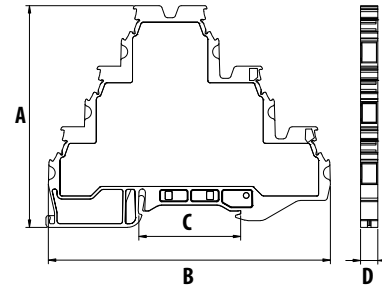
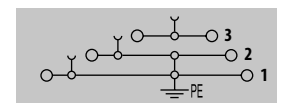
MRK-3K 2,5
Code: 1010417
Level 1 + 2 Bridged - Earth

* MONOBLOCK *

Dimension (mm)	A	B	C	D
	75	94,5	34,5	5,85

MATERIAL

Body	PA6.6	Temp.	-40 °C, +140 °C
Bridge	Copper	Cable Strip L.	9 mm
Contact	CK45 Steel	Torque	0,4 Nm
Screw	Steel		
The Foot Which Contact to the Rail	Brass		

DATA	TSE / CE
Voltage	750 V
Current	24 A
Section	2,5 mm ²
Norm	EN-60947-7-1

LEVEL 2+3 BRID. - EARTH COLOURS
LEVEL 1+2 BRID. - EARTH COLOURS

COLOUR	LEVEL 2+3 BRID. - EARTH COLOURS		LEVEL 1+2 BRID. - EARTH COLOURS		Pcs.
	V2 Code	V0 Code	V2 Code	V0 Code	
GREY	1010416	1010421	1010417	1010422	50

ACCESSORIES

Cross Connection	Code	Section	Pcs.	See Page
	1060206	2,5 / 2	100	Pg. 40
	1060207	2,5 / 3	100	
	1060208	2,5 / 4	75	
	1060209	2,5 / 10	30	
	1060210	2,5 / 20	20	
Stopper	1060002		100	Pg. 37-39
	1060005		100	
	1060014		100	
Group Sticker	1060024		100	

MARKING

	New Code	Old Code	See Page
	Dekafix	1060192	4440
1060194		4442	
-		9540	
-		9770	
Roll Label	-	8943-S11	Pg. 176

MRK SERIES SCREW CONNECTION MOTOR RAIL TERMINAL BLOCKS

MRK SERIES SCREW CONNECTION FUSED RAIL TERMINAL BLOCKS



MRK-MT 2,5
Code: 1010412
3 Levels + Earth

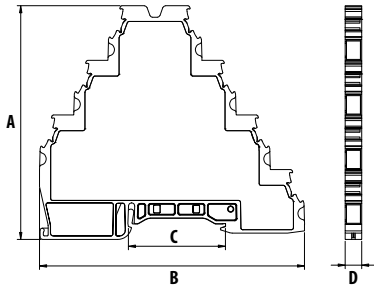
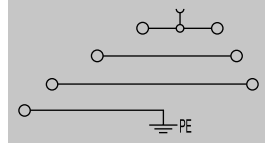

* MONOBLOCK *

Dimension (mm)	A	B	C	D
	93	94,1	34,5	5,85

MATERIAL

Body	PA6.6	Temp.	-40 °C, +140 °C
Bridge	Copper	Cable Strip L.	9 mm
Contact	CK45 Steel	Torque	0,4 Nm
Screw	Steel		
The Foot Which Contact to the Rail	Brass		

DATA	TSE / CE	UL
Voltage	750 V	600 V
Current	24 A	6,3 A
Section	2,5 mm ²	8 AWG
Norm	EN-60947-7-1	UL 1059

COLOURS

	V2	V0	
COLOUR	Code	Code	Pcs.
GREY	1010412	1010413	50

ACCESSORIES

Cross Connection	Code	Section	Pcs.	See Page
	1060206	2,5 / 2	100	Pg. 40
	1060207	2,5 / 3	100	
	1060208	2,5 / 4	75	
	1060209	2,5 / 10	30	
	1060210	2,5 / 20	20	
Stopper	1060002		100	Pg. 37-39
	1060005		100	
	1060014		100	
Group Sticker	1060024		100	

MARKING

	New Code	Old Code	See Page
Dekafix	1060192	4440	Pg. 181 - 185
	1060194	4442	
	-	9540	
	-	9770	
Roll Label	-	8943-S11	Pg. 176



MRK-S 6
New Code 1010241
Old Code 1322

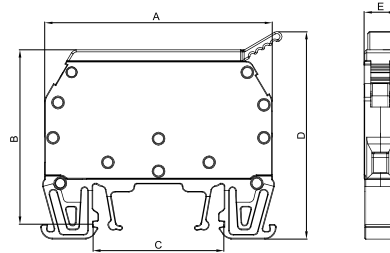
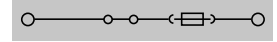

Dimension (mm)	A	B	C	D	E
	60	47	34,5	54,6	8,8

MATERIAL

Body	PA6.6	Temp.	-40 °C, +140 °C
Bridge	Copper	Cable Strip L.	10 mm
Contact	CK45 Steel	Torque	0,8 Nm
Screw	Steel		

DATA	TSE / CE	UL
Voltage	750 V	600 V
Current	6,3 A	6,3 A
Section	6 mm ²	8 AWG
Norm	EN-60947-7-3	UL 1059

COLOURS

COLOUR	New Code	Old Code	Pcs.
GREY	1010241	1322	100

ACCESSORIES

Types	New Code	Old Code	Pcs.	See Page
With Busbar	1010250	1332	100	-
12 V AC/DC Led	1010259	1342	100	-
24 V AC/DC Led	1010268	1352	100	-
48 V AC/DC Led	1010286	1372	100	-
110 V AC/DC Led	1010304	1392	100	-
220 V AC/DC Led	1010313	1402	100	-
Stopper	1060002	1202	100	Pg. 37-39
	1060005	1212	100	
	1060014	1222	100	
Group Sticker	1060024	1232	100	
Glass Fuse	WE-FS-52	-	100	-
	5x20 mm Glass Fuse (0.2.....10A Please inform amp.)			

MARKING

	New Code	Old Code	See Page
Dekafix	1060188	2630	Pg. 181 - 185
	1060194	4442	
	-	9540	
	-	9770	
	-	9770	



MRK SERIES SCREW CONNECTION KNIFE DISCONNECT TERMINAL BLOCK



MRK TEST - 2,5/4
Code 1010577

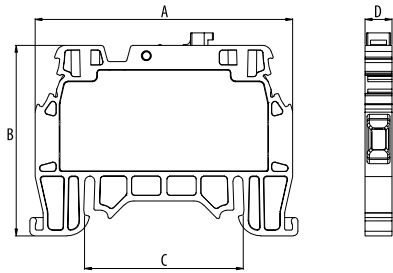

* MONOBLOCK *

Dimension (mm)	A	B	C	D
	56	41,4	34,5	5,85

MATERIAL

Body	PA6.6	Temp.	-40 °C, +140 °C
Bridge	Copper	Cable Strip L.	10 mm
Contact	CK45 Steel	Torque	0,4 Nm
Screw	Steel		

DATA	TSE / CE
Voltage	750 V
Current	24 A
Section	2,5 mm ²
Norm	EN-60947-7-1

COLOURS

COLOUR	New Code	Old Code	Pcs.
GREY	1010577	-	50

ACCESSORIES

	New Code	Old Code	See Page
Stopper	1060002	1202	Pg. 37-39
	1060005	1212	
	1060014	1222	
Group Sticker	1060024	1232	

MARKING

	New Code	Old Code	See Page
Dekafix	1060192	4440	Pg. 181 - 185
	1060194	4442	
	-	9540	
	-	9770	
Roll Label	-	8943-S11	Pg. 176



MRK TEST - 6
New Code 1010238
Old Code 1316

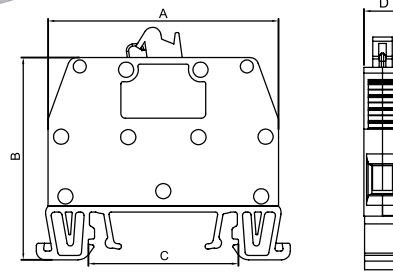

Dimension (mm)	A	B	C	D
	52,8	46,5	34,5	8,5

MATERIAL

Body	PA6.6	Temp.	-40 °C, +140 °C
Bridge	Copper	Cable Strip L.	12 mm
Contact	CK45 Steel	Torque	0,8 Nm
Screw	Steel		

DATA	TSE / CE	UL
Voltage	750 V	600 V
Current	41 A	41 A
Section	6 mm ²	8 AWG
Norm	EN-60947-7-1	UL 1059

COLOURS

COLOUR	New Code	Old Code	Pcs.
GREY	1010238	1316	100

ACCESSORIES

	New Code	Old Code	See Page
Stopper	1060002	1202	Pg. 37-39
	1060005	1212	
	1060014	1222	
	1060024	1232	

MARKING

	New Code	Old Code	See Page
Dekafix	1060188	2630	Pg. 181 - 185
	1060194	4442	
	-	9540	
	-	9770	
	-	9770	

MRK NEW SERIES TEST DISCONNECT TERMINAL BLOCKS



MRK TEST - 6
Without Test Socket
New Code: 1010217
Old Code: 1285

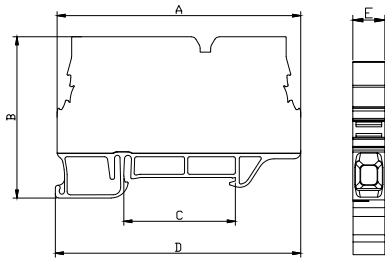

Dimension (mm)	A	B	C	D	E
	75,5	50	34,5	76	8,1

MATERIAL

Body	PA6.6	Temp.	-40 °C, +140 °C
Bridge	Copper	Cable Strip L.	12 mm
Contact	CK45 Steel	Torque	0,8 Nm
Screw	Steel		

DATA	TSE / CE
Voltage	750 V
Current	41 A
Section	6 mm ²
Norm	EN-60947-7-1

COLOURS

COLOUR	New Code	Old Code	Pcs.
GREY	1010217	1285	50
CREAM	1010211	1278	50

ACCESSORIES

Cross Connection	New Code	Old Code	Section	Pcs.	See Page
	1060116	1935	6 / 2	100	Pg. 40
	1060117	1936	6 / 3	50	
	1060118	1937	6 / 4	50	
	1060119	1938	6 / 10	15	
	1060120	1939	6 / 20	10	
	1060002	1202		100	
1060005	1212		100		
1060014	1222		100		
1060024	1232		100		

MARKING

	New Code	Old Code	See Page
Dekafix	1060188	2630	Pg. 181 - 185
	1060194	4442	
	-	9540	
	-	9770	
Roll Label	-	8943-S11	Pg. 176



MRK TEST - 6
Single Test Socket
New Code: 1010213
Old Code: 1281

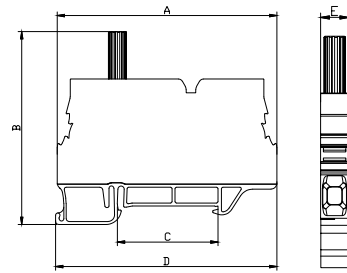

Dimension (mm)	A	B	C	D	E
	75,5	66,3	34,5	76	8,1

MATERIAL

Body	PA6.6	Temp.	-40 °C, +140 °C
Bridge	Copper	Cable Strip L.	12 mm
Contact	CK45 Steel	Torque	0,8 Nm
Screw	Steel		

DATA	TSE / CE
Voltage	750 V
Current	41 A
Section	6 mm ²
Norm	EN-60947-7-1

COLOURS

COLOUR	New Code	Old Code	Pcs.
GREY	1010213	1281	50

ACCESSORIES

Cross Connection	New Code	Old Code	Section	Pcs.	See Page
	1060116	1935	6 / 2	100	Pg. 40
	1060117	1936	6 / 3	50	
	1060118	1937	6 / 4	50	
	1060119	1938	6 / 10	15	
	1060120	1939	6 / 20	10	
	1060147	1790	6 / 2	10	
1060148	1971	6 / 3	10		
1060149	1972	6 / 4	10		
1060150	1973	6 / 6	10		
	1060151	1974	6 / 10	10	Pg. 37-39
	1060002	1202		100	
	1060005	1212		100	
	1060014	1222		100	
Group Sticker	1060024	1232		100	

MARKING

	New Code	Old Code	See Page
Dekafix	1060188	2630	Pg. 181 - 185
	1060194	4442	
	-	9540	
	-	9770	
Roll Label	-	8943-S11	Pg. 176



MRK NEW SERIES TEST DISCONNECT TERMINAL BLOCKS

MRK 6 TEST DISCONNECT TERMINAL BLOCK ACCESSORIES



MRK TEST - 6
Double Test Socket
New Code: 1010215
Old Code: 1283

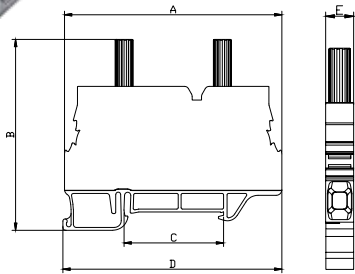

Dimension (mm)	A	B	C	D	E
	75,5	66,3	34,5	76	8,1

MATERIAL

Body	PA6.6	Temp.	-40 °C, +140 °C
Bridge	Copper	Cable Strip L.	12 mm
Contact	CK45 Steel	Torque	0,8 Nm
Screw	Steel		

DATA	TSE / CE
Voltage	750 V
Current	41 A
Section	6 mm ²
Norm	EN-60947-7-1

COLOURS

COLOUR	New Code	Old Code	Pcs.
GREY	1010215	1283	50
CREAM	1010212	1279	50

ACCESSORIES

Cross Connection	New Code	Old Code	Section	Pcs.	See Page
	1060116	1935	6 / 2	100	Pg. 40
	1060117	1936	6 / 3	50	
	1060118	1937	6 / 4	50	
	1060119	1938	6 / 10	15	
	1060120	1939	6 / 20	10	
	1060147	1790	6 / 2	10	Pg. 29
	1060148	1971	6 / 3	10	
	1060149	1972	6 / 4	10	
	1060150	1973	6 / 6	10	
	1060151	1974	6 / 10	10	
Stopper	1060002	1202		100	Pg. 37-39
	1060005	1212		100	
	1060014	1222		100	
Group Sticker	1060024	1232		100	

MARKING

	New Code	Old Code	See Page
Dekafix	1060188	2630	Pg. 181 - 185
	1060194	4442	
	-	9540	
	-	9770	
Roll Label	-	8943-S11	Pg. 176



Upper Bridge for Test Sockets

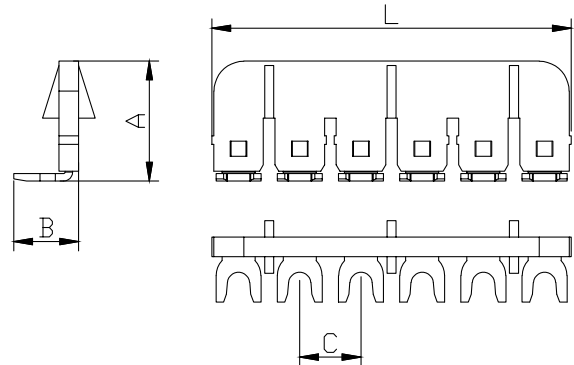

NEW CODE	OLD CODE	TYPE	Dimensions (mm)				Pcs
			A	B	C	L	
1060147	1970	2 Poles	16	8,6	8,1	15,2	10
1060148	1971	3 Poles	16	8,6	8,1	23,4	10
1060149	1972	4 Poles	16	8,6	8,1	31,5	10
1060150	1973	6 Poles	16	8,6	8,1	47,8	10
1060151	1974	10 Poles	16	8,6	8,1	80,4	10

MATERIAL

Body	PA6.6
Bridge	Copper
Temp.	-40 °C, +140 °C

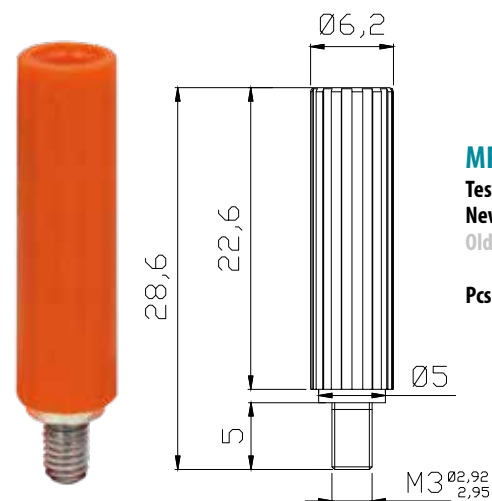

MRK TEST - 6
Test Socket
New Code: 1060073
Old Code: 1280

Pcs: 10

MATERIAL

Body	PA6.6
Bridge	Brass
Temp.	-40 °C, +140 °C

MRK SERIES TEST DISCONNECT TERMINAL BLOCKS

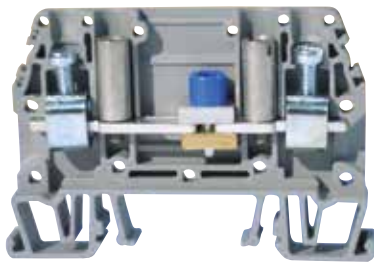

MRK TEST - 10
Without Test Socket
New Code: 1010236
Old Code: 1312

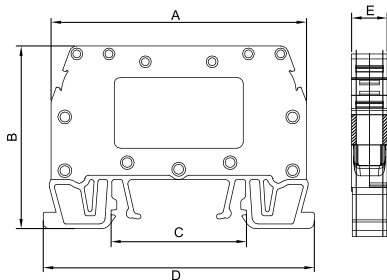
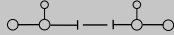

Dimension (mm)	A	B	C	D	E
	65	46,5	34,5	69	9,1

MATERIAL

Body	PA6.6	Temp.	-40 °C, +140 °C
Bridge	Copper	Cable Strip L.	12 mm
Contact	CK45 Steel	Torque	0,8 Nm
Screw	Steel		

DATA	TSE / CE	UL
Voltage	750 V	600 V
Current	57 A	50 A
Section	10 mm ²	8 AWG
Norm	EN-60947-7-1	UL 1059

COLOURS

COLOUR	New Code	Old Code	Pcs.
GREY	1010236	1312	75

ACCESSORIES

	New Code	Old Code	Pcs.	See Page
Upper Bridge 2 Poles	1060078	1303	50	Pg. 32
Upper Bridge 4 Poles	1060080	1318	50	
Upper Bridge 8 Poles	1060077	1302	50	
Testing Screw	1060081	1319	50	Pg. 37-39
Stopper	1060002	1202	100	
	1060005	1212	100	
	1060014	1222	100	
Group Sticker	1060024	1232	100	

MARKING

	New Code	Old Code	See Page
Dekafix	1060188	2630	Pg. 181 - 185
	1060194	4442	
	-	9540	
	-	9770	

MRK SERIES TEST DISCONNECT TERMINAL BLOCKS



MRK TEST - 10
Single Test Socket
New Code: 1010230
Old Code: 1306

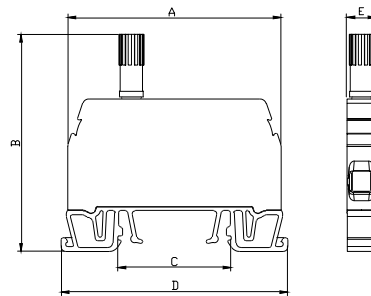
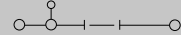

Dimension (mm)	A	B	C	D	E
	65	66,1	34,5	69	9

MATERIAL

Body	PA6.6	Temp.	-40 °C, +140 °C
Bridge	Copper	Cable Strip L.	12 mm
Contact	CK45 Steel	Torque	0,8 Nm
Screw	Steel		

DATA	TSE / CE	UL
Voltage	750 V	600 V
Current	57 A	50 A
Section	10 mm ²	8 AWG
Norm	EN-60947-7-1	UL 1059

COLOURS

COLOUR	New Code	Old Code	Pcs.
GREY	1010230	1306	50

ACCESSORIES

	New Code	Old Code	Pcs.	See Page
Upper Bridge 2 Poles	1060078	1303	50	Pg. 32
Upper Bridge 4 Poles	1060080	1318	50	
Upper Bridge 8 Poles	1060077	1302	50	
Testing Screw	1060081	1319	50	Pg. 37-39
Stopper	1060002	1202	100	
	1060005	1212	100	
	1060014	1222	100	
Group Sticker	1060024	1232	100	

MARKING

	New Code	Old Code	See Page
Dekafix	1060188	2630	Pg. 181 - 185
	1060194	4442	
	-	9540	
	-	9770	

MRK SERIES TEST DISCONNECT TERMINAL BLOCKS

MRK TEST - 10
Double Test Socket
 New Code: 1010232
 Old Code: 1308

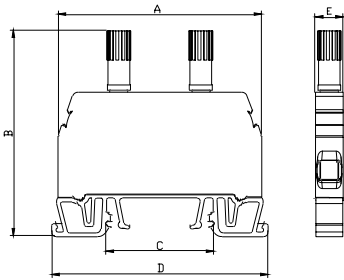
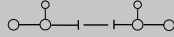

Dimension (mm)	A	B	C	D	E
	65	66,1	34,5	69	9

MATERIAL

Body	PA6.6	Temp.	-40 °C, +140 °C
Bridge	Copper	Cable Strip L.	12 mm
Contact	CK45 Steel	Torque	0,8 Nm
Screw	Steel		

DATA	TSE / CE	UL
Voltage	750 V	600 V
Current	57 A	50 A
Section	10 mm ²	8 AWG
Norm	EN-60947-7-1	UL 1059

COLOURS

COLOUR	New Code	Old Code	Pcs.
GREY	1010232	1308	50

ACCESSORIES

	New Code	Old Code	Pcs.	See Page
Upper Bridge 2 Poles	1060078	1303	50	Pg. 32
Upper Bridge 4 Poles	1060080	1318	50	
Upper Bridge 8 Poles	1060077	1302	50	
Testing Screw	1060081	1319	50	Pg. 37-39
Stopper	1060002	1202	100	
	1060005	1212	100	
	1060014	1222	100	
Group Sticker	1060024	1232	100	

MARKING

	New Code	Old Code	See Page
Dekafix	1060188	2630	Pg. 181 - 185
	1060194	4442	
	-	9540	
	-	9770	

MRK SERIES TEST DISCONNECT TERMINAL SET

MRK TEST - 10
4 Poles Test Disconnect Set
 New Code: 1010229
 Old Code: 1305

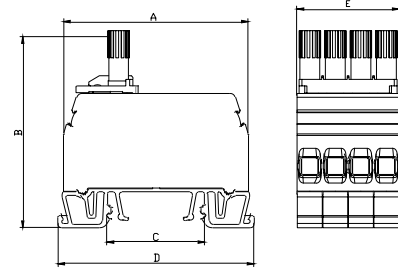
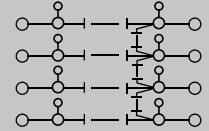

Dimension (mm)	A	B	C	D	E
	65	68,1	34,5	69	36

MATERIAL

Body	PA6.6	Temp.	-40 °C, +140 °C
Bridge	Copper	Cable Strip L.	12 mm
Contact	CK45 Steel	Torque	0,8 Nm
Screw	Steel		

DATA	TSE / CE	UL
Voltage	750 V	600 V
Current	57 A	50 A
Section	10 mm ²	8 AWG
Norm	EN-60947-7-1	UL 1059

COLOURS

COLOUR	New Code	Old Code	Pcs.
GREY	1010229	1305	50

ACCESSORIES

	New Code	Old Code	Pcs.	See Page
Double Test	1010232	1308	50	Pg. 32
Upper Bridge 2 Poles	1060078	1303	50	
Upper Bridge 4 Poles	1060080	1318	50	
Upper Bridge 8 Poles	1060077	1302	50	Pg. 37-39
Testing Screw	1060081	1319	50	
Stopper	1060002	1202	100	
	1060005	1212	100	
	1060014	1222	100	
Group Sticker	1060024	1232	100	

MARKING

	New Code	Old Code	See Page
Dekafix	1060188	2630	Pg. 181 - 185
	1060194	4442	
	-	9540	
	-	9770	

MRK 10 TEST DISCONNECT TERMINAL BLOCKS ACCESSORIES

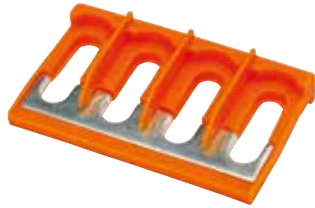
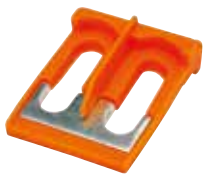

Upper Bridge for Test Sockets, 2 Poles
New Code: 1060078
Old Code: 1303

Upper Bridge for Test Sockets, 4 Poles
New Code: 1060080
Old Code: 1318

Upper Bridge for Test Sockets, 8 Poles
New Code: 1060077
Old Code: 1302

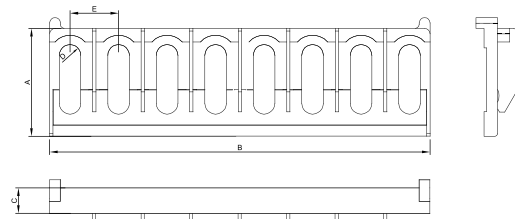
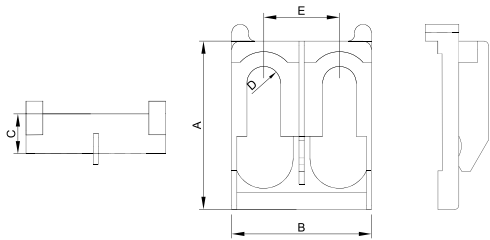

NEW CODE	OLD CODE	Dimensions (mm)				
		A	B	C	D	E
1060078	1303	22	22	4,7	4	9
1060080	1318	22	34,6	4,7	4	9

NEW CODE	OLD CODE	Dimensions (mm)				
		A	B	C	D	E
1060077	1302	22	71	4,7	4	9

MATERIAL	
Body	PA6.6
Temp.	-40 °C, +140 °C
Metal Leg	Copper

MATERIAL	
Body	PA6.6
Temp.	-40 °C, +140 °C
Metal Leg	Copper

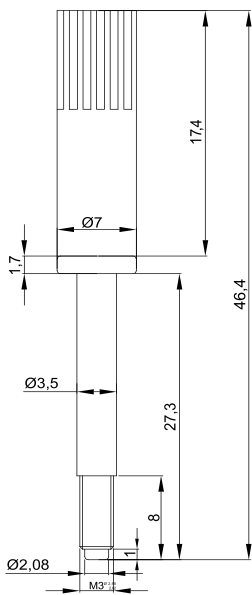

Testing Screw
New Code: 1060081
Old Code: 1319

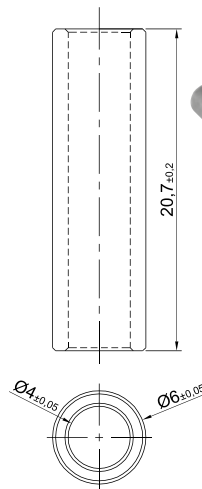

Explosive for Upper Bridge
New Code: 1060079
Old Code: 1304

MATERIAL	
Body	PA6.6
Temp.	-40 °C, +140 °C
Screw	Brass

MATERIAL	
Body	Brass



MRK SERIES SCREW CONNECTION EARTH RAIL TERMINAL BLOCKS

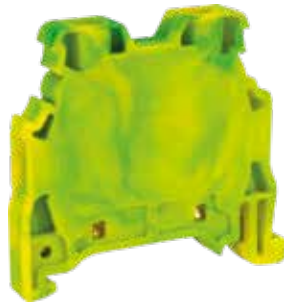

MTK 2,5
New Code: 1010219
Old Code: 1291

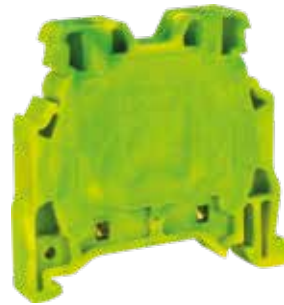
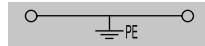

MTK 4
New Code: 1010220
Old Code: 1293

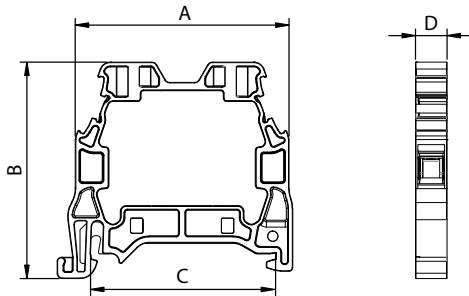
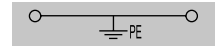

* MONOBLOCK *

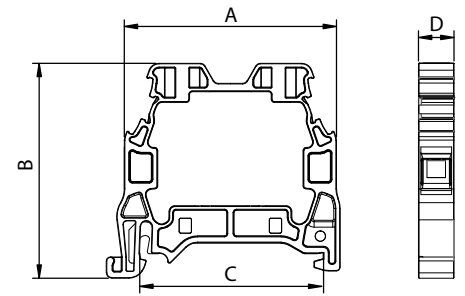

* MONOBLOCK *

Dimension (mm)	A	B	C	D
	40	41,3	34,5	5,9

Dimension (mm)	A	B	C	D
	40	41,3	34,5	6,7

MATERIAL			
Body	PA6.6	Temp.	-40 °C, +140 °C
Bridge	Copper	Cable Strip L.	9 mm
Contact	CK45 Steel	Torque	0,4 Nm
Screw	Steel		
The Foot Which Contact to the Rail	Brass		

MATERIAL			
Body	PA6.6	Temp.	-40 °C, +140 °C
Bridge	Copper	Cable Strip L.	9 mm
Contact	CK45 Steel	Torque	0,5 Nm
Screw	Steel		
The Foot Which Contact to the Rail	Brass		

DATA	TSE / CE
Voltage	750 V
Section	2,5 mm ²
Norm	EN-60947-7-2

DATA	TSE / CE	UL
Voltage	750 V	300 V
Section	4,0 mm ²	10 AWG
Norm	EN-60947-7-2	UL 1059

COLOURS			
COLOUR	New Code	Old Code	Pcs.
CAMOUFLAGE	1010219	1291	100

COLOURS			
COLOUR	New Code	Old Code	Pcs.
CAMOUFLAGE	1010220	1293	100

ACCESSORIES			
	New Code	Old Code	See Page
Stopper	1060002	1202	Pg. 37-39
	1060005	1212	
	1060014	1222	
Group Sticker	1060024	1232	

ACCESSORIES			
	New Code	Old Code	See Page
Stopper	1060002	1202	Pg. 37-39
	1060005	1212	
	1060014	1222	
Group Sticker	1060024	1232	

MARKING			
	New Code	Old Code	See Page
Dekafix	1060190	4390	Pg. 181 - 185
	1060194	4442	
	-	9540	
	-	9770	
Roll Label	-	8943-S11	Pg. 176

MARKING			
	New Code	Old Code	See Page
Dekafix	1060190	4390	Pg. 181 - 185
	1060194	4442	
	-	9540	
	-	9770	
Roll Label	-	8943-S11	Pg. 176

MRK SERIES SCREW CONNECTION EARTH RAIL TERMINAL BLOCKS



MTK 6
Code: 1010541

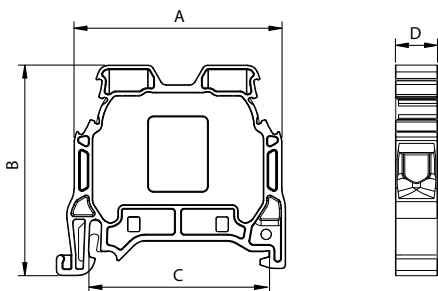
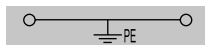

* MONOBLOCK *

Dimension (mm)	A	B	C	D
	40	41,3	34,5	8,1

MATERIAL

Body	PA6.6	Temp.	-40 °C, +140 °C
Bridge	Copper	Cable Strip L.	12 mm
Contact	CK45 Steel	Torque	0,8 Nm
Screw	Steel		
The Foot Which Contact to the Rail	Brass		

DATA	TSE / CE	UL
Voltage	750 V	600 V
Section	6 mm ²	8 AWG
Norm	EN-60947-7-2	UL 1059

COLOURS

COLOUR	Code	Pcs.
CAMOUFLAGE	1010541	100

ACCESSORIES

	New Code	Old Code	See Page
Stopper	1060002	1202	Pg. 37-39
	1060005	1212	
	1060014	1222	
Group Sticker	1060024	1232	

MARKING

	New Code	Old Code	See Page
Dekafix	1060188	2630	Pg. 181 - 185
	1060194	4442	
	-	9540	
	-	9770	
Roll Label	-	8943-S11	Pg. 176

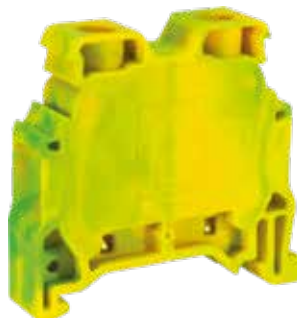

MTK 10
New Code: 1010221
Old Code: 1294

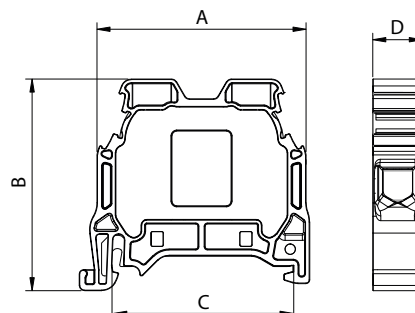

* MONOBLOCK *

Dimension (mm)	A	B	C	D
	40	41,3	34,5	9,6

MATERIAL

Body	PA6.6	Temp.	-40 °C, +140 °C
Bridge	Copper	Cable Strip L.	12 mm
Contact	CK45 Steel	Torque	0,8 Nm
Screw	Steel		
The Foot Which Contact to the Rail	Brass		

DATA	TSE / CE	UL
Voltage	750 V	600 V
Section	10 mm ²	8 AWG
Norm	EN-60947-7-2	UL 1059

COLOURS

COLOUR	New Code	Old Code	Pcs.
CAMOUFLAGE	1010221	1294	100

ACCESSORIES

	New Code	Old Code	See Page
Stopper	1060002	1202	Pg. 37-39
	1060005	1212	
	1060014	1222	
Group Sticker	1060024	1232	

MARKING

	New Code	Old Code	See Page
Dekafix	1060188	2630	Pg. 181 - 185
	1060194	4442	
	-	9540	
	-	9770	
Roll Label	-	8943-S11	Pg. 176

MRK SERIES SCREW CONNECTION EARTH RAIL TERMINAL BLOCKS

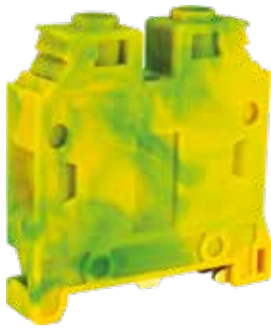
**MTK 16**

Code: 1010532

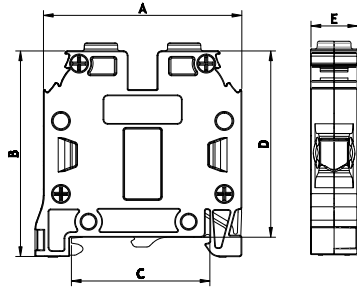
**MTK 25**

New Code: 1010223

Old Code: 1297

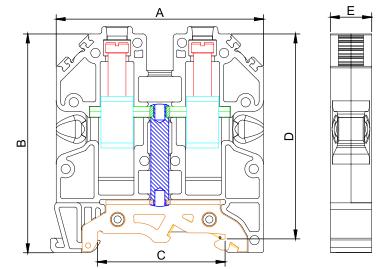
With Non -
Insulated Cord End
Terminals

Dimension (mm)	A	B	C	D	E
	51	52,9	34,5	47,9	12

MATERIAL

Body	PA6.6	Temp.	-40 °C, +140 °C
Bridge	Copper	Cable Strip L.	16 mm
Contact	CK45 Steel	Torque	1,2 Nm
Screw	Steel		
The Foot Which Contact to the Rail	Brass		

DATA	TSE / CE	UL
Voltage	750 V	600 V
Section	16 mm ²	6 AWG
Norm	EN-60947-7-2	UL 1059

COLOURS

COLOUR	Code	Pcs.
CAMOUFLAGE	1010532	50

ACCESSORIES

	New Code	Old Code	See Page
Stopper	1060002	1202	Pg. 37-39
	1060005	1212	
	1060014	1222	
Group Sticker	1060024	1232	

MARKING

	New Code	Old Code	See Page
Dekafix	1060192	4440	Pg. 181 - 185
	1060194	4442	
	-	9540	
	-	9770	
Roll Label	-	8943-S11	Pg. 176

Dimension (mm)	A	B	C	D	E
	58,2	63,5	34,5	57	11,6

MATERIAL

Body	PA6.6	Temp.	-40 °C, +140 °C
Bridge	Copper	Cable Strip L.	16 mm
Contact	CK45 Steel	Torque	1,2 Nm
Screw	Steel		
The Foot Which Contact to the Rail	Brass		

DATA	TSE / CE
Voltage	750 V
Section	25 mm ²
Norm	EN-60947-7-2

COLOURS

COLOUR	New Code	Old Code	Pcs.
CAMOUFLAGE	1010223	1297	50

ACCESSORIES

	New Code	Old Code	See Page
Stopper	1060002	1202	Pg. 37-39
	1060005	1212	
	1060014	1222	
Group Sticker	1060024	1232	

MARKING

	New Code	Old Code	See Page
Dekafix	1060194	4442	Pg. 181 - 185
	-	9540	
	-	9770	
	-	9770	

MRK SERIES SCREW CONNECTION EARTH RAIL TERMINAL BLOCKS



MTK 35 (SHORT)
Code: 1010533

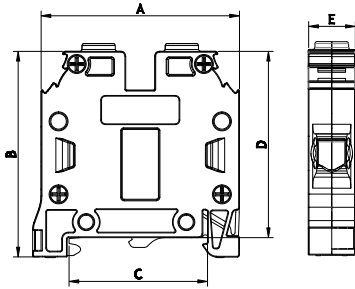

MTK 35
New Code: 1010225
Old Code: 1296

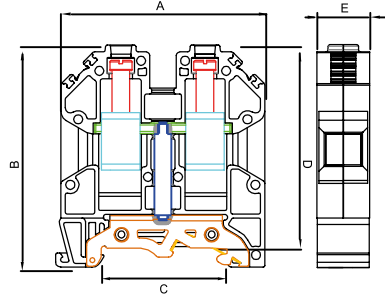
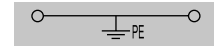

Dimension (mm)	A	B	C	D	E
	51	52,9	34,5	47,9	15

MATERIAL			
Body	PA6.6	Temp.	-40 °C, +140 °C
Bridge	Copper	Cable Strip L.	16 mm
Contact	CK45 Steel	Torque	1,2 Nm
Screw	Steel		
The Foot Which Contact to the Rail	Brass		

DATA	TSE / CE
Voltage	750 V
Section	35 mm ²
Norm	EN-60947-7-2

COLOURS		
COLOUR	Code	Pcs.
CAMOUFLAGE	1010533	30

ACCESSORIES			
	New Code	Old Code	See Page
Stopper	1060002	1202	Pg. 37-39
	1060005	1212	
	1060014	1222	
Group Sticker	1060024	1232	

MARKING			
	New Code	Old Code	See Page
Dekafix	1060192	4440	Pg. 181 - 185
	1060194	4442	
	-	9540	
	-	9770	
Roll Label	-	8943-S11	Pg. 176

Dimension (mm)	A	B	C	D	E
	58,2	63,5	34,5	57	14,9

MATERIAL			
Body	PA6.6	Temp.	-40 °C, +140 °C
Bridge	Copper	Cable Strip L.	16 mm
Contact	CK45 Steel	Torque	1,2 Nm
Screw	Steel		
The Foot Which Contact to the Rail	Brass		

DATA	TSE / CE
Voltage	750 V
Section	35 mm ²
Norm	EN-60947-7-2

COLOURS			
COLOUR	New Code	Old Code	Pcs.
CAMOUFLAGE	1010225	1296	30

ACCESSORIES			
	New Code	Old Code	See Page
Stopper	1060002	1202	Pg. 37-39
	1060005	1212	
	1060014	1222	
Group Sticker	1060024	1232	

MARKING			
	New Code	Old Code	See Page
Dekafix	1060194	4442	Pg. 181 - 185
	-	9540	
	-	9770	
	-	9770	

MRK AND OPK SERIES BIG STOPPER



Big Stopper
New Code: 1060005
Old Code: 1212

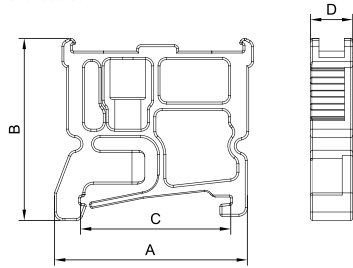

It can be marked by "ONKA-8920-736SE/SB" sticker.

Dimension (mm)	A	B	C	D
	44,6	43,5	34,5	9,8

MATERIAL

Body	PA	Temp.	-40 °C, +140 °C
Screw	Steel	Pcs	100

MARKING

Dekafix	New Code	Old Code	See Page
	1060190	4390	Pg. 181 - 185
1060192	4440		
1060194	4442		
1060198	5443		
-	9540		
-	9770		

MRK AND OPK SERIES SCREWLESS STOPPER



Screwless Stopper
New Code: 1060002
Old Code: 1202

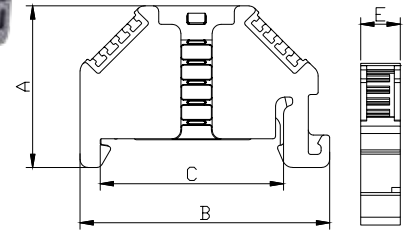

Dimension (mm)	A	B	C	D
	30,7	47,4	34,5	7,5

MATERIAL

Body	PA	Temp.	-40 °C, +140 °C
Screw	Stainless Steel	Pcs	100

MARKING

Dekafix	New Code	Old Code	See Page
	1060188	2630	Pg. 181 - 185
1060190	4390		
1060192	4440		
1060194	4442		
1060198	5443		
-	9540		
-	9770		

MRK AND OPK SERIES BIG STOPPER



Stopper With Group Sticker
New Code: 1060024
Old Code: 1232

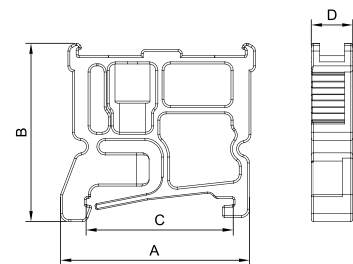

It can be marked by "ONKA-8920-736SE/SB" sticker.

Dimension (mm)	A	B	C	D
	44,6	43,5	34,5	9,8

MATERIAL

Body	PA	Temp.	-40 °C, +140 °C
Screw	Steel	Pcs	100

MARKING

Dekafix	New Code	Old Code	See Page
	1060190	4390	Pg. 181 - 185
1060192	4440		
1060194	4442		
1060198	5443		
-	9540		
-	9770		

GROUP MARKER



Group Marker
New Code: 1060093
Old Code: 1482

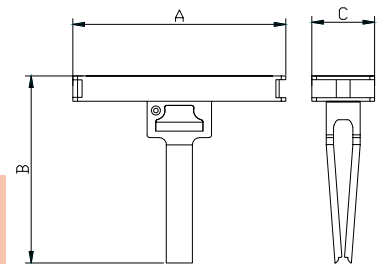

It can be marked by "ONKA-8920-736SE/SB & ONKA-8943-SBG" sticker.

Dimension (mm)	A	B	C
	46,2	40,6	13,6

MATERIAL

Body	PC	Temp.	-40 °C, +140 °C
Pcs	100		

MRK AND OPK SERIES MINI STOPPER



Mini Stopper
New Code: 1060014
Old Code: 1222

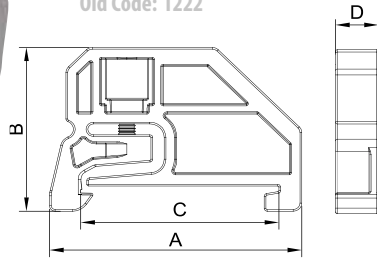

Dimension (mm)	A	B	C	D
	43,0	30,0	34,5	7,5

MATERIAL

Body	PA	Temp.	-40 °C, +140 °C
Screw	Steel	Pcs	100

MARKING

	New Code	Old Code	See Page
Dekafix	1060190	4390	Pg. 181 - 185
	1060192	4440	
	1060194	4442	
	1060198	5443	
	-	9540	
	-	9770	

GROUP LABEL



Group Label
Code: 1060500

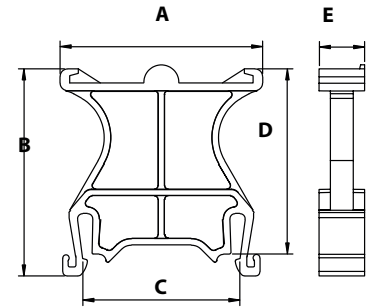

It can be marked by "ONKA-8920-736SE/SB & ONKA-8943-SBG" sticker.

Dimension (mm)	A	B	C	D	E
	44,5	45,5	34,5	40,7	10

MATERIAL

Body	PA 6.6	Pcs	100
Temp.	-40 °C, +140 °C		

MRK AND OPK SERIES SEPARATION PLATE

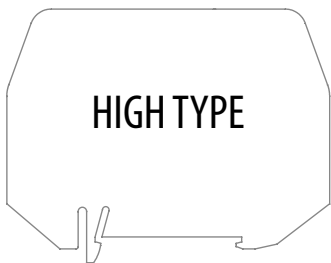

Separation Plate
Code: 0999

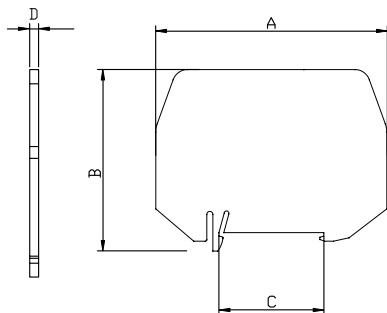

Dimension (mm)	A	B	C	D
	76,0	60,0	34,5	0,7

MATERIAL

Body	PET (FF)	Temp.	-40 °C, +140 °C
Pcs	25		

MRK SERIES SEPARATION PLATE



MRK Series Separation Plate
New Code: 1060051
Old Code: 0582

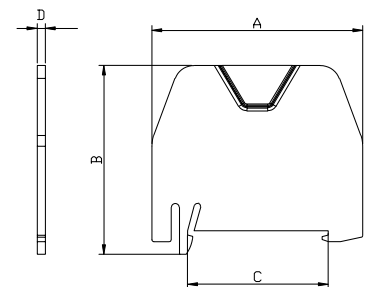

Dimension (mm)	A	B	C	D
	52,0	48,0	34,5	2,0

MATERIAL

Body	PA	Temp.	-40 °C, +140 °C
Pcs	25		

COLOURS

COLOUR	New Code	Old Code	Pcs.
GREY	1060051	0582	25
RED	1060052	0587	25

MRK AND OPK SERIES SEPARATION PLATE



High Type Separation Plate
Code: 1060527

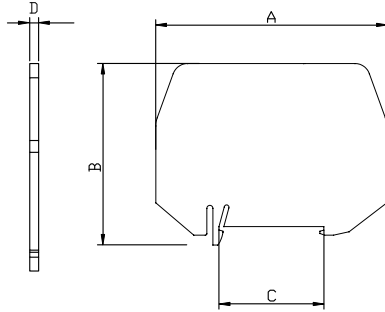

Dimension (mm)	A	B	C	D
	76,0	60,0	34,5	1,75

MATERIAL

Body	PA	Temp.	-40 °C, +140 °C
Pcs	25		

COLOURS

COLOUR	Code	Pcs.
GREY	1060527	25
CREAM	1060528	25
BLACK	1060529	25
BLUE	1060530	25
BROWN	1060531	25
RED	1060532	25
YELLOW	1060533	25
GREEN	1060534	25

PROTECTION COVER



Protection Cover
Code: 1845

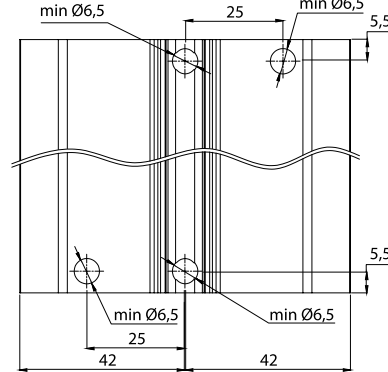

The hole template of protection cover!

Dimension (mm)	A	B	C	D
	52,0	48,0	34,5	2,0

MATERIAL

Body	PA	Temp.	-40 °C, +140 °C
Pcs	25		

COLOURS

COLOUR	Code	Pcs.
TRANSPARENT	1060051	25

STOPPER FOR PROTECTION COVER



Stopper
Code: 1060535



Stopper
Code: 1060536
With Metal Foot

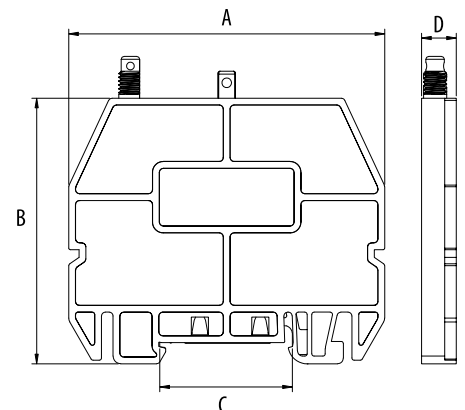

Dimension (mm)	A	B	C	D
	82,0	68,9	34,5	9,0

MATERIAL

Body	PA	Temp.	-40 °C, +140 °C
Pcs	10		

COLOURS

COLOUR	Code	Code (Metal Foot)	Pcs.
GREY	1060535	1060536	10

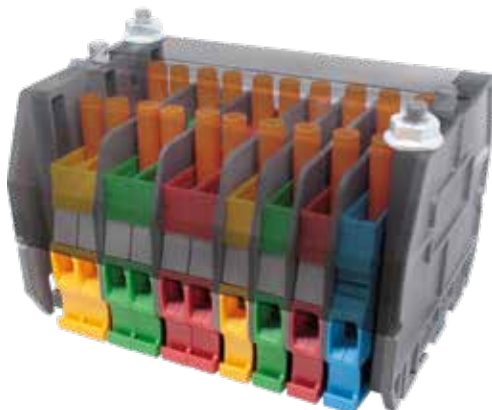

MRK SERIES CROSS CONNECTIONS

Note: All 1,5 mm², 2,5 mm² and 4 mm² cross connections can be both used for MRK and OPK Series.

For the Slim Series, please check the relevant product accessories section.

MATERIAL	
Isolation	PA 6.6
Body	Brass
Covering	Tin

COLOUR	NEW CODE	OLD CODE	TYPE	PCS
Orange	1060101	1920	1.5 mm ² x 2	100
Orange	1060102	1921	1.5 mm ² x 3	100
Orange	1060103	1922	1.5 mm ² x 4	100
Orange	1060104	1923	1.5 mm ² x 10	30
Orange	1060105	1924	1.5 mm ² x 20	20
Orange	1060106	1925	2.5 mm ² x 2	100
Orange	1060107	1926	2.5 mm ² x 3	100
Orange	1060108	1927	2.5 mm ² x 4	75
Orange	1060109	1928	2.5 mm ² x 10	30
Orange	1060110	1929	2.5 mm ² x 20	20
Orange	1060111	1930	4 mm ² x 2	100
Orange	1060112	1931	4 mm ² x 3	50
Orange	1060113	1932	4 mm ² x 4	50
Orange	1060114	1933	4 mm ² x 10	30
Orange	1060115	1934	4 mm ² x 20	20
Orange	1060116	1935	6 mm ² x 2	100
Orange	1060117	1936	6 mm ² x 3	50
Orange	1060118	1937	6 mm ² x 4	50
Orange	1060119	1938	6 mm ² x 10	15
Orange	1060120	1939	6 mm ² x 20	10
Orange	1060121	1940	10 mm ² x 2	100
Orange	1060122	1941	10 mm ² x 3	50
Orange	1060123	1942	10 mm ² x 4	50
Orange	1060124	1943	10 mm ² x 10	15
Orange	1060125	1944	10 mm ² x 20	10
Grey	1060206	-	2.5 mm ² x 2	100
Grey	1060207	-	2.5 mm ² x 3	100
Grey	1060208	-	2.5 mm ² x 4	75
Grey	1060209	-	2.5 mm ² x 10	30
Grey	1060210	-	2.5 mm ² x 20	20

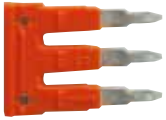

USED ONLY WITH MRK SERIES

USED ONLY WITH TRIPLE LEVEL MRK SERIES



Monolithic insulated body provides high durability to the conductor busbar



Due to the channels on the comb bridge, it gives the chance to be cut from the center of the pin gap. This feature is valid with 10 and 20 pin bridges



It can be easily disassembled with a screwdriver, by the help of the notch over the bridge

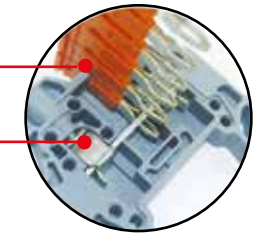

A secure connection with the bridle part

Continuous and safe contact from four points due to the diagonal structure of the pins

MRK SERIES METAL CROSS CONNECTIONS

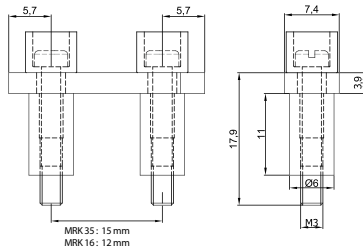

NEW CODE	OLD CODE	TYPE	PCS
1060152	2257	16 mm ² x 2	10
1060153	2258	16 mm ² x 3	10
1060154	2259	16 mm ² x 4	10
1060155	2260	16 mm ² x 5	10
1060156	2261	16 mm ² x 6	10
1060157	2262	16 mm ² x 7	10
1060158	2263	16 mm ² x 8	10
1060159	2264	16 mm ² x 9	10
1060160	2265	16 mm ² x 10	10
1060161	2266	35 mm ² x 2	10
1060162	2267	35 mm ² x 3	10
1060163	2268	35 mm ² x 4	10
1060164	2269	35 mm ² x 5	10
1060165	2270	35 mm ² x 6	10
1060166	2271	35 mm ² x 7	10
1060167	2272	35 mm ² x 8	10
1060168	2273	35 mm ² x 9	10
1060169	2274	35 mm ² x 10	10

MATERIAL	
Isolation	PA6.6
Body	Brass
Covering	Copper
Screw	Steel

MRK SERIES STUD TERMINAL BLOCKS FOR CABLE LUGS (WITH COVER)

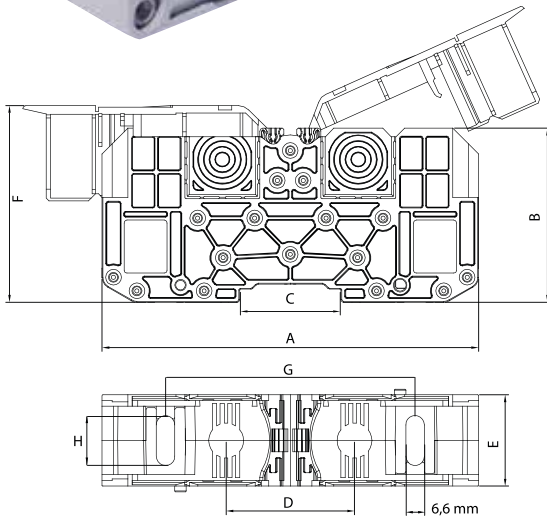

* U_{imp} : Impact strength voltage

MATERIAL

Body	PA6.6
Legs	PA6.6
Cover	PA6.6
Bolt	Steel
Nuts	Steel
Bridge	Copper

ACCESSORIES

	New Code	Old Code	See Page
Stopper	1060002	1202	Pg. 37-39
	1060005	1212	
	1060014	1222	
Group Sticker	1060024	1232	

MARKING

	New Code	Old Code	See Page
Dekafix	1060192	4440	Pg. 181 - 185
	1060194	4442	
	-	9540	
	-	9770	

CODE	DESCRIPTION	QTY / TABLET
2473	Ready Warning Signs, Triangle Edg. L 25 mm	132
2474	Neutral Signs, Triangle Edg. L 25 mm	132
2477	Earth Signs, Triangle Edg. L 25 mm	132
2478	Phase Signs, Triangle Edg. L 25 mm	132

		DESCRIPTIONS												
NEW CODE	OLD CODE	SECTION (mm ²)	VOLTAGE	CURRENT	BOLT	A (mm)	B (mm)	C (mm)	D (mm)	E (mm)	F (mm)	G (mm)	H (mm)	Box Carton
1030002	2302	25	1000 V	101 A	M6	107	50,8	35	40	27	58,5	76,5	16,3	10 / 140
1030017	2322	35	1000 V	125 A	M8	107	50,8	35	40	27	58,5	76,5	16,3	10 / 140
1030031	2342	50	1000 V	150 A	M8	107	50,8	35	40	27	58,5	76,5	16,3	10 / 140
1030045	2362	70	1000 V	192 A	M8	131,5	60,8	35	44,7	31,5	68,5	86,2	17,3	10 / 80
1030059	2382	95	1000 V	232 A	M8	131,5	60,8	35	44,7	31,5	68,5	86,2	17,3	10 / 80
1030073	2402	120	1000 V	269 A	M10	139,5	70	35	60	41,4	79	94,6	17,3	5 / 30
1030088	2422	150	1000 V	309 A	M12	139,5	70	35	60	41,4	79	94,6	17,3	5 / 30
1030102	2442	185	1000 V	353 A	M12	163,5	77,5	35	60	55	92	96	26,4	5 / 20
1030116	2462	240	1000 V	415 A	M12	163,5	77,5	35	60	55	92	96	26,4	5 / 20